

Recommended P.C.B Layout(Top Side)
(PCB BOARD TOLERANCE±0.05)

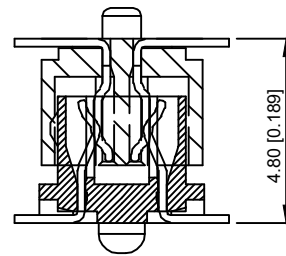
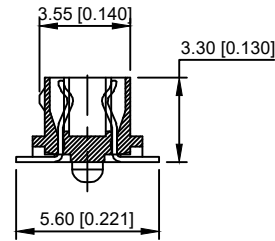

ASSEMBLY
SCALE 2:1

■ Specifications :

- Voltage rating: 50V AC / DC
- Current rating: 0.5A AC / DC
- Withstanding voltage: 200V AC/minute
- Temperature range: -40°C~+105°C
- Insulation resistance: ≥500MΩ
- Contact resistance: ≤50mΩ
- After environmental testing: ≤60mΩ
- Max.Processing Temp:230°C for 30-60 seconds
- (260°C for 10 seconds)

X1016 W F-XX X-XX XX XX
① ② ③ ④ ⑤ ⑥ ⑦ ⑧

- ① Series No.
- ② Category: W-wafer
- ③ Welding Board Angle: F-Female
- ④ Row No.-Pin No.: XX-09P~51P
- ⑤ Plug the Pin & Special No.:
- ⑥ Material: 46-PA46 94V-0 ; 6T-PA6T 94V-0 ;
- ⑦ Planting Category: SN-Bright tin plating ; V01-Gold Flash
- ⑧ Color: Blank-natural color

NO.OF Contacts	Dimensions				
	A	B	C	E	D
19pin	13.40	8.00	9.00	12.10	15.10
21pin	14.40	9.00	10.00	13.10	16.10
31pin	19.40	14.00	15.00	18.10	21.10
41pin	24.40	19.00	20.00	23.10	26.10
51pin	29.40	24.00	25.00	28.10	31.10

X1016WF-XX-46XX	Nylon 46 UL 94V-0	Phosphor Bronze	Tin-Plated or gold flash	Brass	Tin-Plated
X1016WF-XX-6TXX	Nylon 6T UL 94V-0				
PART NO	Material	Material(Pin)	Finish(Pin)	Material (Solder Tab)	Finish (Solder Tab)

DSND	DATE	SCALE: N/A	MODEL TYPE:
DWN	DATE	VIEW:	X1016WF-XX-XXXX
CHKD	DATE	UNIT: mm/in	PART NO.:
APPD	DATE	SIZE: A4	1.00 mm Crimp Style Connectors
			DWG NO.:
XKB INDUSTRIAL PRECISION CO.,LIMITED			WEIGHT
			1.0g
			SHEET
			1/1
			REVISION
			A0

ANGLAR	±5°
L ≤ 4	±0.2
4 < L ≤ 16	±0.3
16 < L ≤ 63	±0.4
L > 63	±0.5
UNSPECIFIED TOLERANCES	

MARK	DESCRIPTION	DATE	REVISED	APPROVED
Δx				
Δx				
Δx				
REVISIONS				
www.xk-dg.cn www.helloxkb.com www.helloxkb.cn				

X-ON Electronics

Largest Supplier of Electrical and Electronic Components

Click to view similar products for [Board to Board & Mezzanine Connectors](#) category:

Click to view products by [XKB](#) manufacturer:

Other Similar products are found below :

[589158040000018](#) [MDF7C-18P-2.54DSA\(55\)](#) [FCN-268F036-G/BD](#) [FCN-268M012-G/0D](#) [FCN-268M024-G/1D](#) [MIS-048-01-F-D-DP-K](#)
[832-10-034-10-001000](#) [FX4C-80S-1.27DSA](#) [93696-330](#) [224393](#) [FCN-235D050-G/C](#) [210-93-314-41-105000](#) [MDF7-40DP-2.54DSA\(55\)](#)
[55323-1519](#) [069159702701000](#) [101A10019X](#) [105061100000861+](#) [75140-7012](#) [87471-650](#) [1744382-4](#) [063209](#) [10124054-515LF](#) [68685-603](#)
[8-1616154-3](#) [541371078](#) [IL-WX-10PB-HF-B-E1000E](#) [FX23-40P-0.5SV15B](#) [FCN-214J100-G/0](#) [354184](#) [P50-028-DDS-TG](#) [53309-2471](#)
[54546-2071](#) [1586617-1](#) [504248-1210](#) [504248-2010](#) [1-1437355-2](#) [9159005551906](#) [NDS100-004-BF](#) [93696-730LF](#) [91922-31141LF](#) [505274-](#)
[3440](#) [501493-2410](#) [504208-3410](#) [505006-0811](#) [505274-2040](#) [202436-1600](#) [202477-0414](#) [71660-7580](#) [73420-5192](#) [360-10-107-00-001000](#)