

Without CAP

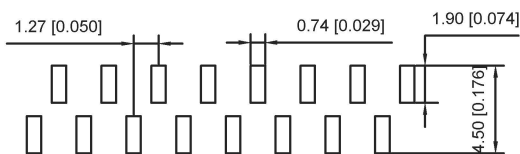

P.C.B LAYOUT(R2)

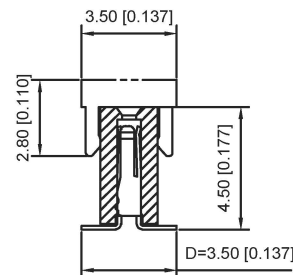
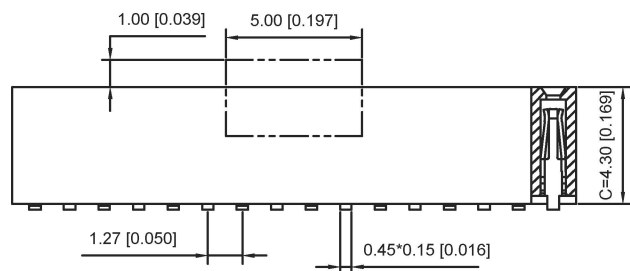
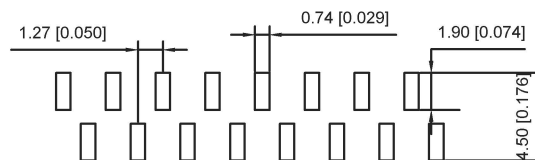

P.C.B LAYOUT(R1)

### Specifications:

- 1.Voltage rating:250VAC/DC
- 2.Current rating:1A AC/DC
- 3.Withstanding voltage:300V AC/minute
- 4.Temperature range:-40℃to+105℃
- 5.Insulation resistance:≥500MΩ Min
- 6.Contanct resistance:≤20MΩ Max
- 7.Material:PA6T 94V-0
- 8.Planting Category:1U"Gold
- 9.Reflow Soldering temperature:260±5℃, 10S

### X1311 F V S -XX-C43-D35-X

① ② ③ ④ ⑤ ⑥ ⑦ ⑧

- ① Series NO.
- ② Category:F-Female
- ③ Welding Board Angle:V-Right Angle 90°
- ④ Welding Way:S-SMT
- ⑤ Row No-Pin No:xx-01p-40p
- ⑥ Plastic height:C=4.3mm
- ⑦ Plastic height:D=3.5mm
- ⑧ X:R1,R2

X1311FVS-XX-C43-D35-X	PA6T 94V-0	Brass	1U" Gold	X1311W
PART NO	Material	Material(Terminal)	Finish(Terminal)	Suitable XKB Terminal

广东星坤科技股份有限公司

生效

ΔX	日期
ΔX	日期
MARK	DESCRIPTION

文件工程章

REVISIONS

www.xk-dg.cn www.helloxkb.com www.helloxkb.cn

ANGLAR	±5°
L ≤ 4	±0.2
4 < L ≤ 16	±0.3
16 < L ≤ 63	±0.4
L > 63	±0.5

UNSPECIFIED TOLERANCES

DSND	DATE	SCALE: N/A	MODEL TYPE:
DWN	DATE	VIEW:	X1311FVS-XX-C43-D35-X
CHKD	DATE	UNIT: mm/in	PART NO.:
APPD	DATE	SIZE: A4	DWG NO.:
XKB INDUSTRIAL PRECISION CO., LIMITED			X1311FVS-XX-C43-D35-X
WEIGHT	SHEET	REVISION	
1.0g	1/1	A0	

## X-ON Electronics

Largest Supplier of Electrical and Electronic Components

*Click to view similar products for [Headers & Wire Housings](#) category:*

*Click to view products by [XKB](#) manufacturer:*

Other Similar products are found below :

[57102-F02-18ULF](#) [58102-G61-06LF](#) [0009485154](#) [009176003701906](#) [0050291907](#) [02.125.8002.8](#) [609-3404](#) [61062-3](#) [622-0430](#) [622-3653LF](#)  
[63453-116](#) [636-1030](#) [636-1427](#) [636-3427](#) [636-4007](#) [641938-9](#) [644827-2](#) [65495-038](#) [65692-001LF](#) [65781-018](#) [65781-047](#) [65817-010LF](#)  
[65817-015LF](#) [66207-023LF](#) [67016-026LF](#) [67095-007LF](#) [68631-112](#) [68645-018](#) [68648-049](#) [699319-000](#) [70.362.1628.0](#) [70-4210](#) [70-4226B](#)  
[70-4853B](#) [707-5020](#) [707-5028](#) [71.350.2428.0](#) [71961-016LF](#) [733-134](#) [754199-000](#) [760-3052](#) [787-8014-00](#) [FCN-367T-T012/H](#) [80.063.4001.1](#)  
[800-90-001-10-001000](#) [800-90-010-10-002000](#) [801-43-002-10-013000](#) [801-43-006-10-002000](#) [803-41-018-10-001000](#) [803-43-014-20-](#)  
[001000](#)