

Without CAP

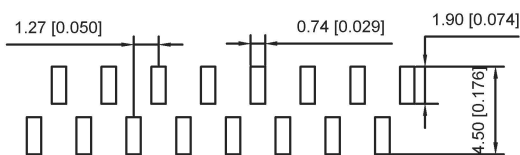

P.C.B LAYOUT(R2)

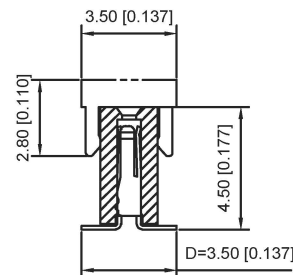
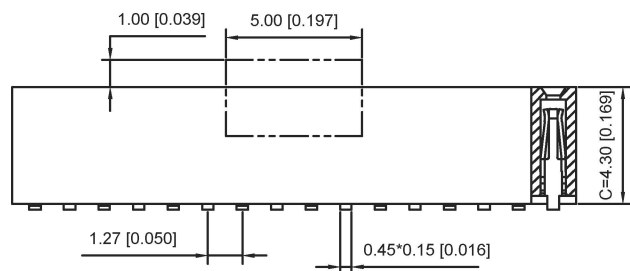
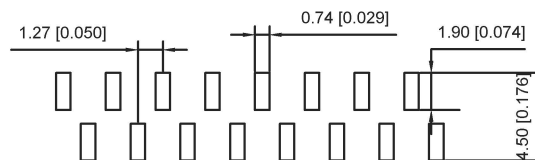

P.C.B LAYOUT(R1)

### Specifications:

- 1.Voltage rating:250VAC/DC
- 2.Current rating:1A AC/DC
- 3.Withstanding voltage:300V AC/minute
- 4.Temperature range:-40℃to+105℃
- 5.Insulation resistance:≥500MΩ Min
- 6.Contanct resistance:≤20MΩ Max
- 7.Material:PA6T 94V-0
- 8.Planting Category:1U"Gold
- 9.Reflow Soldering temperature:260±5℃, 10S

### X1311 F V S -XX-C43-D35-X

① ② ③ ④ ⑤ ⑥ ⑦ ⑧

- ① Series NO.
- ② Category:F-Female
- ③ Welding Board Angle:V-Right Angle 90°
- ④ Welding Way:S-SMT
- ⑤ Row No-Pin No:xx-01p-40p
- ⑥ Plastic height:C=4.3mm
- ⑦ Plastic height:D=3.5mm
- ⑧ X:R1,R2

X1311FVS-XX-C43-D35-X	PA6T 94V-0	Brass	1U" Gold	X1311W
PART NO	Material	Material(Terminal)	Finish(Terminal)	Suitable XKB Terminal

广东星坤科技股份有限公司

生效

ΔX	日期
ΔX	日期
ΔX	日期
MARK	DESCRIPTION

REVISIONS

www.xk-dg.cn www.helloxkb.com www.helloxkb.cn

文件工程章

DSND	DATE	SCALE: N/A	MODEL TYPE:
DWN	DATE	VIEW:	X1311FVS-XX-C43-D35-X
CHKD	DATE	UNIT: mm/in	PART NO.:
APPD	DATE	SIZE: A4	DWG NO.:
UNSPECIFIED TOLERANCES			X1311FVS-XX-C43-D35-X
XKB INDUSTRIAL PRECISION CO., LIMITED			WEIGHT
			1.0g
			SHEET
			1/1
			REVISION
			A0

## X-ON Electronics

Largest Supplier of Electrical and Electronic Components

*Click to view similar products for [Headers & Wire Housings](#) category:*

*Click to view products by [XKB](#) manufacturer:*

Other Similar products are found below :

[0015917161](#) [0022155065](#) [57102-F02-18ULF](#) [58102-G61-06LF](#) [582553-1](#) [01.001.5753.1](#) [0050291907](#) [02.125.8002.8](#) [609-3404](#) [61062-3](#)  
[CSU011177004](#) [622-0430](#) [622-3653LF](#) [63453-116](#) [636-1030](#) [636-1427](#) [636-3427](#) [636-4007](#) [641938-9](#) [65495-038](#) [65692-001LF](#) [65781-018](#)  
[65781-047](#) [65817-010LF](#) [65817-015LF](#) [67095-007LF](#) [67601157](#) [68631-112](#) [68645-018](#) [699319-000](#) [70.362.1628.0](#) [70-4210](#) [70-4226B](#) [70-](#)  
[4853B](#) [71.350.2428.0](#) [733-134](#) [733-162](#) [760-3052](#) [MHR-64-VUAL](#) [80.063.4001.1](#) [800-90-001-10-001000](#) [801-43-002-10-013000](#)  
[801-43-006-10-002000](#) [803-43-024-10-001000](#) [803-93-012-10-001000](#) [8-1437020-4](#) [819-22-004-30-001101](#) [820-22-006-30-001101](#)  
[820-22-008-30-001101](#) [821-22-002-10-001101](#)