

Without CAP

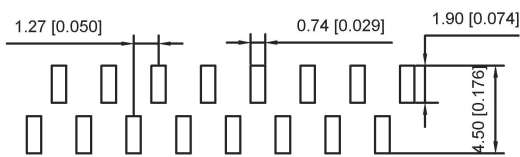

P.C.B LAYOUT(R2)

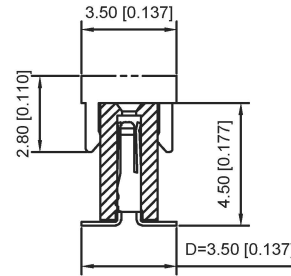
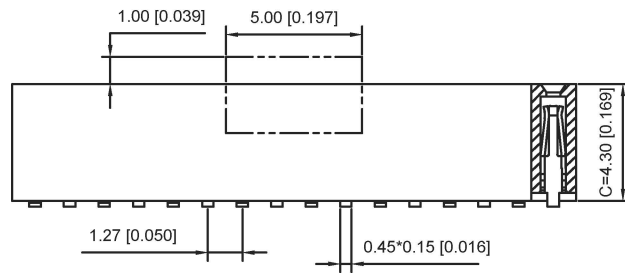
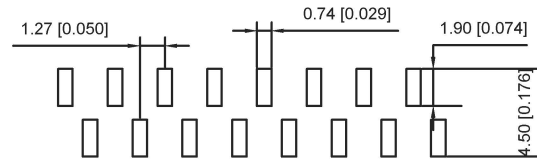

P.C.B LAYOUT(R1)

Specifications:

- 1.Voltage rating:250VAC/DC
- 2.Current rating:1A AC/DC
- 3.Withstanding voltage:300V AC/minute
- 4.Temperature range:-40℃to+105℃
- 5.Insulation resistance:≥500MΩ Min
- 6.Contanct resistance:≤20MΩ Max
- 7.Material:PA6T 94V-0
- 8.Planting Category:1U"Gold
- 9.Reflow Soldering temperature:260±5℃, 10S

X1311 F V S -XX-C43-D35-X

- ① ② ③ ④ ⑤ ⑥ ⑦ ⑧

- ① Series NO.
- ② Category:F-Female
- ③ Welding Board Angle:V-Right Angle 90°
- ④ Welding Way:S-SMT
- ⑤ Row No-Pin No:xx-01p-40p
- ⑥ Plastic height:C=4.3mm
- ⑦ Plastic height:D=3.5mm
- ⑧ X:R1,R2

| | | | | |
|-----------------------|------------|--------------------|------------------|-----------------------|
| X1311FVS-XX-C43-D35-X | PA6T 94V-0 | Brass | 1U" Gold | X1311W |
| PART NO | Material | Material(Terminal) | Finish(Terminal) | Suitable XKB Terminal |

广东星坤科技股份有限公司

生效

| | |
|------|-------------|
| ΔX | 日期 |
| ΔX | 日期 |
| ΔX | 日期 |
| MARK | DESCRIPTION |

REVISIONS

UNSPECIFIED TOLERANCES

| | | | |
|---------------------------------------|-------|-------------|-----------------------|
| DSND | DATE | SCALE: N/A | MODEL TYPE: |
| DWN | DATE | VIEW: | X1311FVS-XX-C43-D35-X |
| CHKD | DATE | UNIT: mm/in | PART NO.: |
| APPD | DATE | SIZE: A4 | DWG NO.: |
| XKB INDUSTRIAL PRECISION CO., LIMITED | | | X1311FVS-XX-C43-D35-X |
| WEIGHT | SHEET | REVISION | |
| 1.0g | 1/1 | A0 | |

文件工程章

www.xk-dg.cn www.helloxkb.com www.helloxkb.cn

X-ON Electronics

Largest Supplier of Electrical and Electronic Components

Click to view similar products for [Headers & Wire Housings](#) category:

Click to view products by [XKB](#) manufacturer:

Other Similar products are found below :

[0015917161](#) [0022155065](#) [57102-F02-18ULF](#) [58102-G61-06LF](#) [582553-1](#) [01.001.5753.1](#) [0050291907](#) [02.125.8002.8](#) [609-3404](#) [61062-3](#)
[CSU011177004](#) [622-0430](#) [622-3653LF](#) [63453-116](#) [636-1030](#) [636-1427](#) [636-3427](#) [636-4007](#) [641938-9](#) [65495-038](#) [65692-001LF](#) [65781-018](#)
[65781-047](#) [65817-010LF](#) [65817-015LF](#) [67095-007LF](#) [67601157](#) [68631-112](#) [68645-018](#) [699319-000](#) [70.362.1628.0](#) [70-4210](#) [70-4226B](#) [70-](#)
[4853B](#) [71.350.2428.0](#) [733-134](#) [733-162](#) [760-3052](#) [MHR-64-VUAL](#) [80.063.4001.1](#) [800-90-001-10-001000](#) [801-43-002-10-013000](#)
[801-43-006-10-002000](#) [803-43-024-10-001000](#) [803-93-012-10-001000](#) [8-1437020-4](#) [819-22-004-30-001101](#) [820-22-006-30-001101](#)
[820-22-008-30-001101](#) [821-22-002-10-001101](#)