

Specifications:

- Voltage rating: 250V AC/DC
- Current rating: 2.5-1.0A AC/DC
- Withstanding voltage: 800V AC/minute
- Temperature range: -25 °C ~ +85 °C
- Insulation resistance: ≥1000MΩ
- Contact resistance: ≤10mΩ
- After environmental testing: ≤20mΩ

X2006 W R - 2*XX -4T SN
 ① ② ③ ④ ⑤ ⑥

- ① XKB Series No.
- ② Category: W-WAFER
- ③ Welding Board Angle: R-90°
- ④ Row No. - pin No.: 2*XX-04P~20P
- ⑤ Material: 4T-PA4T 94V-0
- ⑥ Plating Category : SN-Bright Tin Plating

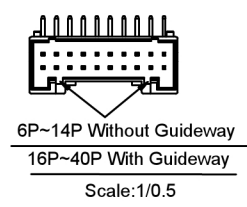
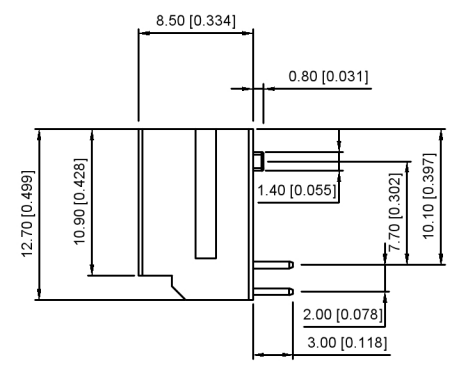
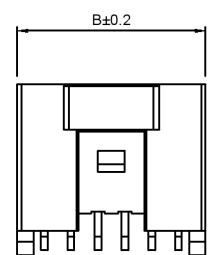

Poles	Dimensions(mm)		Poles	Dimensions(mm)	
	A	B		A	B
2*04	6.00	10.00	2*13	24.00	28.00
2*05	8.00	12.00	2*14	26.00	30.00
2*06	10.00	14.00	2*15	28.00	34.00
2*07	12.00	16.00	2*16	30.00	36.00
2*08	14.00	18.00	2*17	32.00	38.00
2*09	16.00	20.00	2*18	34.00	40.00
2*10	18.00	22.00	2*19	36.00	42.00
2*11	20.00	24.00	2*20	38.00	44.00
2*12	22.00	26.00			

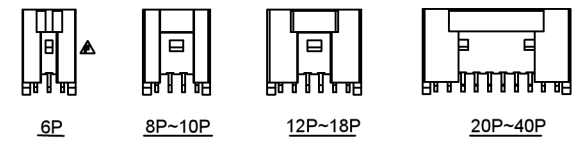
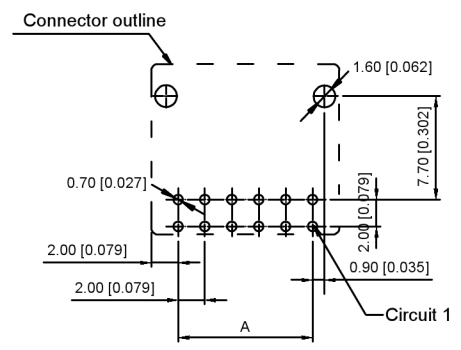

Recommended P.C.CB Layout
 General Tolerance ±0.05

X2006WR-2*XX-4TSN	PA4T UL 94V-0	X2006T	X2006H
PART NO	Material	Suitable XKB Terminal	Suitable XKB Terminal

广东星坤科技股份有限公司

ΔX		日期
ΔX		日期
ΔX		日期
ΔX		日期

文件工程章

				XKB	ANGLAR	±5°
					L ≤ 4	±0.2
					4 < L ≤ 16	±0.3
					16 < L ≤ 63	±0.4
					L > 63	±0.5
					UNSPECIFIED TOLERANCES	

DSND		DATE		SCALE: N/A	MODEL TYPE: X2006WR-2*XX-4TSN		
DWN		DATE		VIEW:	PART NO.:		
CHKD		DATE		UNIT: mm/in	DWG NO.:		
APPD		DATE		SIZE: A4			
KKB INDUSTRIAL PRECISION CO., LIMITED					WEIGHT	SHEET	REVISION
						1/1	A0

REVISIONS
 www.hellokxb.com

X-ON Electronics

Largest Supplier of Electrical and Electronic Components

Click to view similar products for [Headers & Wire Housings](#) category:

Click to view products by [XKB](#) manufacturer:

Other Similar products are found below :

[57102-F02-18ULF](#) [58102-G61-06LF](#) [582553-1](#) [009176003701906](#) [01.001.5753.1](#) [0050291907](#) [02.125.8002.8](#) [609-3404](#) [61062-3](#)
[CSU011177004](#) [622-0430](#) [622-3653LF](#) [63453-116](#) [636-1030](#) [636-1427](#) [636-3427](#) [636-4007](#) [641938-9](#) [644827-2](#) [65495-038](#) [65692-001LF](#)
[65781-018](#) [65781-047](#) [65817-010LF](#) [65817-015LF](#) [66207-023LF](#) [67095-007LF](#) [67601157](#) [68631-112](#) [68645-018](#) [699319-000](#)
[M90C108951C](#) [70.362.1628.0](#) [70-4210](#) [70-4226B](#) [70-4853B](#) [707-5028](#) [71.350.2428.0](#) [71961-016LF](#) [733-134](#) [733-162](#) [754199-000](#) [760-](#)
[3052](#) [80.063.4001.1](#) [800-90-001-10-001000](#) [800-90-010-10-002000](#) [801-43-002-10-013000](#) [801-43-006-10-002000](#) [803-41-018-10-001000](#)
[803-43-024-10-001000](#)