

For and on behalf of  
**KXB INDUSTRIAL PRECISION CO., LIMITED**  
 香港星坤工業精密有限公司

MARK	DESCRIPTION	REVISIONS			UNSPECIFIED TOLERANCES	
		DATE	REVISED	APPROVED	L > 63	± 0.5
△ X					16 > L ≤ 63	± 0.4
△ X					4 < L ≤ 16	± 0.3
△ X					L ≤ 4	± 0.2
					ANGULAR	± 5°

**KXB INDUSTRIAL PRECISION CO., LIMITED**

WEIGHT	1.0g	REVISION	A0
SHEET	1/1		
SIZE:	A4	DATE	
UNIT:	mm	DATE	
VIEW:		DATE	
SCALE:	N/A	DATE	
MODEL TYPE:	X2009WRS-XX-9TSW	DWNG NO.:	
PART NO.:		2.00mm Crimp Style Connectors	
APPD			
CHKD			
DWN			
DSND			

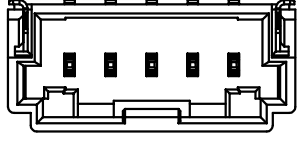

5P

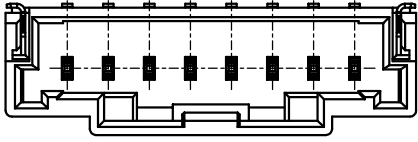

8P

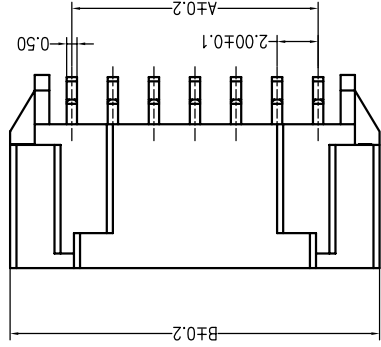
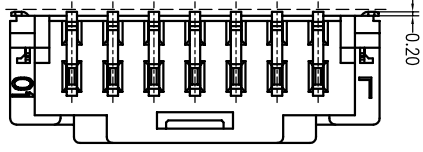

0.1

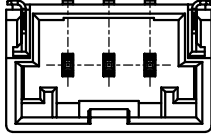

3P

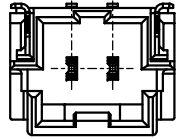

2P

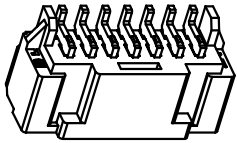
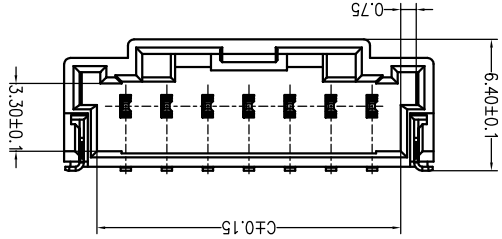
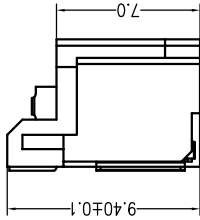

PCB LAYOUT

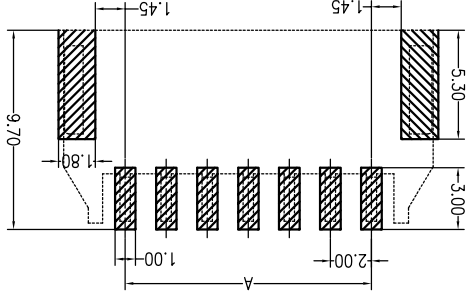

PART NO	Material	PA9T UL 94V-0	Brass	Tin-Plated	Brass	Tin-Plated	Material (Solder Tabs)	Finish (Pfn)	Material (Solder Tabs)	Finish (Pfn)	Material (Solder Tabs)	Suitable XKB Terminal	Dimensions (mm)		
													A	B	C
08	14.00	20.00	16.80	15	28.00	34.00	30.80								
07	12.00	18.00	14.80	14	26.00	32.00	28.80								
06	10.00	16.00	12.80	13	24.00	30.00	26.80								
05	8.00	14.00	10.80	12	22.00	28.00	24.80								
04	6.00	12.00	8.80	11	20.00	26.00	22.80								
03	4.00	10.00	6.80	10	18.00	24.00	20.80								
02	2.00	8.00	4.80	09	16.00	22.00	18.80								

- ① Series No.
- ② Category: W-WAFER
- ③ Welding Board Angle: R-Right Angle 90°
- ④ Welding Way: S-SMT
- ⑤ Row No.-Pin No.: XX-02P~15P
- ⑥ Material: 9T -PA9T 94V-0
- ⑦ Plating Category: SW-Fog Tin plating

X2009 W R S-XX 9T SW

- Specifications :
- Voltage rating: 125 V AC / DC
  - Current rating: 3 A AC / DC
  - Withstanding voltage: 500 V AC/minute
  - Temperature range: -45 ~ +105
  - Insulation resistance: ≥1000MΩ
  - Contact resistance: ≤10mΩ
  - After environmental testing: ≤20mΩ

## X-ON Electronics

Largest Supplier of Electrical and Electronic Components

*Click to view similar products for [Headers & Wire Housings](#) category:*

*Click to view products by [XKB](#) manufacturer:*

Other Similar products are found below :

[95000-104TRLF](#) [10135584-644402LF](#) [DF62W-EP2022PCA](#) [95000-106TRLF](#) [DF62W-2022SCA](#) [DF62W-EP2022PC](#) [2203348](#) [DF62W-2022SC](#) [1084018](#) [1029039](#) [1084017](#) [802-10-012-10-002000](#) [1112640](#) [1112639](#) [891-007-9SS-BST1T](#) [000-34000](#) [0008550134](#) [0009482033](#) [0009507031](#) [57102-F02-18ULF](#) [57102-S06-03LF](#) [57202-S52-04LF](#) [PCN6-15S-2.5E](#) [0039019024](#) [58102-G61-06LF](#) [582553-1](#) [0009485154](#) [0009508121](#) [0022285053](#) [0050291907](#) [018731A](#) [LY20-4P-DT1-P1E-BR](#) [02.125.8002.8](#) [60101931](#) [60598-1 \(Cut Strip\)](#) [M1625-3R/100](#) [61062-3](#) [61082-181009](#) [CSU011177004](#) [636-1427](#) [638009-1](#) [641938-9](#) [641991-4](#) [644168-1](#) [644827-2](#) [647662-1](#) [65039-019ELF](#) [65692-001LF](#) [65781-018](#) [65781-047](#)