

## ■ Specifications :

- Voltage rating: 100V AC / DC
- Current rating: 3A AC / DC
- Withstanding voltage: 800V AC/minute
- Temperature range: -25°C~+85°C
- Insulation resistance: ≥1000M Ω
- Contact resistance: ≤10mΩ
- After environmental testing : ≤20mΩ

X2016 W V-XXH2- 46 SN  
 ① ② ③ ④ ⑤ ⑥ ⑦

- ① Series No.
- ② Category : W-WAFER
- ③ Wedding Board Angle : V-Stright 180°
- ④ Row No.-Pin No.: XX-02P~20P
- ⑤ H2:Horse Hooves
- ⑥ Material : 46-PA46 94V-0
- ⑦ Plating Category: Sn-Bright Tin Plating;

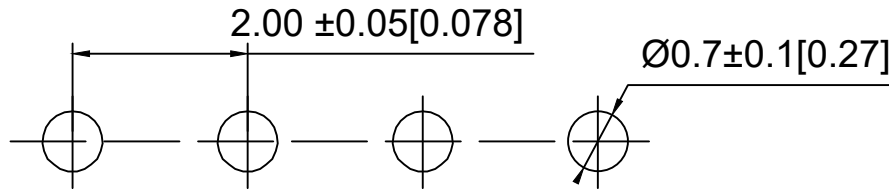

P.C.B LAYOUT

Poles	Dimensions(mm)			Poles	Dimensions(mm)		
	A	B	C		A	B	C
02	2.00	6.00	5.00	12	22.00	26.00	25.00
03	4.00	8.00	7.00	13	24.00	28.00	27.00
04	6.00	10.00	9.00	14	26.00	30.00	29.00
05	8.00	12.00	11.00	15	28.00	32.00	31.00
06	10.00	14.00	13.00	16	30.00	34.00	33.00
07	12.00	16.00	15.00				
08	14.00	18.00	17.00				
09	16.00	20.00	19.00				
10	18.00	22.00	21.00				
11	20.00	24.00	23.00				

X2016WV-XXH2-46SN	PA46 UL 94V-0	Brass	Tin-Plated	X2016H
PART NO	Material	Material(pin)	Finish(pin)	Suitable XKB Terminal

DSND	SCALE: N/A	MODEL TYPE: 2.0mm Crimp Style Connectors		
DWN	VIEW:	PART NO.: X2016WV-XXH2-46SN		
CHKD	UNIT: mm/in	DWG NO.: X-X2016WV-XXH2-46SN		
APPD	SIZE: A4	WEIGHT	SHEET	REVISION
XKB INDUSTRIAL PRECISION CO.,LIMITED			1/1	A0



ANGLAR	±5°
L ≤ 4	±0.2
4 < L ≤ 16	±0.3
16 < L ≤ 63	±0.4
L > 63	±0.5
UNSPECIFIED TOLERANCES	

MARK	DESCRIPTION	DATE	REVISED	APPROVED
ΔX				
ΔX				
ΔX				
REVISIONS				
www.helloxkb.com www.helloxkb.cn www.xk-dg.cn				

## X-ON Electronics

Largest Supplier of Electrical and Electronic Components

*Click to view similar products for [Headers & Wire Housings](#) category:*

*Click to view products by [XKB](#) manufacturer:*

Other Similar products are found below :

[57102-F02-18ULF](#) [58102-G61-06LF](#) [0009485154](#) [009176003701906](#) [0050291907](#) [00-9021-0611-00-339](#) [02.125.8002.8](#) [609-3404](#) [61062-3](#)  
[622-0430](#) [622-3653LF](#) [63453-116](#) [636-1030](#) [636-1427](#) [636-3427](#) [636-4007](#) [641938-9](#) [644827-2](#) [65495-038](#) [65692-001LF](#) [65781-018](#)  
[65781-047](#) [65817-010LF](#) [65817-015LF](#) [66207-023LF](#) [67016-026LF](#) [67095-007LF](#) [68631-112](#) [68645-018](#) [68648-049](#) [699319-000](#)  
[70.362.1628.0](#) [70-4210](#) [70-4226B](#) [70-4853B](#) [707-5020](#) [707-5028](#) [71.350.2428.0](#) [71961-016LF](#) [733-134](#) [754199-000](#) [760-3052](#) [787-8014-00](#)  
[FCN-367T-T012/H](#) [80.063.4001.1](#) [800-90-001-10-001000](#) [800-90-010-10-002000](#) [801-43-002-10-013000](#) [801-43-006-10-002000](#)  
[803-41-018-10-001000](#)