

■ Specifications :

- Voltage rating: 100V AC / DC
- Current rating: 3A AC / DC
- Withstanding voltage: 800V AC/minute
- Temperature range: -25°C~+85°C
- Insulation resistance: ≥1000M Ω
- Contact resistance: ≤10mΩ
- After environmental testing : ≤20mΩ

X2016 W V-XXH2- 46 SN
 ① ② ③ ④ ⑤ ⑥ ⑦

- ① Series No.
- ② Category : W-WAFER
- ③ Wedding Board Angle : V-Stright 180°
- ④ Row No.-Pin No.: XX-02P~20P
- ⑤ H2:Horse Hooves
- ⑥ Material : 46-PA46 94V-0
- ⑦ Plating Category: Sn-Bright Tin Plating;

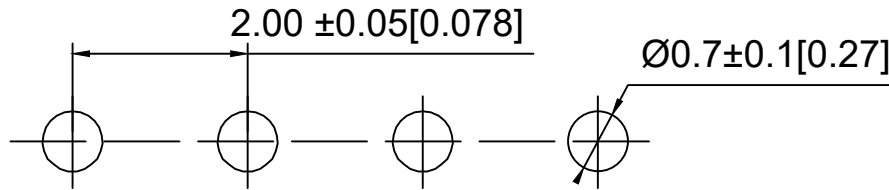

P.C.B LAYOUT

| Poles | Dimensions(mm) | | | Poles | Dimensions(mm) | | |
|-------|----------------|-------|-------|-------|----------------|-------|-------|
| | A | B | C | | A | B | C |
| 02 | 2.00 | 6.00 | 5.00 | 12 | 22.00 | 26.00 | 25.00 |
| 03 | 4.00 | 8.00 | 7.00 | 13 | 24.00 | 28.00 | 27.00 |
| 04 | 6.00 | 10.00 | 9.00 | 14 | 26.00 | 30.00 | 29.00 |
| 05 | 8.00 | 12.00 | 11.00 | 15 | 28.00 | 32.00 | 31.00 |
| 06 | 10.00 | 14.00 | 13.00 | 16 | 30.00 | 34.00 | 33.00 |
| 07 | 12.00 | 16.00 | 15.00 | | | | |
| 08 | 14.00 | 18.00 | 17.00 | | | | |
| 09 | 16.00 | 20.00 | 19.00 | | | | |
| 10 | 18.00 | 22.00 | 21.00 | | | | |
| 11 | 20.00 | 24.00 | 23.00 | | | | |

| | | | | |
|-------------------|---------------|---------------|-------------|-----------------------|
| X2016WV-XXH2-46SN | PA46 UL 94V-0 | Brass | Tin-Plated | X2016H |
| PART NO | Material | Material(pin) | Finish(pin) | Suitable XKB Terminal |

| | | | | |
|--------------------------------------|-------------|---|-------|----------|
| DSND | SCALE: N/A | MODEL TYPE: 2.0mm Crimp Style Connectors | | |
| DWN | VIEW: | PART NO.: X2016WV-XXH2-46SN | | |
| CHKD | UNIT: mm/in | DWG NO.: X-X2016WV-XXH2-46SN | | |
| APPD | SIZE: A4 | WEIGHT | SHEET | REVISION |
| XKB INDUSTRIAL PRECISION CO.,LIMITED | | | 1/1 | A0 |



| | |
|------------------------|------|
| ANGLAR | ±5° |
| L ≤ 4 | ±0.2 |
| 4 < L ≤ 16 | ±0.3 |
| 16 < L ≤ 63 | ±0.4 |
| L > 63 | ±0.5 |
| UNSPECIFIED TOLERANCES | |

| | | | | | | |
|---|-------------|------|---------|----------|--|--|
| ΔX | | | | | | |
| ΔX | | | | | | |
| ΔX | | | | | | |
| MARK | DESCRIPTION | DATE | REVISED | APPROVED | | |
| REVISIONS | | | | | | |
| www.helloxkb.com www.helloxkb.cn www.xk-dg.cn | | | | | | |

X-ON Electronics

Largest Supplier of Electrical and Electronic Components

Click to view similar products for [Headers & Wire Housings](#) category:

Click to view products by [XKB](#) manufacturer:

Other Similar products are found below :

[57102-F02-18ULF](#) [58102-G61-06LF](#) [0009485154](#) [009176003701906](#) [0050291907](#) [00-9021-0611-00-339](#) [02.125.8002.8](#) [609-3404](#) [61062-3](#)
[622-0430](#) [622-3653LF](#) [63453-116](#) [636-1030](#) [636-1427](#) [636-3427](#) [636-4007](#) [641938-9](#) [644827-2](#) [65495-038](#) [65692-001LF](#) [65781-018](#)
[65781-047](#) [65817-010LF](#) [65817-015LF](#) [66207-023LF](#) [67016-026LF](#) [67095-007LF](#) [68631-112](#) [68645-018](#) [68648-049](#) [699319-000](#)
[70.362.1628.0](#) [70-4210](#) [70-4226B](#) [70-4853B](#) [707-5020](#) [707-5028](#) [71.350.2428.0](#) [71961-016LF](#) [733-134](#) [754199-000](#) [760-3052](#) [787-8014-00](#)
[FCN-367T-T012/H](#) [80.063.4001.1](#) [800-90-001-10-001000](#) [800-90-010-10-002000](#) [801-43-002-10-013000](#) [801-43-006-10-002000](#)
[803-41-018-10-001000](#)