

Specifications:

- Voltage rating:250V AC/DC
- Current rating:3A AC/DC
- Withstanding voltage:1000V AC/minute
- Temperature range:-25 °C~+85°C
- Insulation resistance:≥1000MΩ
- Contact resistance:≤20mΩ
- After environmental testing:≤20mΩ
- Male contact Retention force:≥20N

X2509 W V - XXS -N0 SN
① ② ③ ④ ⑤ ⑥ ⑦

- ① XKB Series No.
- ② Category:W-WAFER
- ③ Welding Board Angle:R-90°
- ④ Row No.-pin No.:2*XX-04P~20P
- ⑤ S:With positioning column
- ⑥ Material:NO-PA66 94V-0
- ⑦ Plating Category :SN-Bright Tin Plating

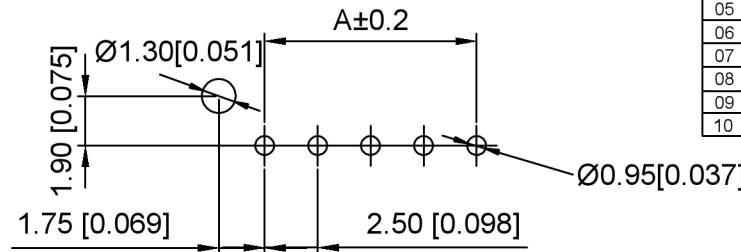
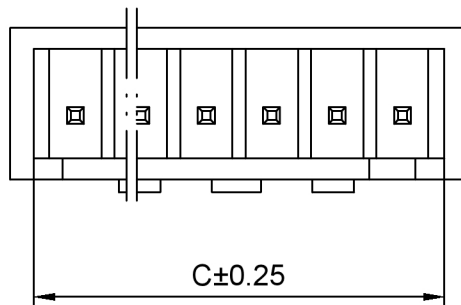
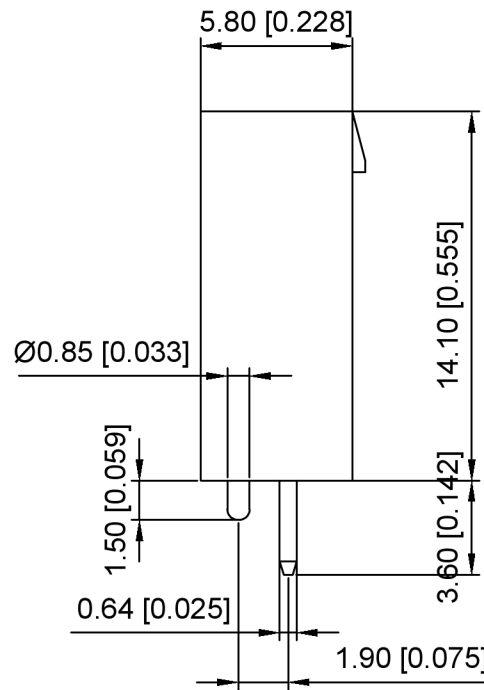
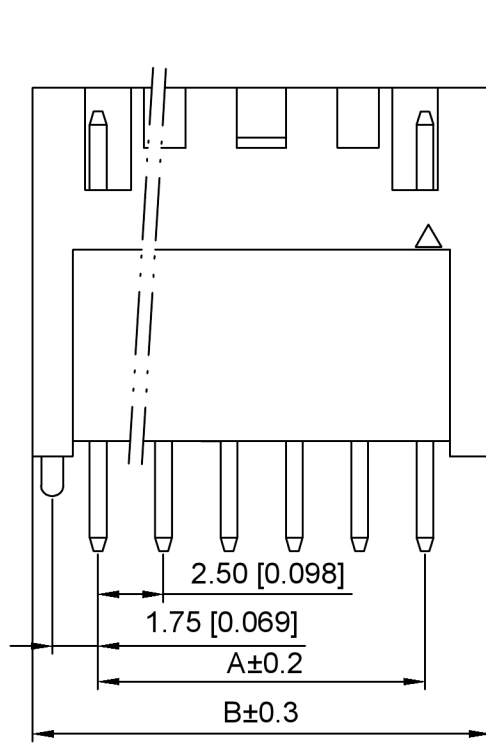

P.C.B LAYOUT

Poles	Dimensions(mm)			Poles	Dimensions(mm)		
	A	B	C		A	B	C
02	2.50	7.50	5.70	11	25.00	30.00	28.20
03	5.00	10.00	8.20	12	27.50	32.50	30.70
04	7.50	12.50	10.70	13	30.00	35.00	33.20
05	10.00	15.00	13.20	14	32.50	37.50	35.70
06	12.50	17.50	15.70	15	35.00	40.00	38.20
07	15.00	20.00	18.20				
08	17.50	22.50	20.70				
09	20.00	25.00	23.20				
10	22.50	27.50	25.70				

X2509WV-XXS-N0SN	PA66 UL 94V-0	X2509T	X2509H
PART NO	Material	Suitable XKB Terminal	Suitable XKB Terminal

DSND	DATE	SCALE: N/A	MODEL TYPE: X2509WV-XXS-N0SN
DWN	DATE	VIEW:	PART NO.:
CHKD	DATE	UNIT: mm/in	DWG NO.:
APPD	DATE	SIZE: A4	
XKB INDUSTRIAL PRECISION CO.,LIMITED			WEIGHT
			SHEET
			REVISION
			1/1
			A0

广东星坤科技股份有限公司

文件工程章

日期

REVISIONS	DATE	REVISED	APPROVED	UNSPECIFIED TOLERANCES
			XKB	ANGLAR ±5°
				L≤4 ±0.2
				4<L≤16 ±0.3
				16<L≤63 ±0.4
				L>63 ±0.5

X-ON Electronics

Largest Supplier of Electrical and Electronic Components

Click to view similar products for [Headers & Wire Housings](#) category:

Click to view products by [XKB](#) manufacturer:

Other Similar products are found below :

[57102-F02-18ULF](#) [58102-G61-06LF](#) [582553-1](#) [009176003701906](#) [01.001.5753.1](#) [0050291907](#) [02.125.8002.8](#) [609-3404](#) [61062-3](#)
[CSU011177004](#) [622-0430](#) [622-3653LF](#) [63453-116](#) [636-1030](#) [636-1427](#) [636-3427](#) [636-4007](#) [641938-9](#) [644827-2](#) [65495-038](#) [65692-001LF](#)
[65781-018](#) [65781-047](#) [65817-010LF](#) [65817-015LF](#) [66207-023LF](#) [67095-007LF](#) [67601157](#) [68631-112](#) [68645-018](#) [699319-000](#)
[M90C108951C](#) [70.362.1628.0](#) [70-4210](#) [70-4226B](#) [70-4853B](#) [707-5028](#) [71.350.2428.0](#) [71961-016LF](#) [733-134](#) [733-162](#) [754199-000](#) [760-](#)
[3052](#) [80.063.4001.1](#) [800-90-001-10-001000](#) [800-90-010-10-002000](#) [801-43-002-10-013000](#) [801-43-006-10-002000](#) [803-41-018-10-001000](#)
[803-43-024-10-001000](#)