

Poles	Applicable panel thickness mm					
	0.5-0.9	1.0-1.5	1.5-2.0	C	D	D
02	5.7	9.6	5.7	9.8	5.7	10.0
03	8.2	12.1	8.2	12.3	8.2	12.5
04	10.7	14.6	10.7	14.8	10.7	15.0
05	13.2	17.1	13.2	17.3	13.2	17.5
06	15.7	19.6	15.7	19.8	15.7	20.0
07	18.2	22.1	18.2	22.3	18.2	22.5
08	20.7	24.6	20.7	24.8	20.7	25.0
09	23.2	27.1	23.2	27.3	23.2	27.5
10	25.7	29.6	25.7	29.8	25.7	30.0
11	28.2	32.1	28.2	32.3	28.2	32.5
12	30.7	34.6	30.7	34.8	30.7	35.0

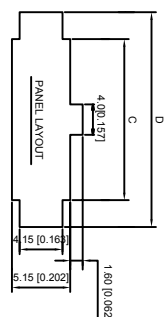
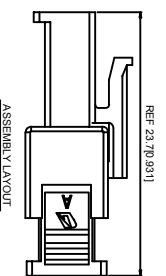
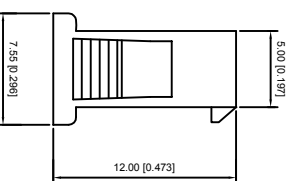
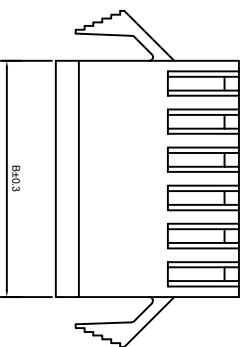

Poles	Dimensions(mm)		Poles	Dimensions(mm)	
	A	B		A	B
02	2.50	5.50	08	17.50	20.50
03	5.00	8.00	09	20.00	23.00
04	7.50	10.50	10	22.50	25.50
05	10.00	13.00	11	25.00	28.00
06	12.50	15.50	12	27.50	30.50
07	15.00	18.00			

X2521HM-XXG-N0	Black	PA66 UL 94V-0	Brass	Tin-Plated	X2521HF-G
PART NO	Color	Material	Material(Pin)	Finish(Pin)	Suitable XKB Terminal

- Specifications:**
- Voltage rating: 250V AC/DC
  - Current rating : 3A AC/DC
  - Withstanding voltage: 1500V AC/minute
  - Temperature range: -40 °C ~ +105 °C
  - Insulation resistance: ≥500MΩ
  - Contact resistance: ≤10mΩ
  - After environmental testing: ≤20mΩ

X2521 H M- XX G-N0  
 ① ② ③ ④ ⑤ ⑥

- ① Series No.
- ② Category: H-HSG
- ③ Welding Board Angle: M-male HSG
- ④ Row No. -pin No.: XX-02P~12P
- ⑤ Plug the pin & Special No.: Mating X2521HF-G
- ⑥ Material: N0-PA66 94V-0

ΔX	ΔX	ΔX	MARK	DESCRIPTION	DATE	REVISED	APPROVED	UNSPECIFIED TOLERANCES
							XKB	ANGULAR
								±5°
								±0.2
								±0.3
								±0.4
								±0.5

REVISIONS  
www.helloxkb.com

DSND	DATE	SCALE: N/A	MODEL TYPE: X2531HM-XXG-N0
DWN	DATE	VIEW:	PART NO.:
CHKD	DATE	UNIT: mm/in	DWG NO.:
APPD	DATE	SIZE: A4	
<b>XKB INDUSTRIAL PRECISION CO., LIMITED</b>			
WEIGHT	SHEET	SHEET	REVISION
1.0g	1/1		A0

## X-ON Electronics

Largest Supplier of Electrical and Electronic Components

*Click to view similar products for [Headers & Wire Housings](#) category:*

*Click to view products by [XKB](#) manufacturer:*

Other Similar products are found below :

[57102-F02-18ULF](#) [58102-G61-06LF](#) [582553-1](#) [009176003701906](#) [01.001.5753.1](#) [0050291907](#) [02.125.8002.8](#) [609-3404](#) [61062-3](#)  
[CSU011177004](#) [622-0430](#) [622-3653LF](#) [63453-116](#) [636-1030](#) [636-1427](#) [636-3427](#) [636-4007](#) [641938-9](#) [644827-2](#) [65495-038](#) [65692-001LF](#)  
[65781-018](#) [65781-047](#) [65817-010LF](#) [65817-015LF](#) [66207-023LF](#) [67095-007LF](#) [67601157](#) [68631-112](#) [68645-018](#) [699319-000](#)  
[M90C108951C](#) [70.362.1628.0](#) [70-4210](#) [70-4226B](#) [70-4853B](#) [707-5028](#) [71.350.2428.0](#) [71961-016LF](#) [733-134](#) [733-162](#) [754199-000](#) [760-](#)  
[3052](#) [80.063.4001.1](#) [800-90-001-10-001000](#) [800-90-010-10-002000](#) [801-43-002-10-013000](#) [801-43-006-10-002000](#) [803-41-018-10-001000](#)  
[803-43-024-10-001000](#)