

For and on behalf of  
**XKB INDUSTRIAL PRECISION CO., LIMITED**  
 香港星坤工業精密有限公司

Authorized Signature(s)

MARK	DESCRIPTION	DATE	REVISED	APPROVED	UNSPECIFIED TOLERANCES
△ X					L > 63 ± 0.5
△ X					16 < L ≤ 63 ± 0.4
△ X					4 < L ≤ 16 ± 0.3
					L ≤ 4 ± 0.2
					ANGULAR ± 5°

REVISIONS	DATE	REVISED	APPROVED	UNSPECIFIED TOLERANCES
				L > 63 ± 0.5
				16 < L ≤ 63 ± 0.4
				4 < L ≤ 16 ± 0.3
				L ≤ 4 ± 0.2
				ANGULAR ± 5°

DSND	DATE	SCALE: N/A	MODEL TYPE: X2530H-XX-PT
DWN <th>DATE</th> <th>VIEW: </th> <th>PART NO.: 2.54mm Crimp Style Connectors</th>	DATE	VIEW:	PART NO.: 2.54mm Crimp Style Connectors
CHKD <th>DATE</th> <th>UNIT: mm</th> <th>DWG NO.:</th>	DATE	UNIT: mm	DWG NO.:
APPD <th>DATE</th> <th>SIZE: A4</th> <th>WEIGHT 1.0g</th>	DATE	SIZE: A4	WEIGHT 1.0g

REVISION	SHEET	1/1	A0

PART NO	Material	Suitable XKB Terminal
X2530H-XX-PT	PBT UL 94V-0	X2530T
X2530W		Suitable XKB Terminal

Poles	Dimensions(mm)		
	A	B	C
02	2.54	5.60	7.10
03	5.08	8.14	9.64
04	7.62	10.68	12.18
05	10.16	13.22	14.72
06	12.70	15.76	17.26
07	15.24	18.30	19.80
08	17.78	20.84	22.34
09	20.32	23.38	24.88
10	22.86	25.92	27.42
11	25.40	28.46	29.96
12	27.94	31.00	32.50

- ① Series No.  
 ② Category: H-HSG  
 ③ Welding Board Angle: Blank-ordinary  
 ④ Row No.-Pin No.: XX-Single Row(02~22P)  
 ⑤ Plug the Pin & special No.  
 ⑥ Material: PT-PBT 94V-0  
 ⑦ Color: Blank-Natural Color
- X2530 H X-XX X-PT XX  
 ① ② ③ ④ ⑤ ⑥ ⑦

- Specifications :**  
 • Voltage rating: 250V AC / DC  
 • Current rating: 3A AC / DC  
 • Withstanding voltage: 800V AC/minute  
 • Temperature range: -25°C~+85°C  
 • Insulation resistance: ≥1000MΩ  
 • Contact resistance: ≤10mΩ  
 • After environmental testing: ≤20mΩ

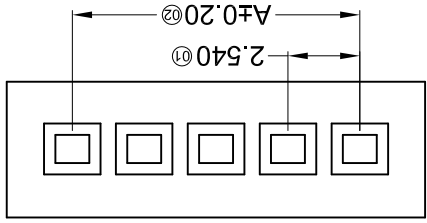
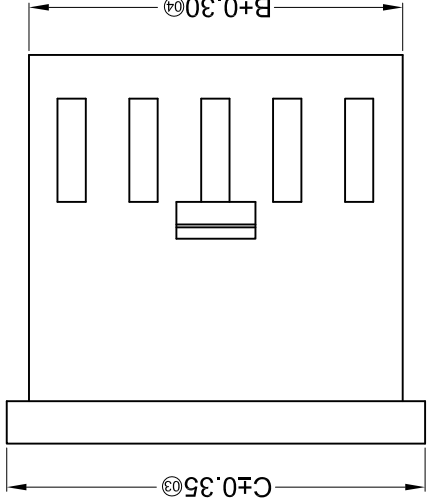
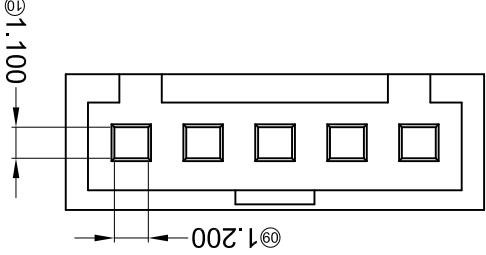
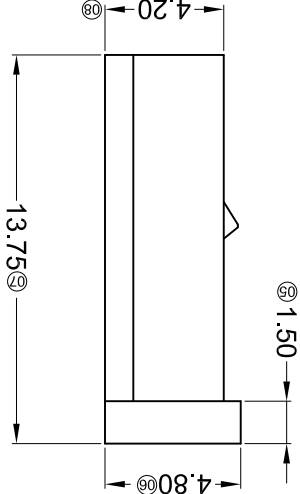
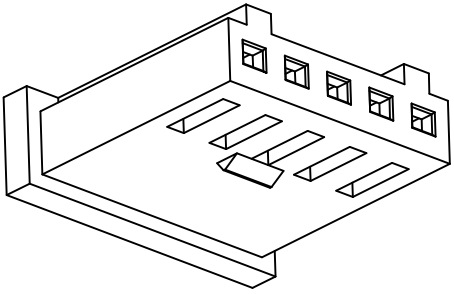

## X-ON Electronics

Largest Supplier of Electrical and Electronic Components

*Click to view similar products for [Headers & Wire Housings](#) category:*

*Click to view products by [XKB](#) manufacturer:*

Other Similar products are found below :

[95000-104TRLF](#) [10135584-644402LF](#) [DF62W-EP2022PCA](#) [95000-106TRLF](#) [DF62W-2022SCA](#) [DF62W-EP2022PC](#) [2203348](#) [DF62W-2022SC](#) [1084018](#) [1029039](#) [1084017](#) [802-10-012-10-002000](#) [1112640](#) [1112639](#) [891-007-9SS-BST1T](#) [000-34000](#) [0008550134](#) [0009482033](#) [0009507031](#) [57102-F02-18ULF](#) [57102-S06-03LF](#) [57202-S52-04LF](#) [PCN6-15S-2.5E](#) [0039019024](#) [58102-G61-06LF](#) [582553-1](#) [0009485154](#) [0009508121](#) [0022285053](#) [0050291907](#) [018731A](#) [LY20-4P-DT1-P1E-BR](#) [02.125.8002.8](#) [60101931](#) [60598-1 \(Cut Strip\)](#) [M1625-3R/100](#) [61062-3](#) [61082-181009](#) [CSU011177004](#) [636-1427](#) [638009-1](#) [641938-9](#) [641991-4](#) [644168-1](#) [644827-2](#) [647662-1](#) [65039-019ELF](#) [65692-001LF](#) [65781-018](#) [65781-047](#)