

With Ears

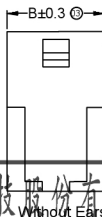

Without Ears

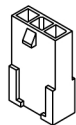
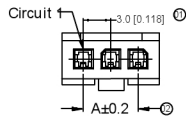
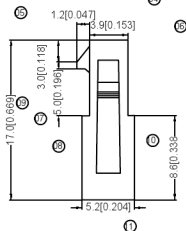
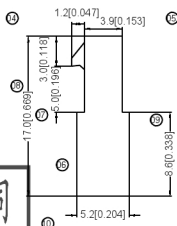

1X6PIN



1X8PIN



1X9PIN



1X10PIN



1X11PIN



1X12PIN



1X7PIN



1X5PIN



1X4PIN



1X3PIN



1X2PIN

Specifications :

- Voltage rating: 250V AC / DC
- Current rating: 5A AC / DC
- Withstanding voltage: 1000V AC/minute
- Temperature range: -40°C~+105°C
- Insulation resistance: ≥1000MΩ
- Contact resistance: ≤10mΩ
- After environmental testing : ≤20mΩ

X3025 H F-XX XX-N2 XX



- ⊙ Series No.
- ⊙ Category : H-HSG
- ⊕ Welding Board Angle : F-Female HSG
- ⊖ Row No.-Pin No. : XX-02P~12P
- ⊗ Plug the Pin & special No. : I-With Ears
G-With Ears
- ⊙ Material : N2-PA66 94 V-2;
- ⊙ Color : Blank-Natural Color ; WH-White

Poles	Dimensions(mm)		Poles	Dimensions(mm)	
	A	B		A	B
02	3.00	6.90	08	21.00	24.90
03	6.00	9.90	09	24.00	27.90
04	9.00	12.90	10	27.00	30.90
05	12.00	15.90	11	30.00	33.90
06	15.00	18.90	12	33.00	36.90
07	18.00	21.90			

PART NO	Material	Color	Suitable X/B Terminal	Main With X/B Hooking	Note
X3025HF-XXG-N2	Nylon 66 94V-2	Natural Color	X3025TM	X3025HM	With Ears
X3025HF-XXG-N2WH	Nylon 66 94V-2	White			
X3025HF-XXN2	Nylon 66 94V-2	Natural Color	X3025TM	X3025HM	Without Ears
X3025HF-XXN2WH	Nylon 66 94V-2	White			

广东星坤科技股份有限公司

生 日期
發 日期

文件工程章

REVISIONS
www.heloxkb.com

DATE	REVISED	APPROVED	XKB	ANGULAR	±5°
				L ≤ 4	±0.2
				4 < L ≤ 16	±0.3
				16 < L ≤ 63	±0.4
				L > 63	±0.5

UNSPECIFIED TOLERANCES

DSND	DATE	SCALE: N/A	MODEL TYPE:
DWNN	DATE	VIEW:	X3025HF-XXX-N2
CHKD	DATE	UNIT: mm/in	PART NO.: 3.00 mm Crimp Style Connectors
APPD	DATE	SIZE: A4	DWG NO.:
XKB INDUSTRIAL PRECISION CO., LIMITED			WEIGHT: 1.0g
			SHEET: 1/1
			REVISION: A0

X-ON Electronics

Largest Supplier of Electrical and Electronic Components

Click to view similar products for [Headers & Wire Housings](#) category:

Click to view products by [XKB](#) manufacturer:

Other Similar products are found below :

[57102-F02-18ULF](#) [58102-G61-06LF](#) [582553-1](#) [009176003701906](#) [0050291907](#) [02.125.8002.8](#) [609-3404](#) [61062-3](#) [622-0430](#) [622-3653LF](#)
[63453-116](#) [636-1030](#) [636-1427](#) [636-3427](#) [636-4007](#) [641938-9](#) [65495-038](#) [65692-001LF](#) [65781-018](#) [65781-047](#) [65817-010LF](#) [65817-015LF](#)
[66207-023LF](#) [67016-026LF](#) [67095-007LF](#) [68631-112](#) [68645-018](#) [68648-049](#) [699319-000](#) [M90C108951C](#) [70.362.1628.0](#) [70-4210](#) [70-4226B](#)
[70-4853B](#) [707-5020](#) [707-5028](#) [71.350.2428.0](#) [71961-016LF](#) [733-134](#) [754199-000](#) [760-3052](#) [787-8014-00](#) [FCN-367T-T012/H](#)
[80.063.4001.1](#) [800-90-001-10-001000](#) [801-43-002-10-013000](#) [801-43-006-10-002000](#) [803-41-018-10-001000](#) [803-43-014-20-001000](#)
[803-43-024-10-001000](#)