

Specifications:

规格:

Voltage rating:600V AC/DC

额定电压: 600V AC/DC

Current rating:7A AC/DC

额定电流: 7A AC/DC

Withstanding voltage:1500V AC/minute

耐受电压: 1500V AC/分钟

Temperature range:-40℃~+125℃

温度范围: -40℃~+125℃

Insulation resistance:1000MΩ min

绝缘电阻: 1000MΩ min

Contact resistance:20mΩ max

接触电阻: 20mΩ max

X4140 H M - XX - N0

① ② ③ ④ ⑤

1. Series No
2. Category:H-Housing
3. Housing Type:M-Male Housing
4. Row No.Pin No:XX-01~03P
5. Material:N0-PA66 94V-0

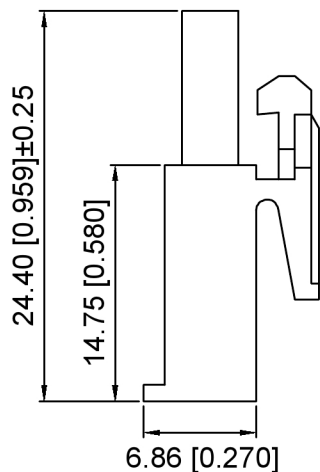

1P

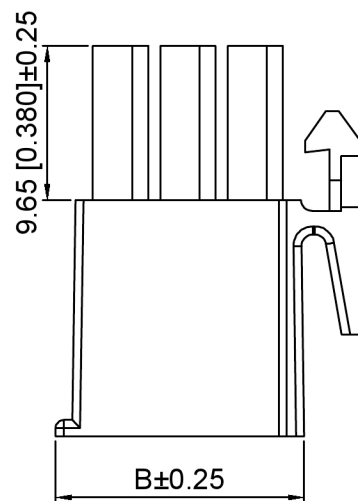

2P~3P

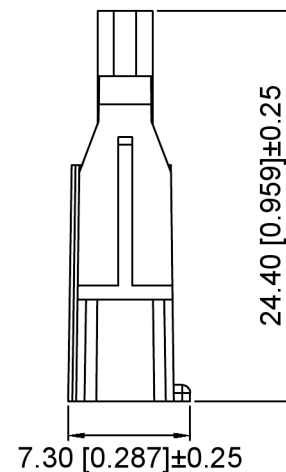

| Poles | Dimensions(mm) | |
|-------|----------------|-------|
| | A | B |
| 02 | 8.28 | 11.00 |
| 03 | 12.42 | 15.14 |

| | | | | |
|---------------|----------|--------------------|----------------------|-----------------------|
| X4140HM-XX-N0 | PA66 | X4140W | X4140HF | X4140TF |
| PART NO | Material | Suitable XKB Wafer | Suitable XKB Housing | Suitable XKB Terminal |

| | | |
|------|-------------|---|
| DSND | SCALE: N/A | MODEL TYPE: 4.14mm Crimp Style Connector |
| DWN | VIEW: | PART NO.: X4140HM-XX-N0 |
| CHKD | UNIT: mm/in | DWG NO.: X-X4140HM-XX-N0 |
| APPD | SIZE: A4 | WEIGHT |
| | | SHEET |
| | | REVISION |
| | | 1/1 |
| | | A0 |

XKB

XKB INDUSTRIAL PRECISION CO.,LIMITED

| | | | | | | |
|---|-------------|------|---------|----------|------------------------|------|
| | | | | | ANGULAR | ±5° |
| ΔX | | | | | L ≤ 4 | ±0.2 |
| ΔX | | | | | 4 < L ≤ 16 | ±0.3 |
| ΔX | | | | | 16 < L ≤ 63 | ±0.4 |
| MARK | DESCRIPTION | DATE | REVISED | APPROVED | L > 63 | ±0.5 |
| REVISIONS | | | | | UNSPECIFIED TOLERANCES | |
| www.helloxkb.com www.helloxkb.cn www.xk-dg.cn | | | | | | |

X-ON Electronics

Largest Supplier of Electrical and Electronic Components

Click to view similar products for [Pluggable Terminal Blocks](#) category:

Click to view products by [XKB](#) manufacturer:

Other Similar products are found below :

[57.510.0053](#) [721-104/026-047](#) [721-204/026-045](#) [MC 1.5/ 6-ST-3.5 GY AU](#) [ET02015000J0G](#) [860505](#) [860516](#) [860810](#) [GBPACX-12](#)
[93.731.4953.0](#) [PVP03-3,50](#) [PVS02-5,00](#) [1-1986160-3](#) [1377680000](#) [1531000000](#) [1546228-5](#) [ELFP03110](#) [ELFP10210](#) [ELFT07250](#)
[ELVD12100](#) [ELVF09400](#) [ELXH071G0E](#) [1725220000](#) [1760336](#) [1855000000](#) [19346](#) [1946309](#) [1973592](#) [19892](#) [25.320.4053.1](#) [25.320.4553.9](#)
[25.320.4753.1](#) [25.320.5453.1](#) [25.340.0353.1](#) [25.340.1053.1](#) [25.345.3553.0M001](#) [25.640.3553.1](#) [SH02-5,08](#) [SH06-3,81](#) [SH08-5,08](#) [SH08-](#)
[5,08-K](#) [SH12-5,08](#) [SHS04-5,00](#) [30.303](#) [30.305](#) [30.306](#) [PHP09-5,08](#) [25.193.0453.0](#) [25.320.4653.1](#) [25.332.2453.1](#)