

P.C.B LAYOUT

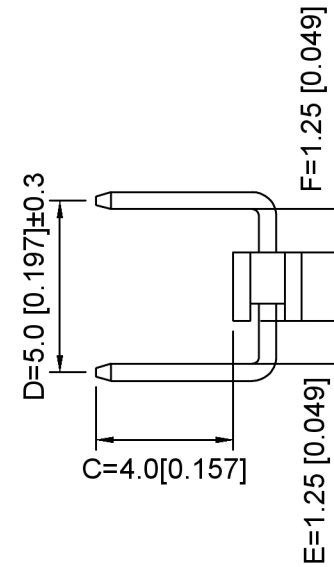

Specifications:

规格:
 Voltage rating: 250V AC/DC
 额定电压: 250V AC/DC
 Current rating: 2A AC/DC
 额定电流: 2A AC/DC
 Withstanding voltage: 500V AC/minute
 耐受电压: 500V AC/分钟
 Temperature range: -40°C ~ +105°C
 温度范围: -40°C ~ +105°C
 Insulation resistance: ≥1000MΩ
 绝缘电阻: ≥1000MΩ
 Contact resistance: ≤20mΩ
 接触电阻: ≤20mΩ
 Material: PA6T UL94V-0
 材质: PA6T UL94V-0
 Plating Category: 1U"Gold
 镀层: 1U"Gold
 Wave soldering temperature: 255±5°C, 10S
 波峰焊温度: 255±5°C, 10S

X4611 W R - XX I U - C40 D50 - E12 F12
 ① ② ③ ④ ⑤ ⑥ ⑦ ⑧ ⑨ ⑩

1. Series No.
2. Category: W-Water
3. Welding Board Angle: R-Straight 90°
4. Row No - Pin No: XX-02P-40P
5. Plastic height: l=2.0mm
6. U: U-Type U
7. Plastic height: C=4.0mm
8. Pin Pitch: D=5.0mm
9. Pin length: E=1.25mm
10. Pin length: F=1.25mm

| | | | | |
|----------------------------|----------|---------------|-------------|---------------------|
| X4611WR-XXIU-C40D50-E12F12 | PA6T | Brass | 1U"Gold | X4611F |
| PART NO | Material | Material(Pin) | Finish(Pin) | Suitable XKB Female |

| | | |
|------|-------------|--|
| DSND | SCALE: N/A | MODEL TYPE: 2.00mm BTB Connector |
| DWN | VIEW: | PART NO.: X4611WR-XXIU-C40D50-E12F12 |
| CHKD | UNIT: mm/in | DWG NO.: X-X4611WR-XXIU-C40D50-E12F12 |
| APPD | SIZE: A4 | WEIGHT SHEET REVISION 1/1 A0 |



XKB INDUSTRIAL PRECISION CO., LIMITED

| | |
|------------------------|------|
| ANGLAR | ±5° |
| L ≤ 4 | ±0.2 |
| 4 < L ≤ 16 | ±0.3 |
| 16 < L ≤ 63 | ±0.4 |
| L > 63 | ±0.5 |
| UNSPECIFIED TOLERANCES | |

广东星坤科技股份有限公司

| | | | | |
|------|-------------|------|---------|----------|
| MARK | DESCRIPTION | DATE | REVISED | APPROVED |
| 文件 | 工程章 | | | |

X-ON Electronics

Largest Supplier of Electrical and Electronic Components

Click to view similar products for [Headers & Wire Housings](#) category:

Click to view products by [XKB](#) manufacturer:

Other Similar products are found below :

[57102-F02-18ULF](#) [58102-G61-06LF](#) [582553-1](#) [009176003701906](#) [01.001.5753.1](#) [0050291907](#) [02.125.8002.8](#) [609-3404](#) [61062-3](#)
[CSU011177004](#) [622-0430](#) [622-3653LF](#) [63453-116](#) [636-1030](#) [636-1427](#) [636-3427](#) [636-4007](#) [641938-9](#) [644827-2](#) [65495-038](#) [65692-001LF](#)
[65781-018](#) [65781-047](#) [65817-010LF](#) [65817-015LF](#) [66207-023LF](#) [67095-007LF](#) [67601157](#) [68631-112](#) [68645-018](#) [699319-000](#)
[M90C108951C](#) [70.362.1628.0](#) [70-4210](#) [70-4226B](#) [70-4853B](#) [707-5028](#) [71.350.2428.0](#) [71961-016LF](#) [733-134](#) [733-162](#) [754199-000](#) [760-](#)
[3052](#) [80.063.4001.1](#) [800-90-001-10-001000](#) [800-90-010-10-002000](#) [801-43-002-10-013000](#) [801-43-006-10-002000](#) [803-41-018-10-001000](#)
[803-43-024-10-001000](#)