

XJB Connectivity

| Pin数 | 尺寸A | 尺寸B |
|------|-----|-----|
| 1    |     | 2   |
| 2    | 2   | 4   |
| 3    | 4   | 6   |
| 4    | 6   | 8   |
| 5    | 8   | 10  |
| 6    | 10  | 12  |
| 7    | 12  | 14  |
| 8    | 14  | 16  |
| 9    | 16  | 18  |
| 10   | 18  | 20  |
| 11   | 20  | 22  |
| 12   | 22  | 24  |
| 13   | 24  | 26  |
| 14   | 26  | 28  |
| 15   | 28  | 30  |
| 16   | 30  | 32  |
| 17   | 32  | 34  |
| 18   | 34  | 36  |
| 19   | 36  | 38  |
| 20   | 38  | 40  |
| 21   | 40  | 42  |
| 22   | 42  | 44  |
| 23   | 44  | 46  |
| 24   | 46  | 48  |
| 25   | 48  | 50  |
| 26   | 50  | 52  |
| 27   | 52  | 54  |
| 28   | 54  | 56  |
| 29   | 56  | 58  |
| 30   | 58  | 60  |
| 31   | 60  | 62  |
| 32   | 62  | 64  |
| 33   | 64  | 66  |
| 34   | 66  | 68  |
| 35   | 68  | 70  |
| 36   | 70  | 72  |
| 37   | 72  | 74  |
| 38   | 74  | 76  |
| 39   | 76  | 78  |
| 40   | 78  | 80  |

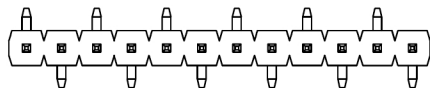

TYPE 1

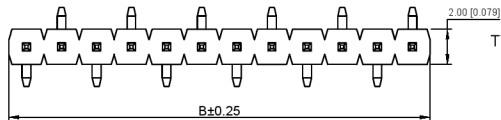

TYPE 2

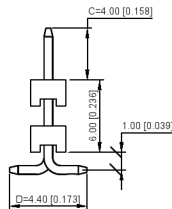
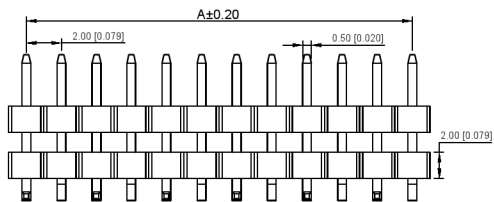

XJB Connectivity  
PCB LAYOUT

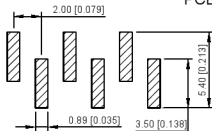

TYPE 1

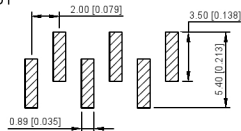

TYPE 2

XJB Connectivity

规格 Specifications:

- 额定电压 Voltage rating:250VAC/DC.
- 额定电流 Current rating:3A AC/DC
- 耐电压 Withstanding voltage:1000V AC/minute
- 温度区间 Temperature range:-40℃to+105℃
- 绝缘电阻 Insulation resistance:≥1000MΩ Min
- 接触电阻 Contact resistance:≤20MΩ Max
- 材料 Material: PA6T 94V-0
- 镀层 Plating Category: 1U"Gold
- 颜色 color: Blank-Natural color

XJB Connectivity

X4612 WVS - XXI - C40 D44 - X

(01) (02) (03) (04) (05) (06) (07) (08) (09)

- (01) Series No.
- (02) Category:W-wafer
- (03) Welding Board Angle:V-Stright 90°
- (04) Welding Way:S-SMT
- (05) Row No-Pin No:XX-01P-40P
- (06) Plastic height: l=2.0mm
- (07) Pin length:C=3.0mm
- (08) Pin length:D=6.0mm
- (09) TYPE:R1;R2

XJB Connectivity

|                       |            |               |             |                       |
|-----------------------|------------|---------------|-------------|-----------------------|
| X4612WVS-XXI-C40D44-X | PA6T 94V-0 | Brass         | 1U"Gold     | X4612F                |
| PART NO               | Material   | Material(Pin) | Finish(Pin) | Suitable XJB Terminal |

广东星坤科技股份有限公司

生  
發

日  
期

文件工程章

REVISIONS

www.xkpcb.com www.hellixkb.com

UNSPECIFIED TOLERANCES

|                                      |      |             |   |
|--------------------------------------|------|-------------|---|
| DSND                                 | DATE | SCALE: N/A  | MODEL TYPE:<br>X4612WVS-XXI-C40D44-X      |
| DWNN                                 | DATE | VIEW:       | PART NO.:<br>2.00mm Crimp Style Connector |
| CHKD                                 | DATE | UNIT: mm/in | DWG NO.:                                  |
| APPD                                 | DATE | SIZE: A4    |   |
| XKB INDUSTRIAL PRECISION CO.,LIMITED |      |             | WEIGHT<br>1.0g                            |
|                                      |      |             | SHEET<br>1/1                              |
|                                      |      |             | REVISION<br>A0                            |

## X-ON Electronics

Largest Supplier of Electrical and Electronic Components

*Click to view similar products for [Headers & Wire Housings](#) category:*

*Click to view products by [XKB](#) manufacturer:*

Other Similar products are found below :

[57102-F02-18ULF](#) [58102-G61-06LF](#) [0009485154](#) [009176003701906](#) [0050291907](#) [00-9021-0611-00-339](#) [02.125.8002.8](#) [609-3404](#) [61062-3](#)  
[622-0430](#) [622-3653LF](#) [63453-116](#) [636-1030](#) [636-1427](#) [636-3427](#) [636-4007](#) [641938-9](#) [644827-2](#) [65495-038](#) [65692-001LF](#) [65781-018](#)  
[65781-047](#) [65817-010LF](#) [65817-015LF](#) [66207-023LF](#) [67016-026LF](#) [67095-007LF](#) [68631-112](#) [68645-018](#) [68648-049](#) [699319-000](#)  
[70.362.1628.0](#) [70-4210](#) [70-4226B](#) [70-4853B](#) [707-5020](#) [707-5028](#) [71.350.2428.0](#) [71961-016LF](#) [733-134](#) [754199-000](#) [760-3052](#) [787-8014-00](#)  
[FCN-367T-T012/H](#) [80.063.4001.1](#) [800-90-001-10-001000](#) [800-90-010-10-002000](#) [801-43-002-10-013000](#) [801-43-006-10-002000](#)  
[803-41-018-10-001000](#)