

XKB Connectivity

Technical Data

Pin(outer sleeve):Brass,machined CuZn38Pb2
 Cllp(Contact 4 Finger):Beryllium copper,heat treated

Insulator:PPS UL94V-0 colour:black
 Current rating:3Amps

Mating pin Ø:0.635/0.889mm
 Forces:(polished steel gaugeØ0.43mm)

-Insertion:2N typ
 -Withdrawal:1N typ

Mechanical life:min 500cycles

Contact resistance:max 10m Ω
 Dielectric strength:min 1000V RMS
 Operating temperature:-40°C to+105°C
 Soldering temperature:+255°C

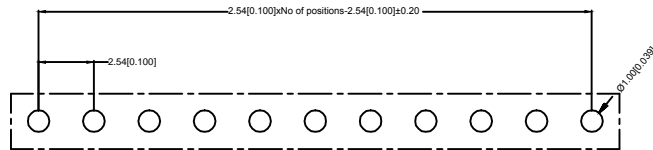
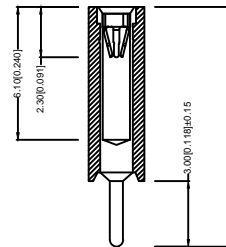
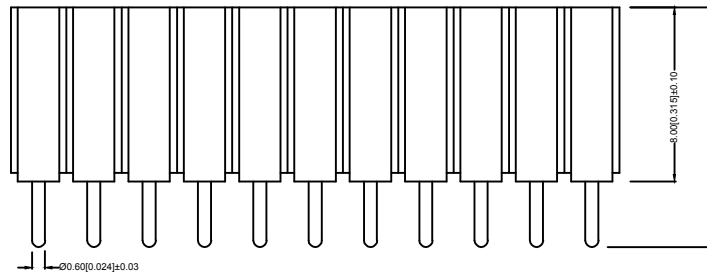
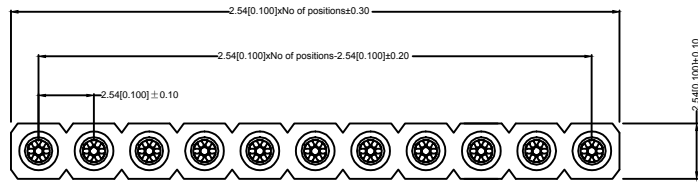

**Recommended P.C.B
 Layout(±0.05)**

XKB Connectivity

X5511 F V-XX -C80 D30- 1100

- ①
- ②
- ③
- ④
- ⑤
- ⑥
- ⑦

- ① Series.NO.
- ② Category : F-Female
- ③ Welding Board Angle : V-straight 180°
- ④ Row No-Pin No:XX-01P-XXP
- ⑤ Pin Length :C=8.0mm
- ⑥ Pin Length :D=3.0mm
- ⑦ 1100:Type1100

XKB Connectivity

X5511FV-XX-C80D30-1100	PPS 94V-0	Brass	Tin Gold 1u"	X5511W
PART NO	Material	Material(Terminal)	Finish(Terminal)	Mates With XKB Pin Header

						ANGLAR	±5°	DSND		DATE	SCALE: N/A	MODEL TYPE: X5511FV-XX-C80D30-1100		
Δx						L ≤ 4	±0.2	DWN		DATE	VIEW:	PART NO.:		
Δx						4 < L ≤ 16	±0.3	CHKD		DATE	UNIT: mm/in	DWG NO.:		
Δx						16 < L ≤ 63	±0.4	APPD		DATE	SIZE: A4			
MARK	DESCRIPTION	DATE	REVISED	APPROVED		L > 63	±0.5							
REVISIONS						UNSPECIFIED TOLERANCES		XKB INDUSTRIAL PRECISION CO.,LIMITED				WEIGHT	SHEET	REVISION
www.xk-dg.cn www.helloxkb.com www.helloxkb.cn												1.0g	1/1	A0

X-ON Electronics

Largest Supplier of Electrical and Electronic Components

Click to view similar products for [Headers & Wire Housings](#) category:

Click to view products by [XKB](#) manufacturer:

Other Similar products are found below :

[0015917161](#) [0022155065](#) [57102-F02-18ULF](#) [58102-G61-06LF](#) [582553-1](#) [01.001.5753.1](#) [0050291907](#) [02.125.8002.8](#) [609-3404](#) [61062-3](#)
[CSU011177004](#) [622-0430](#) [622-3653LF](#) [63453-116](#) [636-1030](#) [636-1427](#) [636-3427](#) [636-4007](#) [641938-9](#) [65495-038](#) [65692-001LF](#) [65781-018](#)
[65781-047](#) [65817-010LF](#) [65817-015LF](#) [67095-007LF](#) [67601157](#) [68631-112](#) [68645-018](#) [699319-000](#) [70.362.1628.0](#) [70-4210](#) [70-4226B](#) [70-](#)
[4853B](#) [71.350.2428.0](#) [733-134](#) [733-162](#) [760-3052](#) [MHR-64-VUAL](#) [80.063.4001.1](#) [800-90-001-10-001000](#) [801-43-002-10-013000](#)
[801-43-006-10-002000](#) [803-43-024-10-001000](#) [803-93-012-10-001000](#) [8-1437020-4](#) [819-22-004-30-001101](#) [820-22-006-30-001101](#)
[820-22-008-30-001101](#) [821-22-002-10-001101](#)