

Technical Data
 Pin(outer sleeve):Brass,machined CuZn38Pb2
 Insulator:PPS UL94V-0 colour:black
 Current rating:3Amps
 Mating pin Ø:0.60mm
 Mechanical life:min 500cycles
 Contact resistance:max 10m Ω
 Dielectric strength:min 1000V RMS
 Operating temperature:-40°C to+105°C
 Soldering temperature:+255°C

| Poles | Dimenslons(mm) A |
|-------|---------------------|
| 2*02 | 5.08 |
| 2*03 | 7.62 |
| 2*04 | 10.16 |
| 2*05 | 12.70 |
| 2*06 | 15.24 |
| 2*07 | 17.78 |
| 2*08 | 20.32 |
| 2*09 | 22.86 |
| 2*10 | 25.40 |
| 2*12 | 30.48 |
| 2*14 | 35.56 |
| 2*16 | 40.64 |
| 2*20 | 50.80 |
| 2*21 | 53.34 |
| 2*24 | 60.96 |
| 2*25 | 63.50 |

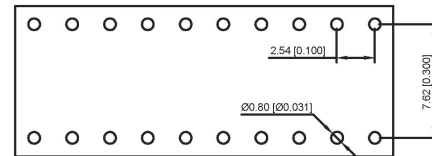
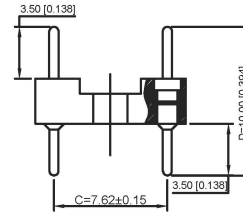
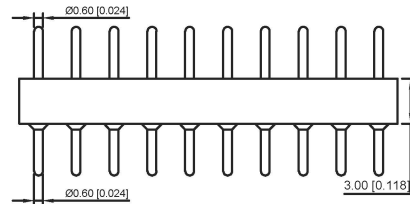
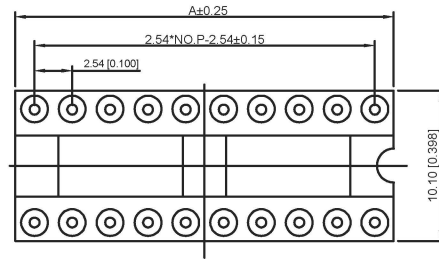

Recommended P.C.B
Layout(±0.05)

X5621 W V-2*XX-C762 D1000-1000

- ① Series.NO.
- ② Category : W-Wafer
- ③ Welding Board Angle : V-Straight 180°
- ④ Row No-Pin No:2*XX-03,04,05,06,07,08,09,10,12,14,16 20,21,24,25
- ⑤ Plastic Height :C=7.62mm
- ⑥ Pin Length :D:1000=10.0mm;0420=4.2mm;0740=7.40mm;
0743=7.43mm;0920=9.20mm;1020=10.20mm;1120=11.20mm;
1150=11.50mm;1170=11.70mm;1390=13.9mm;1340=13.40mm
1370=13.70mm;1420=14.20mm;1520=15.20mm;1620-16.20mm
1780=17.80mm;1820=18.20mm
- ⑦ 1000 Type1000

| | | | | |
|-----------------------------|-----------|--------------------|------------------|---------------------------|
| X5621WV-2*XX-C762D1000-1000 | PPS 94V-0 | Brass | Tin Gold 1u" | X5621F |
| PART NO | Material | Material(Terminal) | Finish(Terminal) | Mates With XKB Pin Header |

广东星坤科技股份有限公司

生 日期
 發 日期

ΔX MARK 文件工程章

REVISIONS

www.xk-ig.cn www.helloxkb.com www.helloxkb.cn

ANGLAR ±5°
 L ≤ 4 ±0.2
 4 < L ≤ 16 ±0.3
 16 < L ≤ 63 ±0.4
 L > 63 ±0.5

UNSPECIFIED TOLERANCES

| | | | |
|---------------------------------------|------|-------------|-----------------------------|
| DSND | DATE | SCALE: N/A | MODEL TYPE: |
| DWN | DATE | VIEW: | PART NO.: |
| CHKD | DATE | UNIT: mm/in | DWG NO.: |
| APPD | DATE | SIZE: A4 | X5621WV-2*XX-C762D1000-1000 |
| KKB INDUSTRIAL PRECISION CO., LIMITED | | | WEIGHT SHEET REVISION |
| | | | 1.0g 1/1 A0 |

X-ON Electronics

Largest Supplier of Electrical and Electronic Components

Click to view similar products for [IC & Component Sockets](#) category:

Click to view products by [XKB](#) manufacturer:

Other Similar products are found below :

[614-DG5](#) [670](#) [672](#) [673](#) [712-93-120-41-001000](#) [714-93-104-31-018000](#) [8-1437531-4](#) [8150-6P10](#) [835-43-014-10-001000](#) [851-41-006-10-001000](#) [851-43-008-20-001000](#) [851-43-014-20-001000](#) [851-93-006-20-001000](#) [851-93-010-20-001000](#) [853-43-020-10-001000](#) [86.010.0053.0](#) [116-43-308-41-007000](#) [121-13-318-41-001000](#) [121-13-320-41-001000](#) [121-13-308-41-001000](#) [123-43-314-41-801000](#) [123-43-420-41-001000](#) [122-13-316-41-001000](#) [123-13-624-41-001000](#) [123-43-306-41-001000](#) [12-3513-11](#) [123-91-320-41-001000](#) [126-43-310-41-002000](#) [AKSUN](#) [37V-T](#) [1437503-9](#) [1437504-1](#) [APA-640-G-P](#) [146-44-308-41-013000](#) [146-43-308-41-012000](#) [160-10-308-00-001000](#) [160-40-320-00-001000](#) [214-99-306-01-670800](#) [2-382761-4](#) [2-5331677-4](#) [2-640360-3](#) [2801-3-00-44-00-00-07-0](#) [940-44-052-17-400004](#) [299-83-314-11-001101](#) [1986000-2](#) [2103331641101000](#) [210-43-320-41-001000](#) [210-99-628-41-001000](#) [2-1437504-6](#) [2-1437515-5](#) [2-1437531-2](#)