

Poles	Dimensions (mm)	
	AB	
2x01	8.35	
2x02	12.05	5.70
2x03	17.75	11.40
2x04	23.45	17.10
2x05	29.15	22.80
2x06	34.85	28.50

Specifications:

Voltage rating: 600V AC / DC
 Current rating: 16A AC / DC
 Withstanding voltage: 2200V AC/minute
 Temperature range: -40°C~+105°C
 Insulation resistance: ≥1000M Ω
 Contact resistance: ≤2mΩ
 After environmental testing : ≤10mΩ
 Special No.: H-High conductive Brass

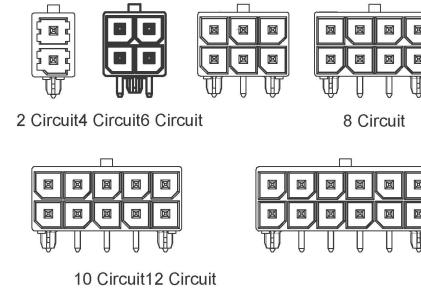
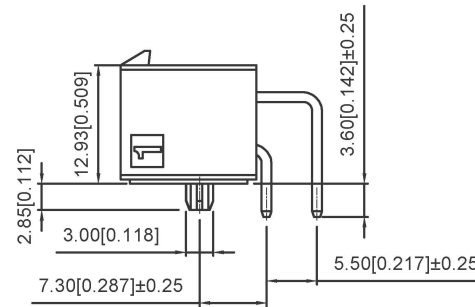
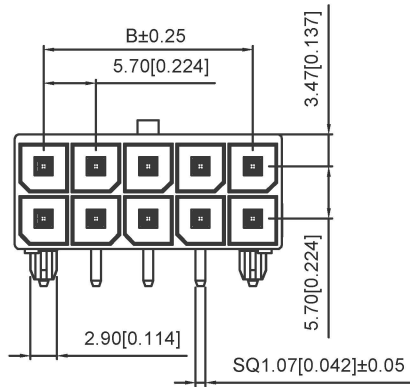

X5700 W R -2xXX -LP SW

- ① Series No.
- ② Category : W-WAFER
- ③ Welding Board Angle : R-Straight 90°
- ④ Row No.-Pin No.: 2xXX-2x02P~2x06P
- ⑤ Material: LP -LCP 94V-0
- ⑥ Plating Category: SW-Matte Tin Plating

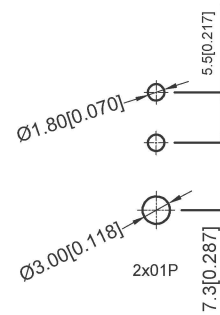
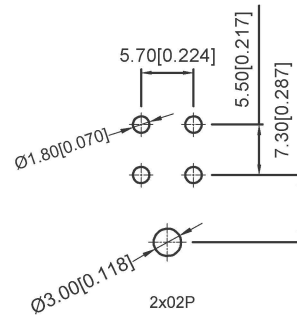
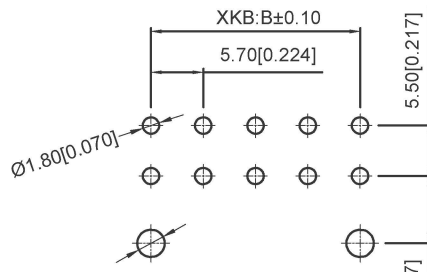

Recommended P.C.B Layout
 General Tolerance±0.05

X5700WR-2XXX-LPSW	High conductive Brass	X5700H	X5700T
PART NO	Material	Suitable XKB Terminal	Suitable XKB Terminal

广东星坤科技股份有限公司

生	日期
效	
效	
效	
MARK	文件工程章

units:	mm
tolerance:	
X.X	±0.2mm
X.XX	±0.1mm
X.XXX	±0.05mm
UNSPECIFIED TOLERANCES	

DSND	DATE	SCALE: N/A	MODEL TYPE: Wire to board connector
DWN	DATE	VIEW:	PART NO.:
CHKD	DATE	UNIT: mm/in	DWG NO.:
APPD	DATE	SIZE: A4	X5700WR-2xXX-LPSW
KKB INDUSTRIAL PRECISION CO., LIMITED			WEIGHT · SHEET · REVISION 1.0g · 1/1 · A0

X-ON Electronics

Largest Supplier of Electrical and Electronic Components

Click to view similar products for [Headers & Wire Housings](#) category:

Click to view products by [XKB](#) manufacturer:

Other Similar products are found below :

[57102-F02-18ULF](#) [58102-G61-06LF](#) [0009485154](#) [009176003701906](#) [0050291907](#) [00-9021-0611-00-339](#) [02.125.8002.8](#) [609-3404](#) [61062-3](#)
[622-0430](#) [622-3653LF](#) [63453-116](#) [636-1030](#) [636-1427](#) [636-3427](#) [636-4007](#) [641938-9](#) [644827-2](#) [65495-038](#) [65692-001LF](#) [65781-018](#)
[65781-047](#) [65817-010LF](#) [65817-015LF](#) [66207-023LF](#) [67016-026LF](#) [67095-007LF](#) [68631-112](#) [68645-018](#) [68648-049](#) [699319-000](#)
[70.362.1628.0](#) [70-4210](#) [70-4226B](#) [70-4853B](#) [707-5020](#) [707-5028](#) [71.350.2428.0](#) [71961-016LF](#) [733-134](#) [754199-000](#) [760-3052](#) [787-8014-00](#)
[FCN-367T-T012/H](#) [80.063.4001.1](#) [800-90-001-10-001000](#) [800-90-010-10-002000](#) [801-43-002-10-013000](#) [801-43-006-10-002000](#)
[803-41-018-10-001000](#)