

PCB LAYOUT

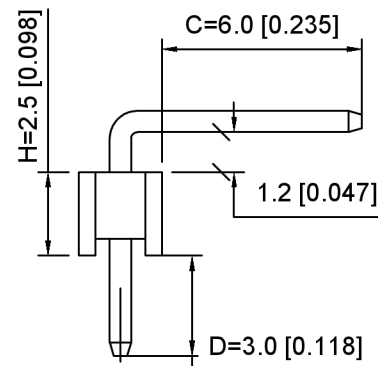

R1 TYPE

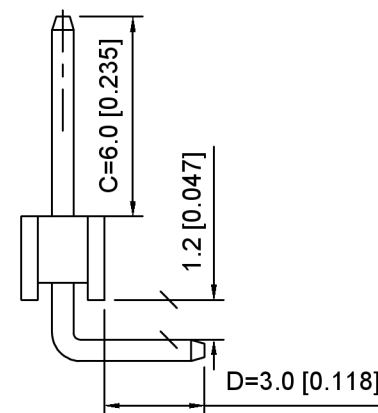

R2 TYPE

Specifications:
 规格:
 Voltage rating: 250V AC/DC
 额定电压: 250V AC/DC
 Current rating: 3A AC/DC
 额定电流: 3A AC/DC
 Withstanding voltage: 1000V AC/minute
 耐受电压: 1000V AC/分钟
 Temperature range: -40°C +105°C
 温度范围: -40°C +105°C
 Insulation resistance: ≥1000MΩ
 绝缘电阻: ≥1000MΩ
 Contact resistance: ≤20mΩ
 接触电阻: ≤20mΩ
 Material: PA6T UL94V-0
 材质: PA6T UL94V-0
 Plating Category: 1U"Gold
 镀层: 1U"Gold
 Wave soldering temperature: 255±5°C, 10S
 波峰焊温度: 255±5°C, 10S

X6511 W R - XX H - C60 D30 X
 ① ② ③ ④ ⑤ ⑥ ⑦ ⑧

- Series No
- Category: W-Wafer
- Welding Board Angle: R-Straight 90°
- Row No. Pin No: XX-02~40P
- Plastic Height: H=2.5mm
- Pin Length: C=6.0mm
- Pin Length: D=3.0mm
- Type: X-R1 ; R2

X6511WR-XXH-C60D30X	PA6T	Brass	X6511F
PART NO	Material	Material(Pin)	Suitable XKB Female

DSND	SCALE: N/A	MODEL TYPE: 2.54mm BTB Connector
DWN	VIEW:	PART NO.: X6511WR-XXH-C60D30X
CHKD	UNIT: mm/in	DWG NO.: X-X6511WR-XXH-C60D30X
APPD	SIZE: A4	WEIGHT SHEET REVISION 1/1 A0



XKB INDUSTRIAL PRECISION CO., LIMITED

广东星坤科技股份有限公司

Δ#	日期
ΔX	日期
ΔX	日期

MARK	DESCRIPTION	DATE	REVISED	APPROVED
------	-------------	------	---------	----------

文件工程章

ANGLAR	±5°
L ≤ 4	±0.2
4 < L ≤ 16	±0.3
16 < L ≤ 63	±0.4
L > 63	±0.5
UNSPECIFIED TOLERANCES	

X-ON Electronics

Largest Supplier of Electrical and Electronic Components

Click to view similar products for [Headers & Wire Housings](#) category:

Click to view products by [XKB](#) manufacturer:

Other Similar products are found below :

[57102-F02-18ULF](#) [58102-G61-06LF](#) [582553-1](#) [009176003701906](#) [01.001.5753.1](#) [0050291907](#) [02.125.8002.8](#) [609-3404](#) [61062-3](#)
[CSU011177004](#) [622-0430](#) [622-3653LF](#) [63453-116](#) [636-1030](#) [636-1427](#) [636-3427](#) [636-4007](#) [641938-9](#) [644827-2](#) [65495-038](#) [65692-001LF](#)
[65781-018](#) [65781-047](#) [65817-010LF](#) [65817-015LF](#) [66207-023LF](#) [67095-007LF](#) [67601157](#) [68631-112](#) [68645-018](#) [699319-000](#)
[M90C108951C](#) [70.362.1628.0](#) [70-4210](#) [70-4226B](#) [70-4853B](#) [707-5028](#) [71.350.2428.0](#) [71961-016LF](#) [733-134](#) [733-162](#) [754199-000](#) [760-](#)
[3052](#) [80.063.4001.1](#) [800-90-001-10-001000](#) [800-90-010-10-002000](#) [801-43-002-10-013000](#) [801-43-006-10-002000](#) [803-41-018-10-001000](#)
[803-43-024-10-001000](#)