

PCB LAYOUT

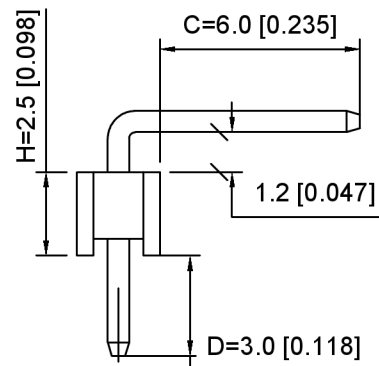

R1 TYPE

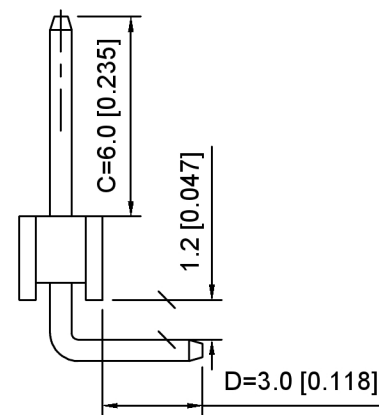

R2 TYPE

Specifications:

- 规格:
- Voltage rating: 250V AC/DC
  - 额定电压: 250V AC/DC
  - Current rating: 3A AC/DC
  - 额定电流: 3A AC/DC
  - Withstanding voltage: 1000V AC/minute
  - 耐受电压: 1000V AC/分钟
  - Temperature range: -40°C +105°C
  - 温度范围: -40°C +105°C
  - Insulation resistance: ≥1000MΩ
  - 绝缘电阻: ≥1000MΩ
  - Contact resistance: ≤20mΩ
  - 接触电阻: ≤20mΩ
  - Material: PA6T UL94V-0
  - 材质: PA6T UL94V-0
  - Plating Category: 1U"Gold
  - 镀层: 1U"Gold
  - Wave soldering temperature: 255±5°C, 10S
  - 波峰焊温度: 255±5°C, 10S

X6511 W R - XX H - C60 D30 X  
 ① ② ③ ④ ⑤ ⑥ ⑦ ⑧

- Series No
- Category: W-Wafer
- Welding Board Angle: R-Straight 90°
- Row No. Pin No: XX-02~40P
- Plastic Height: H=2.5mm
- Pin Length: C=6.0mm
- Pin Length: D=3.0mm
- Type: X-R1 ; R2

X6511WR-XXH-C60D30X	PA6T	Brass	X6511F
PART NO	Material	Material(Pin)	Suitable XKB Female

广东星坤科技股份有限公司

ΔX	日期
ΔX	日期
ΔX	日期
MARK	DESCRIPTION
文件	工程章

					ANGLAR	±5°
					L ≤ 4	±0.2
					4 < L ≤ 16	±0.3
					16 < L ≤ 63	±0.4
					L > 63	±0.5
REVISIONS						UNSPECIFIED TOLERANCES



XKB INDUSTRIAL PRECISION CO., LIMITED

DSND		SCALE: N/A	MODEL TYPE:
DWN		VIEW:	2.54mm BTB Connector
CHKD		UNIT: mm/in	PART NO.:
APPD		SIZE: A4	X6511WR-XXH-C60D30X
			DWG NO.:
			X-X6511WR-XXH-C60D30X
WEIGHT	SHEET	REVISION	
	1/1	A0	

## X-ON Electronics

Largest Supplier of Electrical and Electronic Components

*Click to view similar products for [Headers & Wire Housings](#) category:*

*Click to view products by [XKB](#) manufacturer:*

Other Similar products are found below :

[57102-F02-18ULF](#) [58102-G61-06LF](#) [582553-1](#) [009176003701906](#) [01.001.5753.1](#) [0050291907](#) [02.125.8002.8](#) [609-3404](#) [61062-3](#)  
[CSU011177004](#) [622-0430](#) [622-3653LF](#) [63453-116](#) [636-1030](#) [636-1427](#) [636-3427](#) [636-4007](#) [641938-9](#) [644827-2](#) [65495-038](#) [65692-001LF](#)  
[65781-018](#) [65781-047](#) [65817-010LF](#) [65817-015LF](#) [66207-023LF](#) [67095-007LF](#) [67601157](#) [68631-112](#) [68645-018](#) [699319-000](#)  
[M90C108951C](#) [70.362.1628.0](#) [70-4210](#) [70-4226B](#) [70-4853B](#) [707-5028](#) [71.350.2428.0](#) [71961-016LF](#) [733-134](#) [733-162](#) [754199-000](#) [760-](#)  
[3052](#) [80.063.4001.1](#) [800-90-001-10-001000](#) [800-90-010-10-002000](#) [801-43-002-10-013000](#) [801-43-006-10-002000](#) [803-41-018-10-001000](#)  
[803-43-024-10-001000](#)