

Specifications:

- 规格: XKB
Voltage rating: 600V AC/DC
 额定电压: 600V AC/DC
Current rating: 9A AC/DC
 额定电流: 9A AC/DC
Withstanding voltage: 1500V AC/minute
 耐受电压: 1500V AC/分钟
Temperature range: -25°C~+85°C
 温度范围: -25°C~+85°C
Insulation resistance: ≥1000MΩ
 绝缘电阻: ≥1000MΩ
Contact resistance: ≤10mΩ
 接触电阻: ≤10mΩ
After environmental testing: ≤20mΩ
 环境测试后: ≤20兆欧

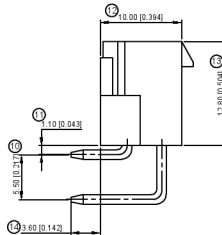
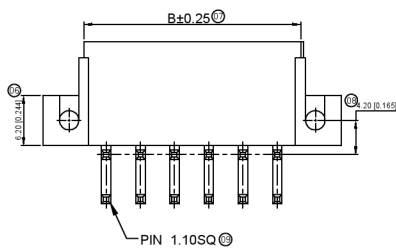

X9357 W R X-2 XX ES -XX SN XX

- 01 Series No
- 02 Category:W-wafer
- 03 Welding Board Angle:R-Right Angle 180°
- 04 Welding Way :Blank-DIP
- 05 Row No.:Pin No.: 2'XX-2'01P-2'12P
- 06 Plug the Pin&Special NO.:
- ES-With Ears and Screw Holes
- 07 Material:NO-PA66 94V-0/N2-PA66 94V-2
- 08 Planting Category:SN-Bright tin plating
- 09 Color:Blank-Natural Color

000100000

Poles	Dimensions(mm)		Poles	Dimensions(mm)	
	A	B		A	B
2*01	—	5.40	2*07	25.20	30.60
2*02	4.20	9.60	2*08	29.40	34.80
2*03	8.40	13.80	2*09	33.60	39.00
2*04	12.60	18.00	2*10	37.80	43.20
2*05	16.80	22.20	2*11	42.00	47.40
2*06	21.00	26.40	2*12	46.20	51.60

000100000

X9357WR-2'XXES-N0SN	Nylon 66 UL 94V-0	Brass	Tin-Plated	X9357H
X9357WR-2'XXES-N2SN	Nylon 66 UL 94V-2	Brass	Tin-Plated	X9357H
PART NO	Material	Material(Pin)	Finish(Pin)	Suitable XKB Terminal

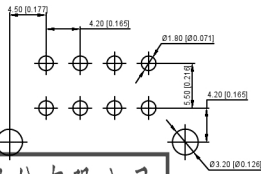

Recommended Pin B Layout
 General Tolerance±0.10

广东星坤科技股份有限公司

生	日期
发	

Δ	文件工程章
MADE IN CHINA	

REVISIONS DATE REVISED APPROVED UNSPECIFIED TOLERANCES

ANGL	±5°
L ≤ 4	±0.2
4 < L ≤ 16	±0.3
16 < L ≤ 63	±0.4
L > 63	±0.5

DSND	DATE	SCALE: N/A	MODEL TYPE: X9357WR-2'XXES-N2SN
DWN	DATE	VIEW: ①	PART NO.: 4.20mm Crimp Style Connector
CHKD	DATE	UNIT: mm/in	DWG NO.:
APPD	DATE	SIZE: A4	
XKB INDUSTRIAL PRECISION CO., LIMITED			WEIGHT: 1.0g
			SHEET: 1/1
			REVISION: A0

X-ON Electronics

Largest Supplier of Electrical and Electronic Components

Click to view similar products for [Headers & Wire Housings](#) category:

Click to view products by [XKB](#) manufacturer:

Other Similar products are found below :

[57102-F02-18ULF](#) [58102-G61-06LF](#) [0009485154](#) [009176003701906](#) [0050291907](#) [00-9021-0611-00-339](#) [02.125.8002.8](#) [609-3404](#) [61062-3](#)
[622-0430](#) [622-3653LF](#) [63453-116](#) [636-1030](#) [636-1427](#) [636-3427](#) [636-4007](#) [641938-9](#) [644827-2](#) [65495-038](#) [65692-001LF](#) [65781-018](#)
[65781-047](#) [65817-010LF](#) [65817-015LF](#) [66207-023LF](#) [67016-026LF](#) [67095-007LF](#) [68631-112](#) [68645-018](#) [68648-049](#) [699319-000](#)
[70.362.1628.0](#) [70-4210](#) [70-4226B](#) [70-4853B](#) [707-5020](#) [707-5028](#) [71.350.2428.0](#) [71961-016LF](#) [733-134](#) [754199-000](#) [760-3052](#) [787-8014-00](#)
[FCN-367T-T012/H](#) [80.063.4001.1](#) [800-90-001-10-001000](#) [800-90-010-10-002000](#) [801-43-002-10-013000](#) [801-43-006-10-002000](#)
[803-41-018-10-001000](#)