

XKB

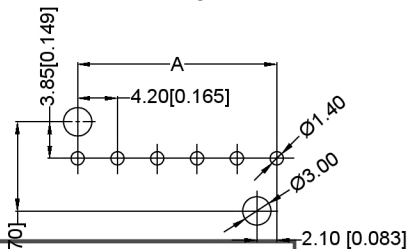

Specifications:

规格: **XKB**  
 Voltage rating: 600V AC/DC  
 额定电压: 600V AC/DC  
 Current rating: 9A AC/DC  
 额定电流: 9A AC/DC  
 Withstanding voltage: 1500V AC/minute  
 耐受电压: 1500V AC/分钟  
 Temperature range: -25°C +85°C  
 温度范围: -25°C +85°C  
 Insulation resistance: ≥1000MΩ  
 绝缘电阻: ≥1000MΩ  
 Contact resistance: ≤10mΩ  
 接触电阻: ≤10mΩ  
 After environmental test fig: ≤20mΩ  
 环境测试后: ≤20mΩ

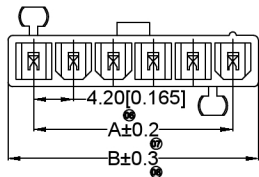
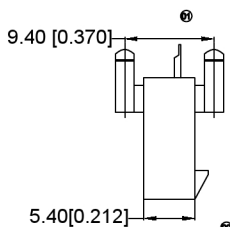
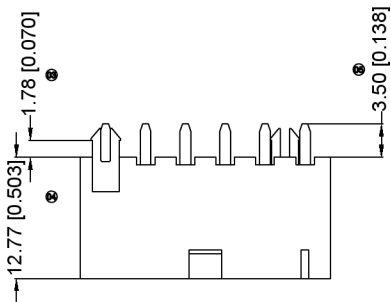
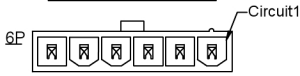
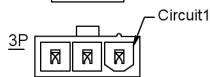
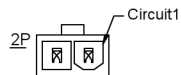

X9357 W V X XX FS XX SN XX

- 01 Series No.
- 02 Category: W-wafer
- 03 Welding Board Angle: V-Straight 180°
- 04 Welding Way: Blank-DIP;
- 05 Row No.-Pin No  
XX-02P-06P
- 06 Plug the Pin&Special No:  
FS-The hollow needle with positioning column
- 07 Material:  
NO-PA66 94V-0;N0-PA66-94V-0  
N2-PA66 94V-2
- 08 Plant Category: SN-Bright tin plating
- 09 Color : Blank-natural color

Poles	Dimensions(mm)	
	A	B
02	4.20	9.60
03	8.40	13.80
04	12.60	18.00
05	16.80	22.20
06	21.00	26.40

X9357WV-XXFS-46SN	Nylon 46 UL 94V-0	Brass	Tin-Plated	X9357H
X9357WV-XXFS-N0SN	Nylon 66 UL 94V-0			
X9357WV-XXFS-N2SN	Nylon 66 UL 94V-2			
PART NO	Material	Material(Pin)	Finish(Pin)	Suitable XKB Terminal

Recommended P.C.B Layout  
 General Tolerance ±0.05

生 日期

文件工程章

REVISIONS

DATE REVISED APPROVED

UNSPECIFIED TOLERANCES

www.heloxkb.com

XKB	DSND	DATE	SCALE: NA	MODEL TYPE: X9357WV-XXFS-XXSN
ANGLAR ±5°	DWN	DATE	VIEW:	PART NO.: 2.40mm Crimp Style Connectors
L ≤ 4 ±0.2	CHKD	DATE	UNIT: mm/in	DWG NO.:
4 < L ≤ 16 ±0.3	APPD	DATE	SIZE: A4	
16 < L ≤ 63 ±0.4				WEIGHT SHEET REVISION 1.0g 1/1 A0
L > 63 ±0.5				

XKB INDUSTRIAL PRECISION CO., LIMITED

## X-ON Electronics

Largest Supplier of Electrical and Electronic Components

*Click to view similar products for [Headers & Wire Housings](#) category:*

*Click to view products by [XKB](#) manufacturer:*

Other Similar products are found below :

[57102-F02-18ULF](#) [58102-G61-06LF](#) [0009485154](#) [009176003701906](#) [0050291907](#) [02.125.8002.8](#) [609-3404](#) [61062-3](#) [622-0430](#) [622-3653LF](#)  
[63453-116](#) [636-1030](#) [636-1427](#) [636-3427](#) [636-4007](#) [641938-9](#) [644827-2](#) [65495-038](#) [65692-001LF](#) [65781-018](#) [65781-047](#) [65817-010LF](#)  
[65817-015LF](#) [66207-023LF](#) [67016-026LF](#) [67095-007LF](#) [68631-112](#) [68645-018](#) [68648-049](#) [699319-000](#) [70.362.1628.0](#) [70-4210](#) [70-4226B](#)  
[70-4853B](#) [707-5020](#) [707-5028](#) [71.350.2428.0](#) [71961-016LF](#) [733-134](#) [754199-000](#) [760-3052](#) [787-8014-00](#) [FCN-367T-T012/H](#) [80.063.4001.1](#)  
[800-90-001-10-001000](#) [800-90-010-10-002000](#) [801-43-002-10-013000](#) [801-43-006-10-002000](#) [803-41-018-10-001000](#) [803-43-014-20-](#)  
[001000](#)