

3 Pin Circuit

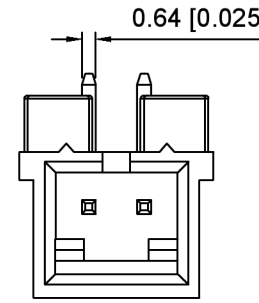

2 Pin Circuit

Specifications:

规格:

- Voltage rating: 250V AC/DC
- 额定电压: 250V AC/DC
- Current rating: 3A AC/DC
- 额定电流: 3A AC/DC
- Withstanding voltage: 1500V AC/minute
- 耐受电压: 1500V AC/分钟
- Temperature range: -25°C~+85°C
- 温度范围: -25°C~+85°C
- Insulation resistance: 1000MΩ min
- 绝缘电阻: 1000MΩ Min
- Contact resistance: 20mΩ Max
- 接触电阻: 20mΩ Max

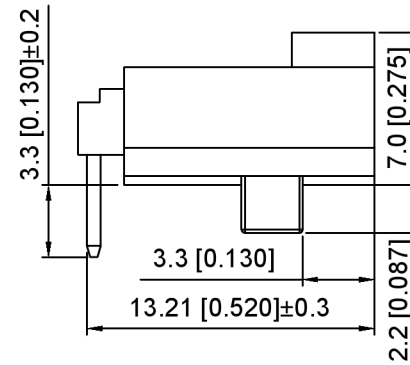
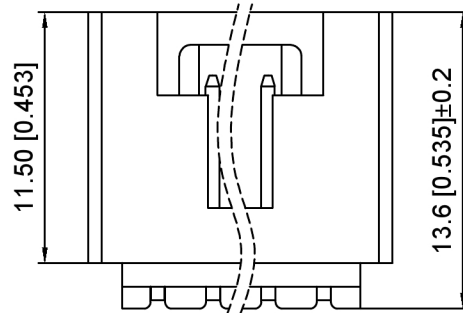

X9556 W R - XX S - 9T V01  
 ① ② ③ ④ ⑤ ⑥ ⑦

- Series No
- Category: W-Wafer
- Welding Board Angle: R-Stright 90°
- Row No. Pin No: XX-02~12P
- Special No: S-With positioning column
- Material: 9T-PA9T UL94V-0 Black
- Plating: V01-Gold Flash

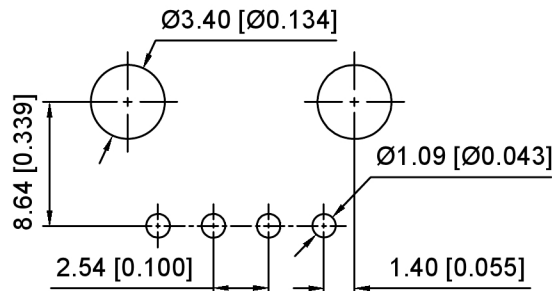

PCB Layout

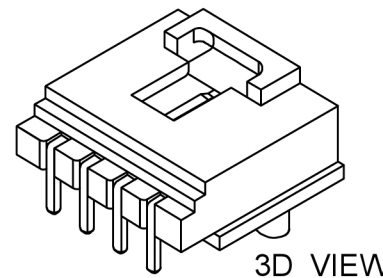

3D VIEW

Poles	Dimensions(mm)			
	A	B	C	D
02	2.54	5.58	8.89	5.33
03	5.08	8.13	11.43	7.87
04	7.62	10.67	13.97	10.41
05	10.16	13.21	16.51	12.95
06	12.70	15.75	19.05	15.49
07	15.24	18.29	21.59	18.03
08	17.78	20.83	24.13	20.57
09	20.32	23.37	26.67	23.11
10	22.86	25.91	29.21	25.65
11	25.40	28.45	31.75	28.19
12	27.94	30.99	34.29	30.73

X9556WR-XXS-9TV01	PA9T	X9635W	X9556H
PART NO	Material	Material(Pin)	Suitable XKB Housing

DSND		SCALE: N/A	MODEL TYPE: 2.54mm Crimp Style Connector
DWN		VIEW:	PART NO.: X9556WR-XXS-9TV01
CHKD		UNIT: mm/in	DWG NO.: X-X9556WR-XXS-9TV01
APPD		SIZE: A4	WEIGHT SHEET REVISION



XKB INDUSTRIAL PRECISION CO., LIMITED

WEIGHT	SHEET	REVISION
	1/1	A0

广东星坤科技股份有限公司

MARK	DESCRIPTION	DATE	REVISED	APPROVED	UNSPECIFIED TOLERANCES
ΔX	日期				ANGLAR ±5°
ΔX	日期				L ≤ 4 ±0.2
ΔX	日期				4 < L ≤ 16 ±0.3
					16 < L ≤ 63 ±0.4
					L > 63 ±0.5

## X-ON Electronics

Largest Supplier of Electrical and Electronic Components

*Click to view similar products for [Headers & Wire Housings](#) category:*

*Click to view products by [XKB](#) manufacturer:*

Other Similar products are found below :

[57102-F02-18ULF](#) [58102-G61-06LF](#) [582553-1](#) [009176003701906](#) [01.001.5753.1](#) [0050291907](#) [02.125.8002.8](#) [609-3404](#) [61062-3](#)  
[CSU011177004](#) [622-0430](#) [622-3653LF](#) [63453-116](#) [636-1030](#) [636-1427](#) [636-3427](#) [636-4007](#) [641938-9](#) [644827-2](#) [65495-038](#) [65692-001LF](#)  
[65781-018](#) [65781-047](#) [65817-010LF](#) [65817-015LF](#) [66207-023LF](#) [67095-007LF](#) [67601157](#) [68631-112](#) [68645-018](#) [699319-000](#)  
[M90C108951C](#) [70.362.1628.0](#) [70-4210](#) [70-4226B](#) [70-4853B](#) [707-5028](#) [71.350.2428.0](#) [71961-016LF](#) [733-134](#) [733-162](#) [754199-000](#) [760-](#)  
[3052](#) [80.063.4001.1](#) [800-90-001-10-001000](#) [800-90-010-10-002000](#) [801-43-002-10-013000](#) [801-43-006-10-002000](#) [803-41-018-10-001000](#)  
[803-43-024-10-001000](#)