

For and on behalf of
XKB INDUSTRIAL PRECISION CO., LIMITED
 香港星坤工業精密有限公司

| MARK | DESCRIPTION | DATE | REVISD | APPROVED | UNSPECIFIED TOLERANCES |
|------|-------------|------|--------|----------|------------------------|
| △ X | | | | | L > 63 ± 0.5 |
| △ X | | | | | 16 < L ≤ 63 ± 0.4 |
| △ X | | | | | 4 < L ≤ 16 ± 0.3 |
| | | | | | L ≤ 4 ± 0.2 |
| | | | | | ANGULAR ± 5° |

| REVISIONS | XKB INDUSTRIAL PRECISION CO., LIMITED | |
|-----------|---|--------------|
| DATE | SIZE: A4 | WEIGHT: 1.0g |
| APPROVED | DATE | SHEET: 1/1 |
| REVISED | DATE | REVISION: A0 |
| DATE | UNIT: mm | |
| | VIEW: | |
| | SCALE: N/A | |
| | MODEL TYPE: X9556WRS-XXX-4TSW | |
| | PART NO.: X9556WRS-XXX-XXXX | |
| | DWG NO.: 2.54 mm Crimp Style Connectors | |

| PART NO | Material | Material(Pin) | Finish(Pin) | Suitable XKB Terminal |
|--------------------|----------------|---------------|-------------|-----------------------|
| X9556WRS-XX-9TV01 | LCP UL 94V-0 | Brass | Gold-Flash | X9556H |
| X9556WRS-XXA-9TV01 | | | | |
| X9556WRS-XXX-9TSW | | | | |
| X9556WRS-XXX-4TSW | Nylon 4T 94V-0 | | Mate tin | |

| Poles | Dimensions (mm) | | | | Poles | Dimensions (mm) | | | |
|-------|-----------------|-------|-------|-------|-------|-----------------|-------|-------|-------|
| | A | B | C | D | | A | B | C | D |
| 07 | 15.24 | 18.30 | 21.57 | 18.03 | | | | | |
| 06 | 12.70 | 15.76 | 19.03 | 15.49 | 12 | 27.94 | 31.00 | 34.27 | 30.73 |
| 05 | 10.16 | 13.22 | 16.49 | 12.95 | 11 | 25.40 | 28.46 | 31.73 | 28.19 |
| 04 | 7.62 | 10.68 | 13.95 | 10.41 | 10 | 22.86 | 25.92 | 29.19 | 25.65 |
| 03 | 5.08 | 8.14 | 11.41 | 7.87 | 09 | 20.32 | 23.38 | 26.65 | 23.11 |
| 02 | 2.54 | 5.60 | 8.87 | 5.33 | 08 | 17.78 | 20.84 | 24.11 | 20.57 |

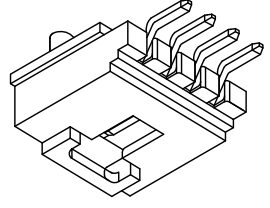

P.C.B LAYOUT

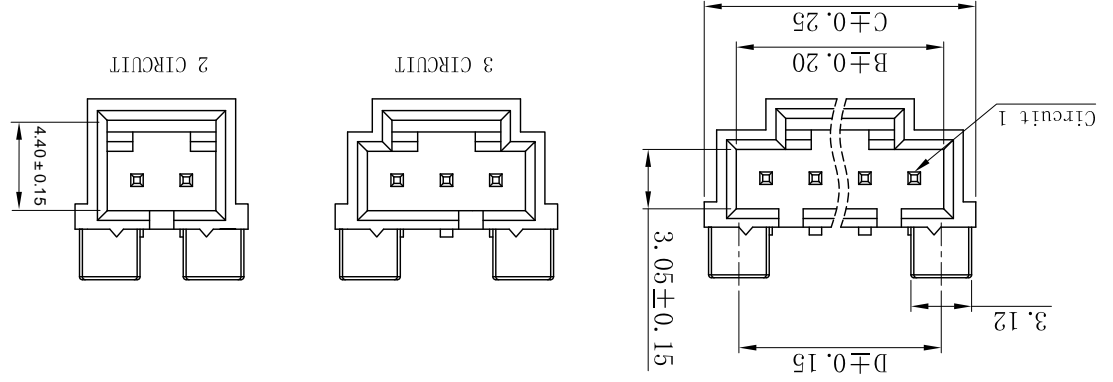
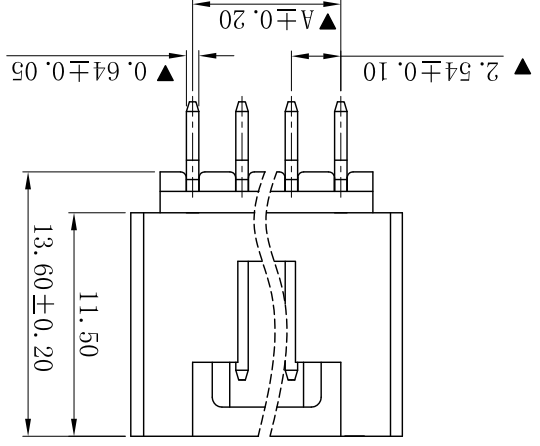
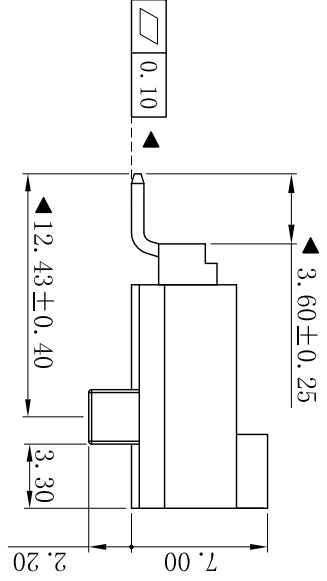
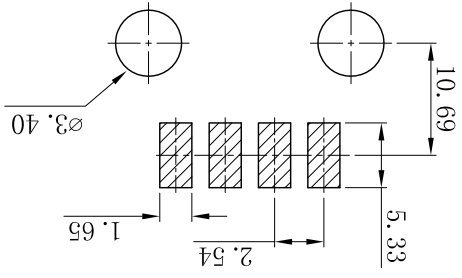

- Specifications :
- Voltage rating: 250V AC / DC
 - Current rating: 3A AC / DC
 - Withstanding voltage: 1500V AC/minute
 - Temperature range: -40°C~+105°C
 - Insulation resistance: ≥1000M Ω /E
 - Contact resistance: ≤20m Ω /E
 - After environmental testing: ≤30m Ω /E

X9556 W R S-XX-XX 9T XX XX
 ① Series No.
 ② Category: W-water
 ③ Welding Board Angle: R-90°
 ④ Welding Way: S-SMT
 ⑤ Row No.-Pin No.: XX-Single row
 ⑥ Special NO. Blank: W=2.7 A: W=3.12
 ⑦ Material: LP-LCP 94V-0 4T-Nylon 4T 94V-0
 ⑧ Plating Category:
 V**:All Gold-Plated *01-Gold Flash
 SW-Matte Tin plating
 ⑨ Color:
 Blank-Natural Color Black

X-ON Electronics

Largest Supplier of Electrical and Electronic Components

Click to view similar products for [Headers & Wire Housings](#) category:

Click to view products by [XKB](#) manufacturer:

Other Similar products are found below :

[95000-104TRLF](#) [10135584-644402LF](#) [DF62W-EP2022PCA](#) [95000-106TRLF](#) [DF62W-2022SCA](#) [DF62W-EP2022PC](#) [2203348](#) [DF62W-2022SC](#) [1084018](#) [1029039](#) [1084017](#) [802-10-012-10-002000](#) [1112640](#) [1112639](#) [891-007-9SS-BST1T](#) [000-34000](#) [0008550134](#) [0009482033](#) [0009507031](#) [57102-F02-18ULF](#) [57102-S06-03LF](#) [57202-S52-04LF](#) [PCN6-15S-2.5E](#) [0039019024](#) [58102-G61-06LF](#) [582553-1](#) [0009485154](#) [0009508121](#) [0022285053](#) [0050291907](#) [018731A](#) [LY20-4P-DT1-P1E-BR](#) [02.125.8002.8](#) [60101931](#) [60598-1 \(Cut Strip\)](#) [M1625-3R/100](#) [61062-3](#) [61082-181009](#) [CSU011177004](#) [636-1427](#) [638009-1](#) [641938-9](#) [641991-4](#) [644168-1](#) [644827-2](#) [647662-1](#) [65039-019ELF](#) [65692-001LF](#) [65781-018](#) [65781-047](#)