

|      |              |      |         |
|------|--------------|------|---------|
| 12   | 13           | 14   | 15      |
| MAPX | MODIFICATION | DATE | APPROVE |
|      |              |      |         |

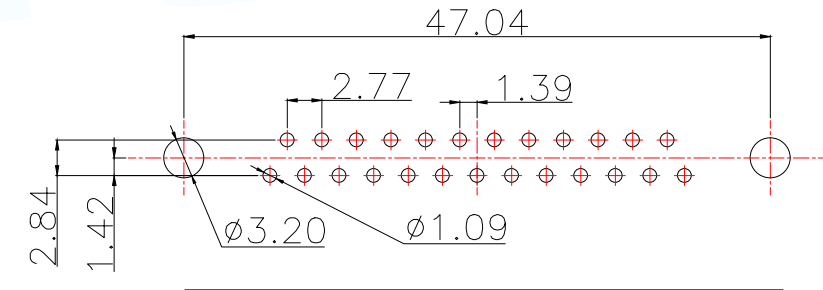
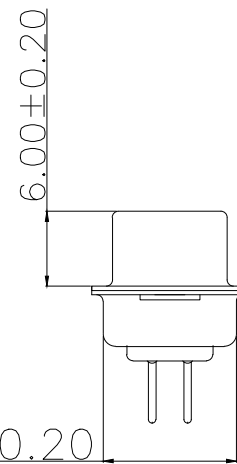
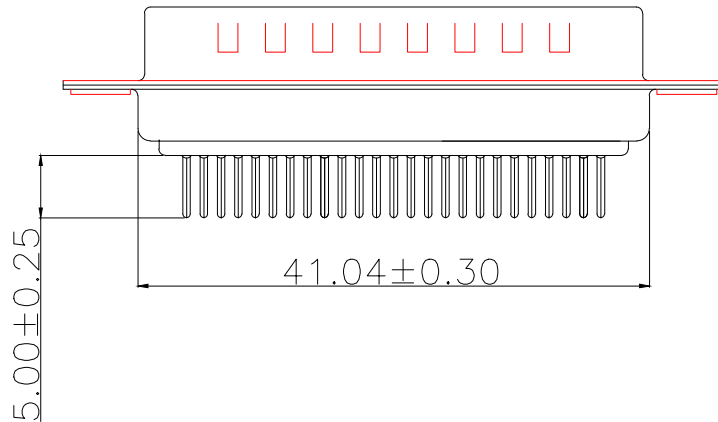
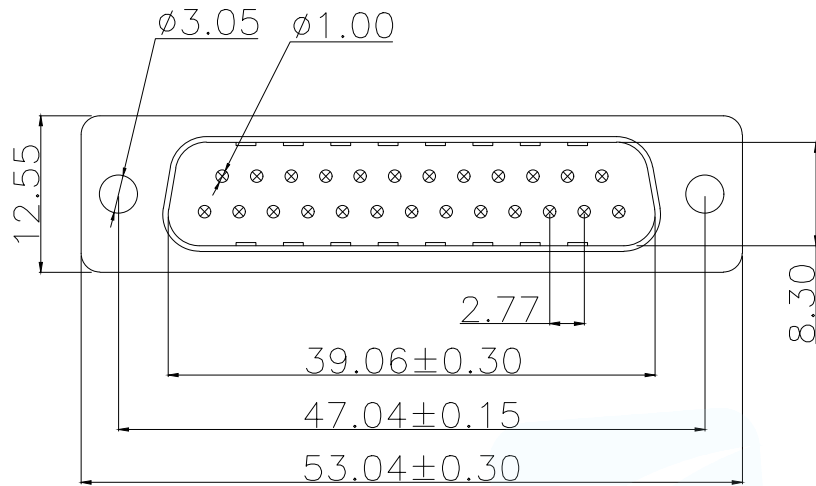

RECOMMEND PCB LAYOUT (T=1.6)  
PCB TOLERANCE: ±0.05

一、 MATERIAL:

1. Insulator: PBT+30% Glass Fiber
2. Contact: Brass
3. Contact Plated: Gold Flash over Tin Or Gold Plated Or Tin Plated
4. Shell: Steel, Nickel Plated

二、 SPECIFICATION:

1. Current Rating: 3 AMPS
2. Insulation Resistance: 100MΩ MIN. At 500VDC
3. Dielectric Strength: 500V for One minute
4. Operation Temperature: -55° C~+105° C.

\*【胶芯颜色、防火要求、环保要求及电镀规格 依据客户实际订单要求为准】

|                                       |          |   |                          |
|---------------------------------------|----------|---|--------------------------|
| MANUFACTURE DWG                       |          |  东莞市讯普电子科技有限公司<br>DongGuan XunPu Electronics Co.,Ltd |                          |
| UNLESS OTHERWISE SPECIFIED TOLERANCES |          |    | TITLE:<br>DP-25M 侧壳      |
| DECIMALS:                             | ANGLES:  |   | PAR<br>D-SUB-DP-25PHG-AB |
| X.X±0.30                              | X.*±5°   |   | DWN                      |
| X.XX±0.25                             | X.X°±2°  |   | CHKD                     |
| X.XXX±0.15                            | X.XX°±1° | APVD  | SCALE N:A                |
| CUSTOMER COPY                         |          | SIZE:A4   | UNIT:MM                  |
|                                       |          | SHEET:1F1   | REV:A                    |

## X-ON Electronics

Largest Supplier of Electrical and Electronic Components

*Click to view similar products for [D-Sub Standard Connectors](#) category:*

*Click to view products by [XUNPU](#) manufacturer:*

Other Similar products are found below :

[015-0339-000](#) [015-0341-000](#) [015-0349-000](#) [015-0350-000](#) [015-8544-011](#) [015-8755-001](#) [017041-0005](#) [020419-0104](#) [609-25P](#) [609-9P](#)  
[M24308/2-23Z](#) [CT0-24-10SC](#) [CT0-36-3PC](#) [CT0E20-8PS](#) [CT0F16S-1PS](#) [CT0TA16-11SXCA232](#) [CT1E20-19SS](#) [CT2-10SL-3SC](#) [CT2-14S-2PCA34](#) [CT2-18-11PCAU](#) [CT2-22-19SC](#) [CT2-36-5PC](#) [CT6-10SL-3SC](#) [CT6-10SL-4SC](#) [CT6-14S-2SC](#) [CT6-16-12SC](#) [CT6-18-10PSA206](#)  
[CT6-18-10PSA232](#) [CT6-18-11PXSA206](#) [CT6-18-11PXSA232](#) [CT6-22-10PS](#) [CT6-24-5PC](#) [CT6-9767-18-8-18-4SS](#) [CT6E14S-5SC](#)  
[CT6E14SA7SC](#) [CT6E20-14SS](#) [CT6E22-14PC](#) [CT6E22-14PS](#) [CT6E22-19PS](#) [CT6E22-22PS](#) [CT6E24-10SC](#) [CT6F16S-1SC](#) [CT6FA10SL-4PS](#)  
[CT6LA20-19PC](#) [CT6M20-19SS](#) [CT6NSB4-20-8SS](#) [CT6TC14S-6SCAU](#) [CT6TC14S-7PS](#) [6STD15SCT99S40X](#) [6STF09PCM05B70X](#)