

|    |                    |                         |         |       |    |
|----|--------------------|-------------------------|---------|-------|----|
| 4  | FPC 0.5mm间距—焊片     | PhosphorBronze T=0.20MM | 镀锡      | 2 PCS |    |
| 3  | FPC 0.5mm间距—锁扣(窄扣) | LCP/PPS                 | 黑色      | 1 PCS |    |
| 2  | FPC 0.5mm间距卧贴—PIN  | PhosphorBronze T=0.20MM | 镀锡/全金   | N PCS |    |
| 1  | FPC 0.5mm间距卧贴—基座   | LCP/PA46/PPS            | 米色      | 1 PCS |    |
| 序号 | 品名                 | 材料规格                    | 电镀方式/颜色 | 使用数量  | 备注 |

| Part No            | Pin | A     | B     | C     |
|--------------------|-----|-------|-------|-------|
| FPC-0.5AX-4PWBH20  | 4   | 1.50  | 7.70  | 2.56  |
| FPC-0.5AX-5PWBH20  | 5   | 2.00  | 8.20  | 3.06  |
| FPC-0.5AX-6PWBH20  | 6   | 2.50  | 8.70  | 3.56  |
| FPC-0.5AX-7PWBH20  | 7   | 3.00  | 9.20  | 4.06  |
| FPC-0.5AX-8PWBH20  | 8   | 3.50  | 9.70  | 4.56  |
| FPC-0.5AX-9PWBH20  | 9   | 4.00  | 10.20 | 5.06  |
| FPC-0.5AX-10PWBH20 | 10  | 4.50  | 10.70 | 5.56  |
| FPC-0.5AX-11PWBH20 | 11  | 5.00  | 11.20 | 6.06  |
| FPC-0.5AX-12PWBH20 | 12  | 5.50  | 11.70 | 6.56  |
| FPC-0.5AX-13PWBH20 | 13  | 6.00  | 12.20 | 7.06  |
| FPC-0.5AX-14PWBH20 | 14  | 6.50  | 12.70 | 7.56  |
| FPC-0.5AX-15PWBH20 | 15  | 7.00  | 13.20 | 8.06  |
| FPC-0.5AX-16PWBH20 | 16  | 7.50  | 13.70 | 8.56  |
| FPC-0.5AX-17PWBH20 | 17  | 8.00  | 14.20 | 9.06  |
| FPC-0.5AX-18PWBH20 | 18  | 8.50  | 14.70 | 9.56  |
| FPC-0.5AX-19PWBH20 | 19  | 9.00  | 15.20 | 10.06 |
| FPC-0.5AX-20PWBH20 | 20  | 9.50  | 15.70 | 10.56 |
| FPC-0.5AX-21PWBH20 | 21  | 10.00 | 16.20 | 11.06 |
| FPC-0.5AX-22PWBH20 | 22  | 10.50 | 16.70 | 11.56 |
| FPC-0.5AX-23PWBH20 | 23  | 11.00 | 17.20 | 12.06 |
| FPC-0.5AX-24PWBH20 | 24  | 11.50 | 17.70 | 12.56 |
| FPC-0.5AX-25PWBH20 | 25  | 12.00 | 18.20 | 13.06 |
| FPC-0.5AX-26PWBH20 | 26  | 12.50 | 18.70 | 13.56 |
| FPC-0.5AX-27PWBH20 | 27  | 13.00 | 19.20 | 14.06 |
| FPC-0.5AX-28PWBH20 | 28  | 13.50 | 19.70 | 14.56 |
| FPC-0.5AX-29PWBH20 | 29  | 14.00 | 20.20 | 15.06 |
| FPC-0.5AX-30PWBH20 | 30  | 14.50 | 20.70 | 15.56 |
| FPC-0.5AX-31PWBH20 | 31  | 15.00 | 21.20 | 16.06 |
| FPC-0.5AX-32PWBH20 | 32  | 15.50 | 21.70 | 16.56 |
| FPC-0.5AX-33PWBH20 | 33  | 16.00 | 22.20 | 17.06 |
| FPC-0.5AX-34PWBH20 | 34  | 16.50 | 22.70 | 17.56 |
| FPC-0.5AX-35PWBH20 | 35  | 17.00 | 23.20 | 18.06 |

NOTES:

- 额定电流 Current rating: 0.5A
- 额定电压 Voltage rating: 50V
- 耐电压 Withstand voltage: 500V AC/minute
- 接触电阻 Contact resistance :≤40mΩ
- 绝缘电阻 Insulation resistance: 100MΩ MIN
- 工作温度 Working temperature: -25℃ ~ +85℃

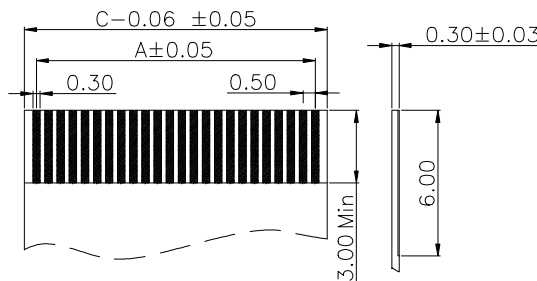
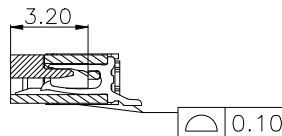
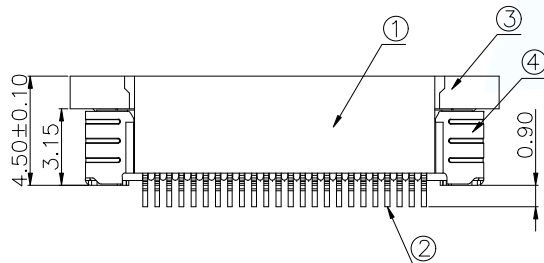
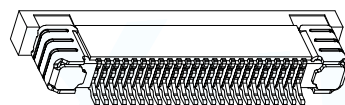
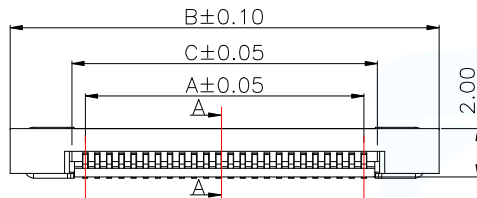
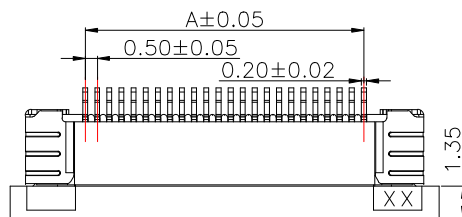

通用FFC寸法  
Applicable FFC

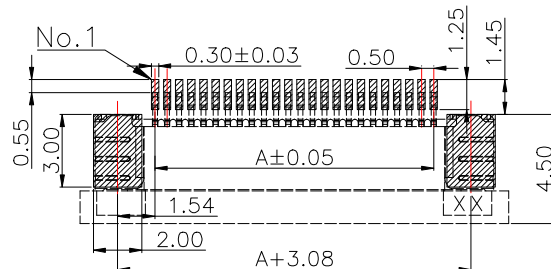

PCB 寸法  
PCB Layout

|                                       |           |          |   |       |
|---------------------------------------|-----------|----------|---|-------|
| MANUFACTURE DWG                       |           |          | 东莞市讯普电子科技有限公司<br>DongGuan XunPu Electronics Co.,Ltd |       |
| UNLESS OTHERWISE SPECIFIED TOLERANCES |           |          | TITLE:FPC 0.5mm间距 卧式贴片下接 Connector(窄扣)              |       |
| DECIMALS:                             | ANGLES:   | PAR      | FPC-0.5AX-NPWBH20                                   |       |
| .X:±0.38                              | .X':±5°   | DWN      |   |       |
| .XX:±0.20                             | .XX':±3°  | CHKD     |   |       |
| .XXX:±0.05                            | .XXX':±1° | APVD     |   |       |
| CUSTOMER COPY                         |           | SCALE1:1 | UNIT:MM   |       |
|                                       |           | SIZE:A4  | SHEET:1F1   | REV:A |

|    |                    |                         |         |       |    |
|----|--------------------|-------------------------|---------|-------|----|
| 4  | FPC 0.5mm间距—焊片     | PhosphorBronze T=0.20MM | 镀锡      | 2 PCS |    |
| 3  | FPC 0.5mm间距—锁扣(窄扣) | LCP/PPS                 | 黑色      | 1 PCS |    |
| 2  | FPC 0.5mm间距贴片—PIN  | PhosphorBronze T=0.20MM | 镀锡/全金   | N PCS |    |
| 1  | FPC 0.5mm间距贴片—基座   | LCP/PA46/PPS            | 米色      | 1 PCS |    |
| 序号 | 品名                 | 材料规格                    | 电镀方式/颜色 | 使用数量  | 备注 |

| Part No            | Pin | A     | B     | C     |
|--------------------|-----|-------|-------|-------|
| FPC-0.5AX-36PWBH20 | 36  | 17.50 | 23.70 | 18.56 |
| FPC-0.5AX-37PWBH20 | 37  | 18.00 | 24.20 | 19.06 |
| FPC-0.5AX-38PWBH20 | 38  | 18.50 | 24.70 | 19.56 |
| FPC-0.5AX-39PWBH20 | 39  | 19.00 | 25.20 | 20.06 |
| FPC-0.5AX-40PWBH20 | 40  | 19.50 | 25.70 | 20.56 |
| FPC-0.5AX-41PWBH20 | 41  | 20.00 | 26.20 | 21.06 |
| FPC-0.5AX-42PWBH20 | 42  | 20.50 | 26.70 | 21.56 |
| FPC-0.5AX-43PWBH20 | 43  | 21.00 | 27.20 | 22.06 |
| FPC-0.5AX-44PWBH20 | 44  | 21.50 | 27.70 | 22.56 |
| FPC-0.5AX-45PWBH20 | 45  | 22.00 | 28.20 | 23.06 |
| FPC-0.5AX-46PWBH20 | 46  | 22.50 | 28.70 | 23.56 |
| FPC-0.5AX-47PWBH20 | 47  | 23.00 | 29.20 | 24.06 |
| FPC-0.5AX-48PWBH20 | 48  | 23.50 | 29.70 | 24.56 |
| FPC-0.5AX-49PWBH20 | 49  | 24.00 | 30.20 | 25.06 |
| FPC-0.5AX-50PWBH20 | 50  | 24.50 | 30.70 | 25.56 |
| FPC-0.5AX-51PWBH20 | 51  | 25.00 | 31.20 | 26.06 |
| FPC-0.5AX-52PWBH20 | 52  | 25.50 | 31.70 | 26.56 |
| FPC-0.5AX-53PWBH20 | 53  | 26.00 | 32.20 | 27.06 |
| FPC-0.5AX-54PWBH20 | 54  | 26.50 | 32.70 | 27.56 |
| FPC-0.5AX-55PWBH20 | 55  | 27.00 | 33.20 | 28.06 |
| FPC-0.5AX-56PWBH20 | 56  | 27.50 | 33.70 | 28.56 |
| FPC-0.5AX-57PWBH20 | 57  | 28.00 | 34.20 | 29.06 |
| FPC-0.5AX-58PWBH20 | 58  | 28.50 | 34.70 | 29.56 |
| FPC-0.5AX-59PWBH20 | 59  | 29.00 | 35.20 | 30.06 |
| FPC-0.5AX-60PWBH20 | 60  | 29.50 | 35.70 | 30.56 |

NOTES:  
 额定电流 Current rating: 0.5A  
 额定电压 Voltage rating: 50V  
 耐电压 Withstand voltage: 500V AC/minute  
 接触电阻 Contact resistance: ≤40mΩ  
 绝缘电阻 Insulation resistance: 100MΩ MIN  
 工作温度 Working temperature: -25℃ ~ +85℃

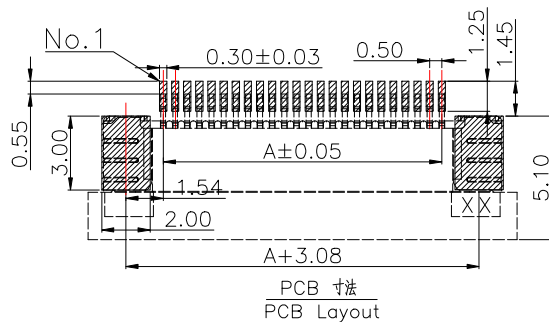
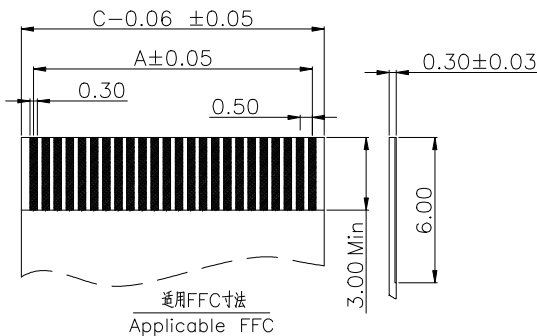
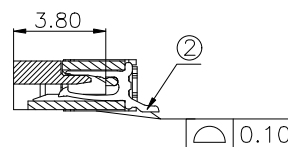
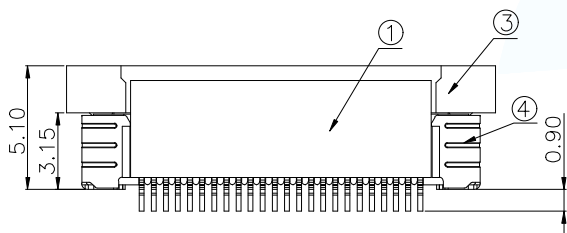
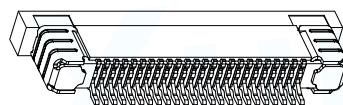
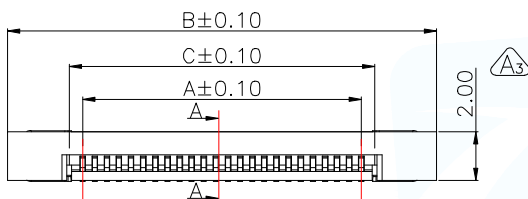
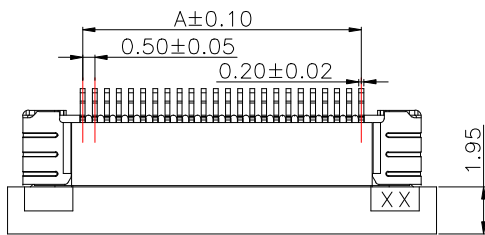

|                                       |           |          |   |       |
|---------------------------------------|-----------|----------|---|-------|
| MANUFACTURE DWG                       |           |          | 东莞市讯普电子科技有限公司<br>DongGuan XunPu Electronics Co.,Ltd |       |
| UNLESS OTHERWISE SPECIFIED TOLERANCES |           |          | TITLE:FPC 0.5mm间距 卧式贴片下接 Connector(宽扣)              |       |
| DECIMALS:                             | ANGLES:   | PAR      | FPC-0.5AX-NPWBH20                                   |       |
| .X:±0.38                              | .X':±5°   | DWN      |   |       |
| .XX:±0.20                             | .XX':±3°  | CHKD     |   |       |
| .XXX:±0.05                            | .XXX':±1° | APVD     |   |       |
| CUSTOMER COPY                         |           | SCALE1:1 | UNIT:MM   |       |
|                                       |           | SIZE:A4  | SHEET:1F1   | REV:A |

## X-ON Electronics

Largest Supplier of Electrical and Electronic Components

*Click to view similar products for [FFC & FPC Connectors](#) category:*

*Click to view products by [XUNPU](#) manufacturer:*

Other Similar products are found below :

[00-6200-227-022-800](#) [006205250500825+](#) [006205280500825+](#) [FPH-1602G](#) [086222026001800](#) [52610-0675](#) [62674-201121DLF](#) [52746-1671-TR250](#) [10051922-1610EHLF](#) [10051922-2810EHLF](#) [686322124422](#) [XF3M-2915-1B-R100](#) [AYF353125A](#) [AYF530665TA](#) [AYF534065TA](#) [20FLH-RSM1-TB](#) [207356-1](#) [SFW12R-5STE9LF](#) [SFW18R-1STAE9LF](#) [SFW4R-5STE9LF](#) [52807-0430](#) [046283021002868+](#) [FFC05011-10SBB114W5M](#) [502250-8027](#) [67000-008LF](#) [200528-0260](#) [FH28K-10S-0.5SH](#) [FH52K-6S-0.5SH](#) [0.5K-DX-30PWB](#) [DS1020-08-10VBT12](#) [THD0515-34CL-GF](#) [X05A10L28G](#) [ECC2841061EU](#) [1.0K-DHQX-16PWB](#) [1.0K-DHQX-30PWB](#) [1775333-6](#) [10054365-202110ELF](#) [10054365-242110ELF](#) [10054365-282110ELF](#) [10064555-392220HLF](#) [59453-041110EBHLF](#) [59453-091110EDHLF](#) [62674-241141ALF](#) [62684-432100ALF](#) [62684-451100AHLF](#) [62684-5721N0ALF](#) [HFW11R-1STE1MTLF](#) [HFW12R-1STE9LF](#) [HFW14R-1STE9MTLF](#) [HFW18S-2STE9LF](#)