

**SPECIFICATIONS**  
 Current Rating:0.75 Amps  
 Withstanding Voltage:AC 500V  
 Insulation Resistance:1000MΩ Min  
 Contact Resistance:20mΩ Max  
 Operation Temperature:-40°to+105°  
 Insrlator Material:Polyester(UL94V-0)  
 Contact Material:Phosphor bronze  
 Standard:PA6T  
 Contact Plating:Gold Flash  
 Max.Processing Temp:240°C for30-60seconds  
 (260°C for5seconds)

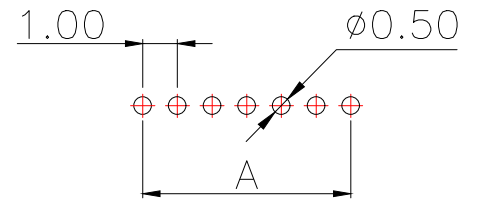
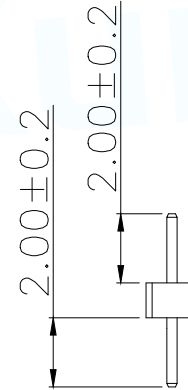
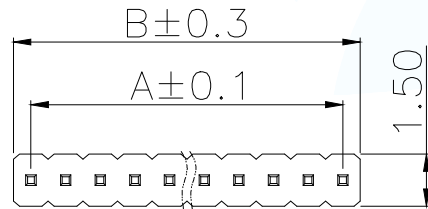

RECOMMEND P.C.B LAYOUT  
 PCB TOLERANCE:±0.05 (TOP VIEW)

P/N	PIN	DIM.A	DIM.B
PH1.0-01-01PZD	1	0.00	1.0
PH1.0-01-02PZD	2	1.0	2.00
PH1.0-01-03PZD	3	2.00	3.00
PH1.0-01-04PZD	4	3.00	4.00
PH1.0-01-05PZD	5	4.00	5.00
PH1.0-01-06PZD	6	5.00	6.00
PH1.0-01-07PZD	7	6.00	7.00
PH1.0-01-08PZD	8	7.00	8.00
PH1.0-01-09PZD	9	8.00	9.00
.....	.....	.....	.....
PH1.0-01-50PZD	50	(PIN-1)	(PIN)

PART NUMBER DESCRIPTION:

PH1.0-01-NPZD

- (D=单排;S=双排)
- (Z=直脚;W=弯脚)
- (PIN数量;01.....50PIN)
- (排针开关)

MANUFACTURE DWG		东莞市讯普电子科技有限公司 DongGuan XunPu Electronics Co.,Ltd		
UNLESS OTHERWISE SPECIFIED TOLERANCES			TITLE:1.0PH H1.0 1xPin 180度 W1.5 PC2.0 PA2.0 PB1.0 L5.0 6T	
DECIMALS:	ANGLES:		PAR PH1.0-01-NPZD	
X.±0.30	X°±5'		DWN	
X.X±0.20	X.X°±1'		CHKD	
X.XX±0.10	X.XX°±0.5'	APVD		
CUSTOMER COPY		SCALE N:A	UNIT:MM	
		SIZE:A4	SHEET:1F1	
			REV:A	

## X-ON Electronics

Largest Supplier of Electrical and Electronic Components

*Click to view similar products for [Headers & Wire Housings](#) category:*

*Click to view products by [XUNPU](#) manufacturer:*

Other Similar products are found below :

[0015917161](#) [0022155065](#) [57102-F02-18ULF](#) [58102-G61-06LF](#) [582553-1](#) [01.001.5753.1](#) [0050291907](#) [02.125.8002.8](#) [609-3404](#) [61062-3](#)  
[CSU011177004](#) [622-0430](#) [622-3653LF](#) [63453-116](#) [636-1030](#) [636-1427](#) [636-3427](#) [636-4007](#) [641938-9](#) [65495-038](#) [65692-001LF](#) [65781-018](#)  
[65781-047](#) [65817-010LF](#) [65817-015LF](#) [67095-007LF](#) [67601157](#) [68631-112](#) [699319-000](#) [70.362.1628.0](#) [70-4210](#) [70-4226B](#) [70-4853B](#) [707-](#)  
[5028](#) [71.350.2428.0](#) [733-134](#) [733-162](#) [760-3052](#) [MHR-64-VUAL](#) [80.063.4001.1](#) [800-90-001-10-001000](#) [801-43-002-10-013000](#)  
[801-43-006-10-002000](#) [803-43-024-10-001000](#) [803-93-012-10-001000](#) [8-1437020-4](#) [819-22-004-30-001101](#) [820-22-006-30-001101](#)  
[820-22-008-30-001101](#) [821-22-002-10-001101](#)