

**SPECIFICATIONS**  
 Current Rating:0.75 Amps  
 Withstanding Voltage:AC 500V  
 Insulation Resistance:1000MΩ Min  
 Contact Resistance:20mΩ Max  
 Operation Temperature:-40°to+105°  
 Insrlator Material:Polyester(UL94V-0)  
 Contact Material:Phosphor bronze  
 Standard:PA6T  
 Contact Plating:Gold Flash  
 Max.Processing Temp:240°C for30-60seconds  
 (260°C for5seconds)

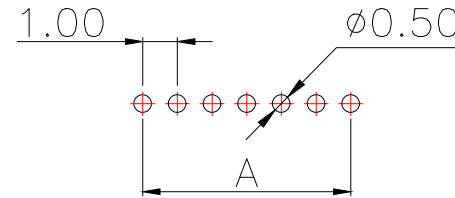
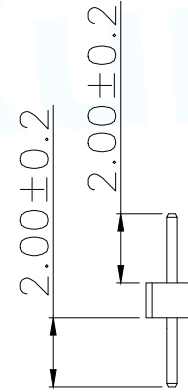
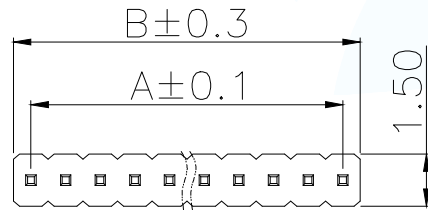

RECOMMEND P.C.B LAYOUT  
 PCB TOLERANCE:±0.05 (TOP VIEW)

| P/N            | PIN   | DIM.A   | DIM.B |
|----------------|-------|---------|-------|
| PH1.0-01-01PZD | 1     | 0.00    | 1.0   |
| PH1.0-01-02PZD | 2     | 1.0     | 2.00  |
| PH1.0-01-03PZD | 3     | 2.00    | 3.00  |
| PH1.0-01-04PZD | 4     | 3.00    | 4.00  |
| PH1.0-01-05PZD | 5     | 4.00    | 5.00  |
| PH1.0-01-06PZD | 6     | 5.00    | 6.00  |
| PH1.0-01-07PZD | 7     | 6.00    | 7.00  |
| PH1.0-01-08PZD | 8     | 7.00    | 8.00  |
| PH1.0-01-09PZD | 9     | 8.00    | 9.00  |
| .....          | ..... | .....   | ..... |
| PH1.0-01-50PZD | 50    | (PIN-1) | (PIN) |

PART NUMBER DESCRIPTION:

PH1.0-01-NPZD

- (D=单排;S=双排)
- (Z=直脚;W=弯脚)
- (PIN数量;01.....50PIN)
- (排针开关)

|                                       |            |                                                     |                                                             |  |
|---------------------------------------|------------|-----------------------------------------------------|-------------------------------------------------------------|--|
| MANUFACTURE DWG                       |            | 东莞市讯普电子科技有限公司<br>DongGuan XunPu Electronics Co.,Ltd |                                                             |  |
| UNLESS OTHERWISE SPECIFIED TOLERANCES |            |                                                     | TITLE:1.0PH H1.0 1xnPin 180度 W1.5 PC2.0 PA2.0 PB1.0 L5.0 6T |  |
| DECIMALS:                             | ANGLES:    |                                                     | PAR PH1.0-01-NPZD                                           |  |
| X.±0.30                               | X°±5'      |                                                     | DWN                                                         |  |
| X.X±0.20                              | X.X°±1'    |                                                     | CHKD                                                        |  |
| X.XX±0.10                             | X.XX°±0.5' | APVD                                                |                                                             |  |
| CUSTOMER COPY                         |            | SCALE N:A                                           | UNIT:MM                                                     |  |
|                                       |            | SIZE:A4                                             | SHEET:1F1                                                   |  |
|                                       |            |                                                     | REV:A                                                       |  |

## X-ON Electronics

Largest Supplier of Electrical and Electronic Components

*Click to view similar products for [Headers & Wire Housings](#) category:*

*Click to view products by [XUNPU](#) manufacturer:*

Other Similar products are found below :

[0015917161](#) [0022155065](#) [57102-F02-18ULF](#) [58102-G61-06LF](#) [582553-1](#) [01.001.5753.1](#) [0050291907](#) [02.125.8002.8](#) [609-3404](#) [61062-3](#)  
[CSU011177004](#) [622-0430](#) [622-3653LF](#) [63453-116](#) [636-1030](#) [636-1427](#) [636-3427](#) [636-4007](#) [641938-9](#) [65495-038](#) [65692-001LF](#) [65781-018](#)  
[65781-047](#) [65817-010LF](#) [65817-015LF](#) [67095-007LF](#) [67601157](#) [68631-112](#) [699319-000](#) [70.362.1628.0](#) [70-4210](#) [70-4226B](#) [70-4853B](#) [707-](#)  
[5028](#) [71.350.2428.0](#) [733-134](#) [733-162](#) [760-3052](#) [MHR-64-VUAL](#) [80.063.4001.1](#) [800-90-001-10-001000](#) [801-43-002-10-013000](#)  
[801-43-006-10-002000](#) [803-43-024-10-001000](#) [803-93-012-10-001000](#) [8-1437020-4](#) [819-22-004-30-001101](#) [820-22-006-30-001101](#)  
[820-22-008-30-001101](#) [821-22-002-10-001101](#)