

Technical Index:
 1. Temperature range: $-25^{\circ}\text{C}\sim 85^{\circ}\text{C}$.
 2. Rated voltage: 200V DC/AC(rms).
 3. Rated current: 2.0A.
 4. Contact resistance: $\leq 25\text{m}\Omega$.
 5. Withstanding voltage: 500V AC/minute.
 6. Insulation resistance: $\geq 1000\text{M}\Omega$.

| Part No | Pin | A | B |
|-----------------------|-----|-------|-------|
| WAFER-PH2.0-2PWZ-R62 | 2 | 2.00 | 6.00 |
| WAFER-PH2.0-3PWZ-R62 | 3 | 4.00 | 8.00 |
| WAFER-PH2.0-4PWZ-R62 | 4 | 6.00 | 10.00 |
| WAFER-PH2.0-5PWZ-R62 | 5 | 8.00 | 12.00 |
| WAFER-PH2.0-6PWZ-R62 | 6 | 10.00 | 14.00 |
| WAFER-PH2.0-7PWZ-R62 | 7 | 12.00 | 16.00 |
| WAFER-PH2.0-8PWZ-R62 | 8 | 14.00 | 18.00 |
| WAFER-PH2.0-9PWZ-R62 | 9 | 16.00 | 20.00 |
| WAFER-PH2.0-10PWZ-R62 | 10 | 18.00 | 22.00 |
| WAFER-PH2.0-11PWZ-R62 | 11 | 20.00 | 24.00 |
| WAFER-PH2.0-12PWZ-R62 | 12 | 22.00 | 26.00 |
| WAFER-PH2.0-13PWZ-R62 | 13 | 24.00 | 28.00 |
| WAFER-PH2.0-14PWZ-R62 | 14 | 26.00 | 30.00 |
| WAFER-PH2.0-15PWZ-R62 | 15 | 28.00 | 32.00 |
| WAFER-PH2.0-16PWZ-R62 | 16 | 30.00 | 34.00 |
| WAFER-PH2.0-17PWZ-R62 | 17 | 32.00 | 36.00 |
| WAFER-PH2.0-18PWZ-R62 | 18 | 34.00 | 38.00 |
| WAFER-PH2.0-19PWZ-R62 | 19 | 36.00 | 40.00 |
| WAFER-PH2.0-20PWZ-R62 | 20 | 38.00 | 42.00 |

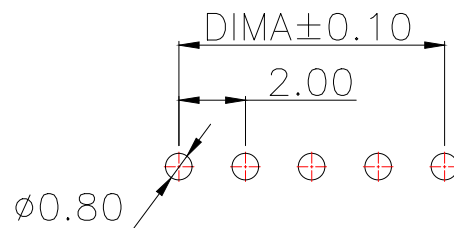
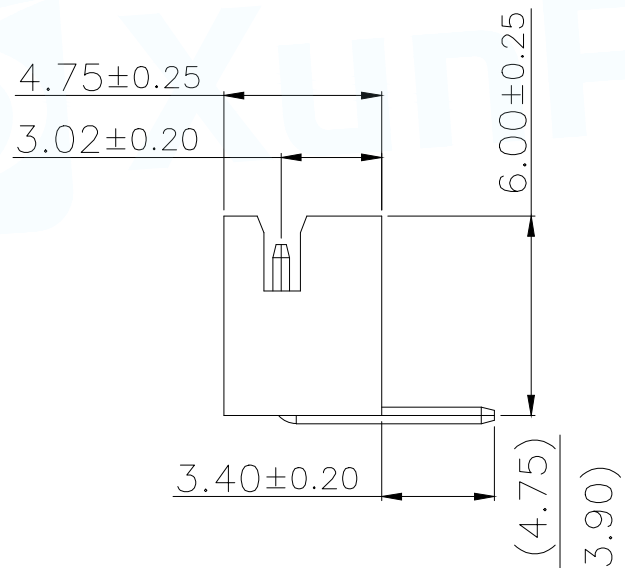
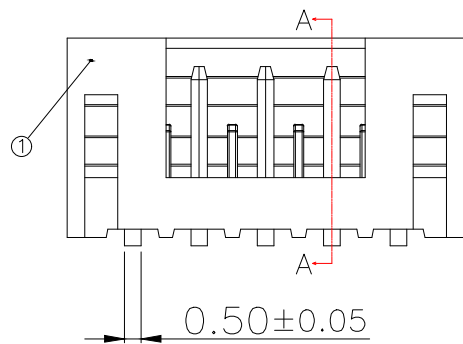

适用线路板(PCB LAYOUT)

| 序号 | 品名 | 材质 |
|----|-------------|------------------------------|
| 1 | PH2.0 弯针 胶芯 | PA66 UL94V-2 Red |
| 2 | PH2.0 弯针 端子 | Copper Alloy/ Tin Plating |

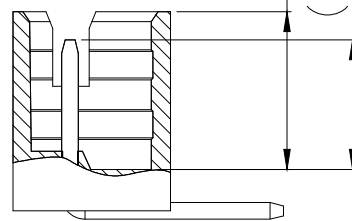

SECTION A-A

| | | | |
|---------------------------------------|------------|---|-----------------------------|
| MANUFACTURE DWG | | 东莞市讯普电子科技有限公司 DongGuan XunPu Electronics Co.,Ltd | |
| UNLESS OTHERWISE SPECIFIED TOLERANCES | | | TITLE: PH2.0 弯针 |
| DECIMALS: | ANGLES: | | PAR WAFER-PH2.0-NPWZ-R62 |
| X.:±0.50 | X'::±5° | | DWN |
| .X:±0.20 | X.X'::±3° | | CHKD |
| .XX:±0.10 | X.XX'::±1° | APVD | SCALE:1:1 UNIT:MM |
| CUSTOMER COPY | | SIZE:A4 | SHEET:1F1 REV:A |

X-ON Electronics

Largest Supplier of Electrical and Electronic Components

Click to view similar products for [Headers & Wire Housings](#) category:

Click to view products by [XUNPU](#) manufacturer:

Other Similar products are found below :

[0015917161](#) [0022155065](#) [57102-F02-18ULF](#) [58102-G61-06LF](#) [582553-1](#) [01.001.5753.1](#) [0050291907](#) [02.125.8002.8](#) [609-3404](#) [61062-3](#)
[CSU011177004](#) [622-0430](#) [622-3653LF](#) [63453-116](#) [636-1030](#) [636-1427](#) [636-3427](#) [636-4007](#) [641938-9](#) [65495-038](#) [65692-001LF](#) [65781-018](#)
[65781-047](#) [65817-010LF](#) [65817-015LF](#) [67095-007LF](#) [67601157](#) [68631-112](#) [68645-018](#) [699319-000](#) [70.362.1628.0](#) [70-4210](#) [70-4226B](#) [70-](#)
[4853B](#) [71.350.2428.0](#) [733-134](#) [733-162](#) [760-3052](#) [MHR-64-VUAL](#) [80.063.4001.1](#) [800-90-001-10-001000](#) [801-43-002-10-013000](#)
[801-43-006-10-002000](#) [803-43-024-10-001000](#) [803-93-012-10-001000](#) [8-1437020-4](#) [819-22-004-30-001101](#) [820-22-006-30-001101](#)
[820-22-008-30-001101](#) [821-22-002-10-001101](#)