

Technical Index:

- 1.The surface of the plastic parts should be smooth,no rough edges,no obvious shrinkage,defects,cracks and other phenomena)
- 2.Lock Configuration: 2 to 3Pin is 1, ≥4Pin is 2
- 3.Temperature range: -25°C~+85°C.
- 4.Rated voltage: 125V.AC/DC.
- 5.Contact resistance: ≤0.02Ω.
- 6.Insulation resistance: ≥100MΩ

Part No	Pin	A	B	C
XY-MX1.25-2A21-YT	2	1.25	3.20	4.30
XY-MX1.25-3A21-YT	3	2.50	4.45	5.55
XY-MX1.25-4A21-YT	4	3.75	5.70	6.80
XY-MX1.25-5A21-YT	5	5.00	6.95	8.05
XY-MX1.25-6A21-YT	6	6.25	8.20	9.30
XY-MX1.25-7A21-YT	7	7.50	9.45	10.55
XY-MX1.25-8A21-YT	8	8.75	10.70	11.80
XY-MX1.25-9A21-YT	9	10.00	11.95	13.05
XY-MX1.25-10A21-YT	10	11.25	13.20	14.30
XY-MX1.25-11A21-YT	11	12.50	14.45	15.55
XY-MX1.25-12A21-YT	12	13.75	15.70	16.80
XY-MX1.25-13A21-YT	13	15.00	16.95	18.05
XY-MX1.25-14A21-YT	14	16.25	18.20	19.30
XY-MX1.25-15A21-YT	15	17.50	19.45	20.55
XY-MX1.25-16A21-YT	16	18.75	20.70	21.80
XY-MX1.25-17A21-YT	17	20.00	21.95	23.05
XY-MX1.25-18A21-YT	18	21.25	23.20	24.30
XY-MX1.25-19A21-YT	19	22.50	24.45	25.55
XY-MX1.25-20A21-YT	20	23.75	25.70	26.80

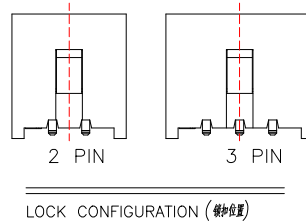
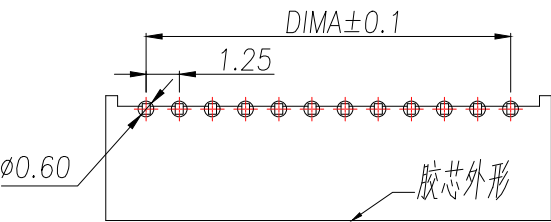
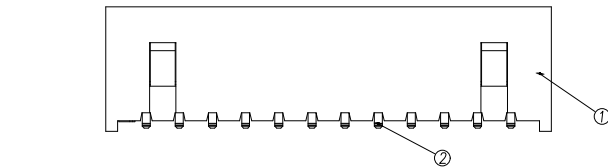
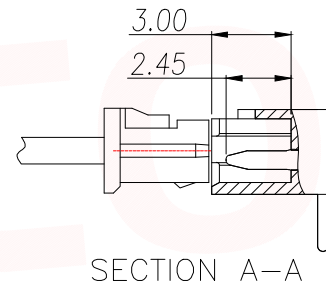
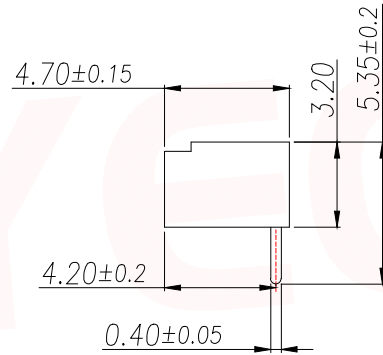
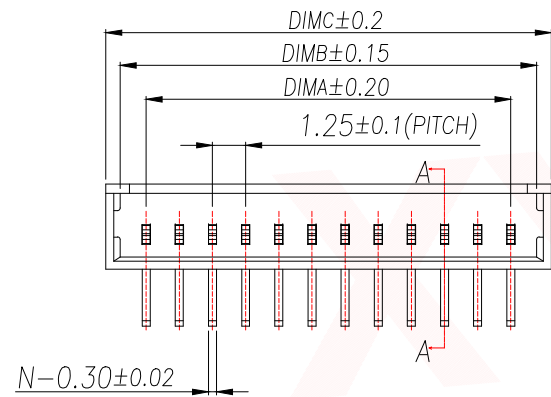
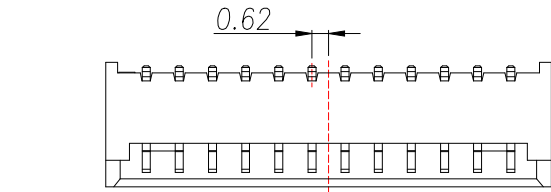

序号	品名	材质
1	基座Wafer	PA66 黄色
2	端子Contact	铜合金/镀锡

DIMENSION IN mm		<b>厦门市辛译精密电子有限公司</b> <b>Xiamen XinYi Xyecomm Electronics Co.,Ltd</b>		
TOLERANCE UNLESS OTHERWISE SPECIFIED				
.X±0.35	X.*±5°	APR.	Alex	TITLE: WAFER 1.25 90° DIP 黄色
.XX±0.25	.X.*±3°	CHK.	Jack	DWG NO. XY-MX1.25-NA21-YT
.XXX±0.15	.XX.*±1°	DRA.	Can	PROJ.  CUSTOMER DRAWING
		SIZE A4	SCALE 1:1	SHEET 1/1 REV. A

## X-ON Electronics

Largest Supplier of Electrical and Electronic Components

*Click to view similar products for [Headers & Wire Housings](#) category:*

*Click to view products by [XYECONN](#) manufacturer:*

Other Similar products are found below :

[0015917161](#) [0022155065](#) [57102-F02-18ULF](#) [58102-G61-06LF](#) [582553-1](#) [01.001.5753.1](#) [0050291907](#) [02.125.8002.8](#) [609-3404](#) [61062-3](#)  
[CSU011177004](#) [622-0430](#) [622-3653LF](#) [63453-116](#) [636-1030](#) [636-1427](#) [636-3427](#) [636-4007](#) [641938-9](#) [65495-038](#) [65692-001LF](#) [65781-018](#)  
[65781-047](#) [65817-010LF](#) [65817-015LF](#) [67095-007LF](#) [67601157](#) [68631-112](#) [68645-018](#) [699319-000](#) [70.362.1628.0](#) [70-4210](#) [70-4226B](#) [70-](#)  
[4853B](#) [71.350.2428.0](#) [733-134](#) [733-162](#) [MHR-64-VUAL](#) [80.063.4001.1](#) [800-90-001-10-001000](#) [801-43-002-10-013000](#) [801-43-006-10-](#)  
[002000](#) [803-43-024-10-001000](#) [803-93-012-10-001000](#) [8-1437020-4](#) [819-22-004-30-001101](#) [820-22-006-30-001101](#) [820-22-008-30-001101](#)  
[821-22-002-10-001101](#) [821-22-003-10-002101](#)