

Description: 8010 2.4GHz Chip Antenna

PART NUMBER: ANT8010LL04R2400A

Features:

- Size : 8.0x1.0x1.0 mm
- Omni-directional radiation
- Tape & reel automatic mounting
- Reflow process compatible
- RoHS compliant



Applications:

- 2.4GHz WiFi device
- Bluetooth gadget
- Zigbee device
- ISM band equipment

In the effort to improve our products, we reserve the right to make changes judged to be necessary.

CONFIDENTIAL AND PROPRIETARY INFORMATION

This document contains confidential and proprietary information of Pulse Electronics, Inc. (Pulse) and is protected by copyright, trade secret and other state and federal laws. Its receipt or possession does not convey any rights to reproduce, disclose its contents, or to manufacture, use or sell anything it may describe. Reproduction, disclosure or use without specific written authorization of Pulse is strictly forbidden.

For more information:

Pulse Worldwide Headquarters
15255 Innovation Drive #100
San Diego, CA 92128
USA
Tel: 1-858-674-8100

Pulse/Larsen Antennas
18110 SE 34th St Bldg 2 Suite 250
Vancouver, WA 98683
USA
Tel: 1-360-944-7551

Europe Headquarters
Pulse GmbH & Do, KG
Zeppelinstrasse 15
Herrenberg, Germany
Tel: 49 7032 7806 0

Pulse (Suzhou) Wireless Products Co, Inc.
99 Huo Ju Road(#29 Bldg,4th Phase
Suzhou New District
Jiangsu Province, Suzhou 215009 PR China
Tel: 86 512 6807 9998



Description: 8010 2.4GHz Chip Antenna

PART NUMBER: ANT8010LL04R2400A

ELECTRICAL SPECIFICATIONS

| | |
|--------------------------------------|---|
| Working Frequency | 2.4 ~ 2.5 GHz |
| Bandwidth | 170 MHz(Typ.) |
| Return Loss | 10.0 dB Min |
| Polarization | Linear |
| Azimuth Beamwidth | Omni-directional |
| Peak Gain | 5.46 dBi(Typ.) |
| Impedance | 50 Ω |
| Operating Temperature | - 40~105 °C |
| Maximum Power | 1 W |
| Termination | Ni / Sn (Environmentally-Friendly Leadless) |
| Resistance to Soldering Heats | 260°C , 10sec. |

NOTE

1. The specification is defined on Pulse evaluation board

MECHANICAL DRAWING

| | Dimension |
|--------|------------------|
| L (mm) | 1.00 ±0.10 |
| W (mm) | 8.00 ±0.10 |
| T (mm) | 1.00 ±0.10 |
| C (mm) | 0.90 ±0.15 |

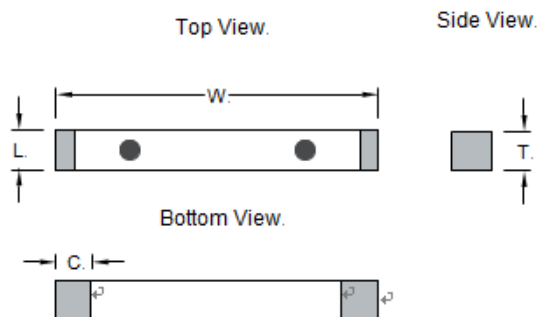

| Terminal name | Function |
|----------------------|-------------------------|
| S1 | Feeding / Soldering Pad |
| S2 | Soldering / Feeding Pad |

In the effort to improve our products, we reserve the right to make changes judged to be necessary.

CONFIDENTIAL AND PROPRIETARY INFORMATION

This document contains confidential and proprietary information of Pulse Electronics, Inc. (Pulse) and is protected by copyright, trade secret and other state and federal laws. Its receipt or possession does not convey any rights to reproduce, disclose its contents, or to manufacture, use or sell anything it may describe. Reproduction, disclosure or use without specific written authorization of Pulse is strictly forbidden.

Description: 8010 2.4GHz Chip Antenna

PART NUMBER: ANT8010LL04R2400A

REFERENCE DESIGN OF EVALUATION BOARD

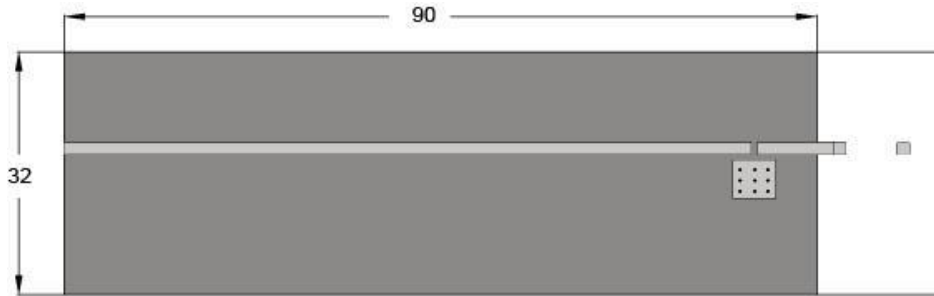

Unit : mm

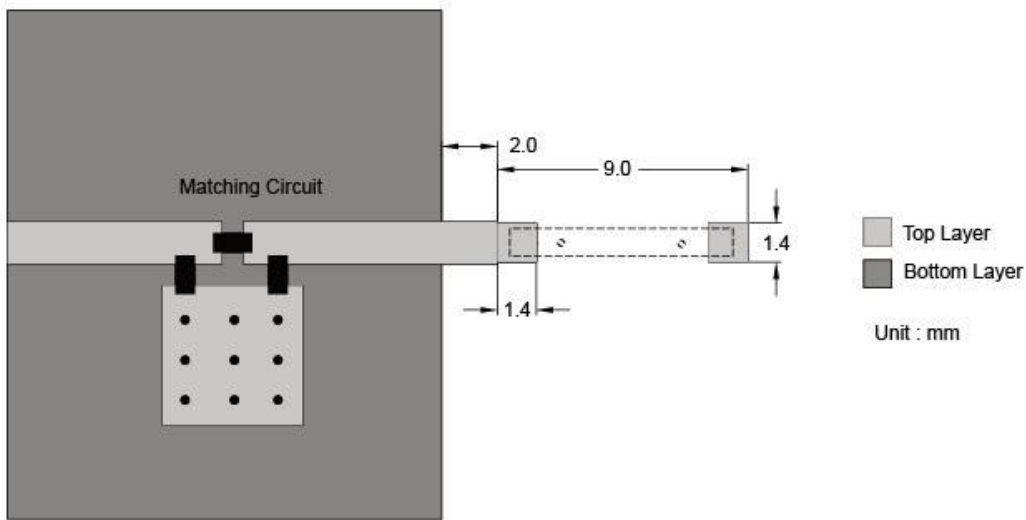

Top Layer
Bottom Layer

Unit : mm

YNB0007

Outlook and dimension of evaluation board

Footprint

In the effort to improve our products, we reserve the right to make changes judged to be necessary.

CONFIDENTIAL AND PROPRIETARY INFORMATION

This document contains confidential and proprietary information of Pulse Electronics, Inc. (Pulse) and is protected by copyright, trade secret and other state and federal laws. Its receipt or possession does not convey any rights to reproduce, disclose its contents, or to manufacture, use or sell anything it may describe. Reproduction, disclosure or use without specific written authorization of Pulse is strictly forbidden.

Description: 8010 2.4GHz Chip Antenna

PART NUMBER: ANT8010LL04R2400A

ELECTRICAL PERFORMANCES

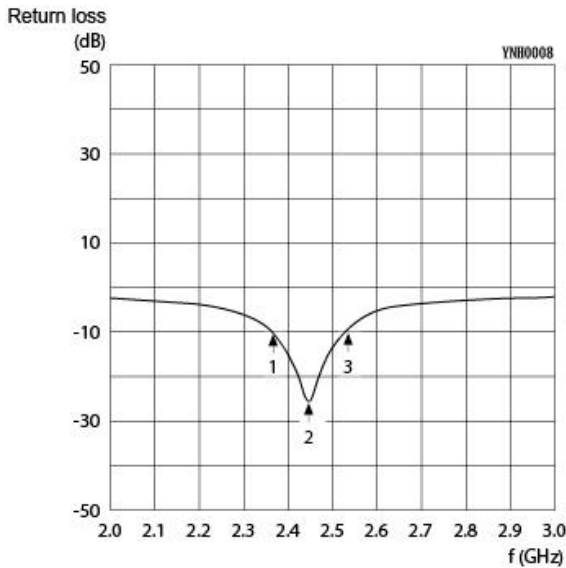

- Marker data
- 1. 2.37GHz, -10dB
 - 2. 2.45GHz, -24.9dB
 - 3. 2.54GHz, -10dB

Return loss

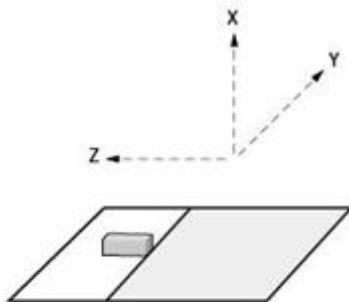

Evaluation board and XYZ direction
Radiation pattern

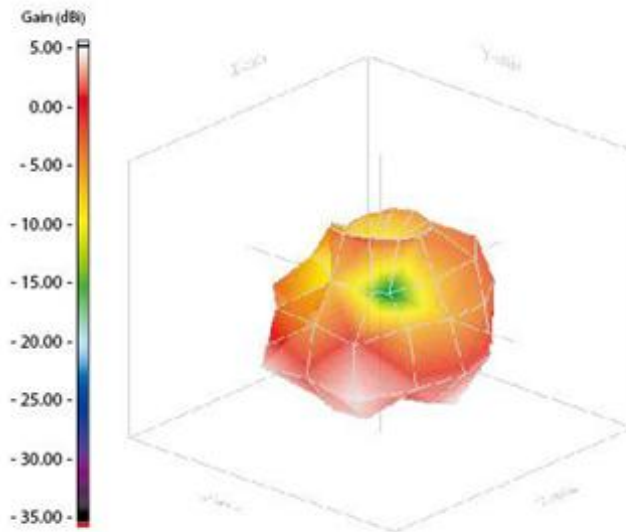

Max gain = 5.46 dBi, at (150,150)
MEG (mean effective gain) = -1.46 dBi
Directivity (dB) = 6.78
Efficiency = -1.32 dB, 73.73 %

In the effort to improve our products, we reserve the right to make changes judged to be necessary.

CONFIDENTIAL AND PROPRIETARY INFORMATION

This document contains confidential and proprietary information of Pulse Electronics, Inc. (Pulse) and is protected by copyright, trade secret and other state and federal laws. Its receipt or possession does not convey any rights to reproduce, disclose its contents, or to manufacture, use or sell anything it may describe. Reproduction, disclosure or use without specific written authorization of Pulse is strictly forbidden.

Description: 8010 2.4GHz Chip Antenna

PART NUMBER: ANT8010LL04R2400A

REVISION HISTORY

| Revision | Date | Description |
|-----------|---------------|-------------|
| Version 1 | Oct. 12, 2020 | - New issue |

In the effort to improve our products, we reserve the right to make changes judged to be necessary.

CONFIDENTIAL AND PROPRIETARY INFORMATION

This document contains confidential and proprietary information of Pulse Electronics, Inc. (Pulse) and is protected by copyright, trade secret and other state and federal laws. Its receipt or possession does not convey any rights to reproduce, disclose its contents, or to manufacture, use or sell anything it may describe. Reproduction, disclosure or use without specific written authorization of Pulse is strictly forbidden.

X-ON Electronics

Largest Supplier of Electrical and Electronic Components

Click to view similar products for [Antennas](#) category:

Click to view products by [Yageo](#) manufacturer:

Other Similar products are found below :

[GAN30084EU](#) [930-033-R](#) [GW17.07.0250E](#) [1513563-1](#) [EXE902SM](#) [APAMPG-117](#) [MAF94383](#) [W3908B0100](#) [W6102B0100](#) [YE572113-30RSMM](#) [108-00014-50](#) [66089-2406](#) [A09-F8NF-M](#) [A09-F5NF-M](#) [RGFRA1903041A1T](#) [W3593B0100](#) [W3921B0100](#) [SIMNA-868](#) [SIMNA-915](#) [SIMNA-433](#) [W1044](#) [W1049B090](#) [A75-001](#) [WTL2449CQ1-FRSMM](#) [CPL9C](#) [EXB148BN](#) [0600-00060](#) [TRA9020S3PBN-001](#) [GD5W-28P-NF](#) [MA9-7N](#) [GD53-25](#) [GD5W-21P-NF](#) [EXB144SM](#) [C37](#) [MAF94051](#) [GD35-17P-NF](#) [P1744](#) [MA9-5N](#) [EXD420PL](#) [B1322NR](#) [QWFTB120](#) [MAF94271](#) [MAF94300](#) [GPSMB301](#) [FG4403](#) [AO-AGSM-OM54](#) [5200232](#) [MIKROE-2349](#) [WCM.01.0111](#) [MIKROE-2393](#)