

THE INFORMATION CONTAINED IN THIS DRAWING IS THE SOLE PROPERTY OF YAMAICHI ELECTRONICS DEUTSCHLAND GmbH. ANY REPRODUCTION IN PART OR WHOLE WITHOUT THE WRITTEN PERMISSION OF YAMAICHI ELECTRONICS DEUTSCHLAND GmbH IS PROHIBITED.

CONFIDENTIAL

Assembly before crimping

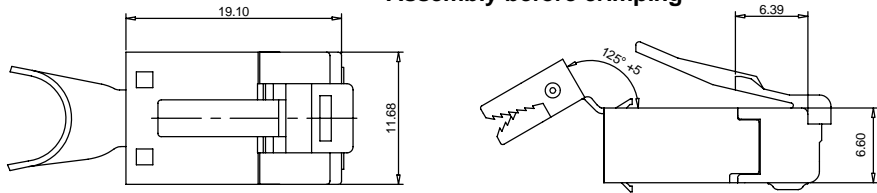

Assembly after crimping

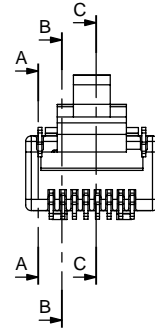
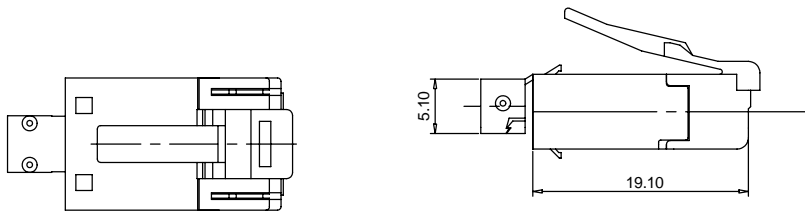

SCHNITT A-A
MAßSTAB 3 : 1

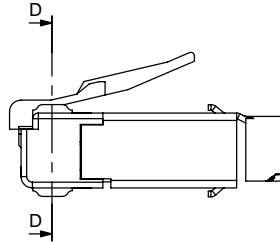

SCHNITT B-B
MAßSTAB 3 : 1

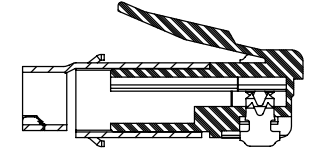

SCHNITT C-C
MAßSTAB 3 : 1

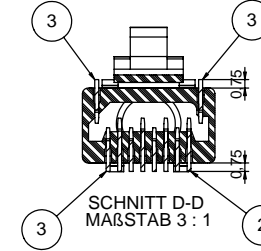

SCHNITT D-D
MAßSTAB 3 : 1

2 PRONGS for Stranded Wire

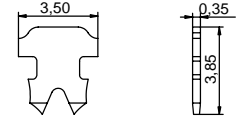

Short (S)

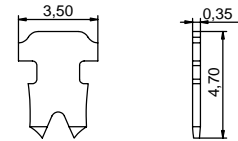

Long (L)

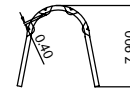

KUNDENFREIGABE / CUSTOMER APPROVAL

Firma / Company :

Unterschrift / Signature : _____ Datum / Date : _____

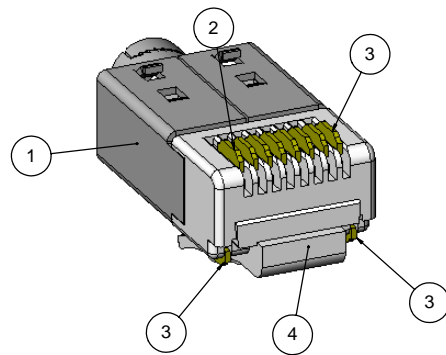

Crimp after round crimping

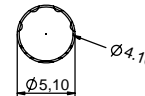

Crimp after square crimping

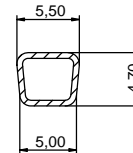

Materials :

- Housing material : Crastin T841FR NC010 PBT, 10% Glass Fiber
Durability : 2000 mating cycles
- Contact blade : Phosphor Bronze: high strength copper alloy
100 microinches Nickel under plated &
30 microinches Gold selected

Critical Dimensions.
To determine Cmk and Cpk.

Specification/Drawing subject to alteration with notice

POS.-NR.	PART	DESCRIPTION	MATERIAL	Qty.
1	P(090)P382	Plug Shield	Nickel-plated Brass	1
2	P(090)P396	Contact Blade (Long)	Phosphor Bronze (electroless Nickel-plating)	4
3	P(090)P395	Contact Blade (Short)	Phosphor Bronze (electroless Nickel-plating)	6
4	P(090)P709	Plug body	Crastin T841FR NC010 PBT, 10% Glass Fiber	1

REV.	REVISION DESCRIPTION	INITIALS	REV. DATE
△			
△			
△	Updated components	SV	16.08.2007
△	Article No. issued	SV	16.07.2007

Order / Article No. 82-00410

DO NOT SCALE DRAWING

CLASSIFICATION: Y-Con RJ45 Stecker, 8(8)+2 mit Stromkontakte, PBT, Cat 5

DESIGN	NAME	DATE	TITLE
SV		13.07.2007	Y-CONPLUG-51
SV		16.08.2007	
HE		16.08.2007	

Customer-P(090)A427

SCALE: 3:1 SHEET 1 OF 1

RoHS compliant acc. to directive 2002/95/EG



X-ON Electronics

Largest Supplier of Electrical and Electronic Components

Click to view similar products for [Modular Connectors / Ethernet Connectors](#) category:

Click to view products by [Yamaichi](#) manufacturer:

Other Similar products are found below :

[8949-H88/06BLKA/SN](#) [74441-0010/BKN](#) [MP1010RX-1000](#) [MP44RX-1000](#) [PHJ-4P4C-1-V-4](#) [PHP-6P6C-5](#) [GAX-3-66](#) [GAX-8-62](#) [GDCX-PA-66-50](#) [GDCX-PN-64](#) [GDCX-PN-66](#) [GDCX-PN-66-50](#) [GDLX-A-66](#) [GDLX-N-66](#) [GDLX-S-66](#) [GDLX-S-88K](#) [GDLX-SMT-S-88](#) [GDTX-S-88-50](#) [GDX-PA-1010](#) [GLX-N-1010M-BLK](#) [GLX-S-88M-BLK](#) [GMX-N-1010](#) [GMX-S-1010](#) [GMX-S-66](#) [GMX-SMT4-N-88](#) [GPX-2-64](#) [GSGX-N-2-88](#) [GSGX-N-4-88](#) [GSX-NS2-88-3.05](#) [GSX-NS2-88-3.05-50](#) [GSX-NS-88-3.05-50](#) [PT-108A-8C-UL](#) [PT-J951-8C](#) [PTS-J531-8CS-50UL](#) [1-1775629-2](#) [A-2014-0-4](#) [GWLX-S-88-GR](#) [GWLX-S9-88-YG](#) [DC-1021-8-WH-6](#) [1300530003](#) [1324640-4](#) [RJ11FTVC2G](#) [RJ11FTVC2N](#) [RJFTVX2SA1G](#) [132764-001](#) [1413235](#) [MP88X-1000](#) [MPS88RX-5000](#) [E5288-S000K3-L](#) [E5908-15A242-L](#)