



SMD Power Inductor SCCD Series 贴片功率电感 SCCD 系列

Features 特点

- High heat resistance and excellent solderability.
良好的可焊性
- Excellent terminal strength construction.
良好的焊盘结构
- Flat bottom surface ensures secure, reliable mounting.
平坦焊面便于安装
- Surface mount inductor with high current rating.
大电流表面贴装电感



Applications 应用

- Ideally used in Digital camera, notebook PC, LCD TV set, DC-DC Converters, etc.
用于数码相机、笔记本电脑、LCD电视、DC-DC转换等。

Product Identification 产品标识

SCCD 54 -3R3 M T

① ② ③ ④ ⑤

- ① Series name 系列名称
- ② Product dimensions 产品尺寸: 【5.8*5.2*4.5 mm】
- ③ Inductance Value 电感量: 【3R3=3.3μH 100=10μH 101=100μH】
- ④ Inductance Tolerance 电感量公差: 【M=±20%; N=±30%】
- ⑤ Packing Style: 【T: Taping 编带盘装 B: Bulk 散装】

Shapes And Dimensions 外形及尺寸示意图

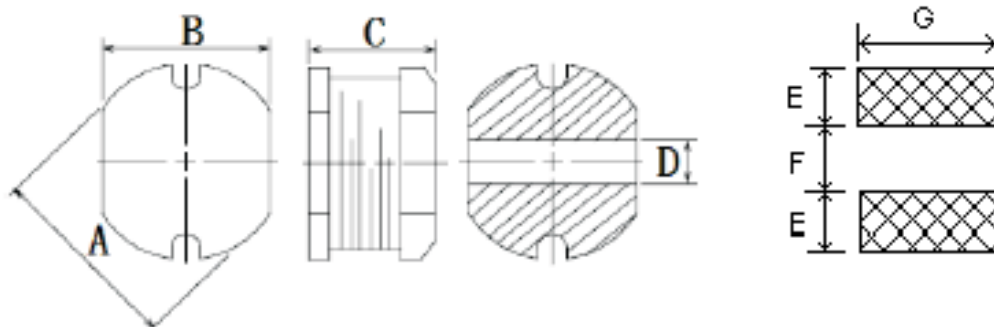

Part	SCCD31	SCCD32	SCCD42	SCCD43	SCCD52	SCCD53	SCCD54	SCCD73	SCCD75	SCCD104	SCCD105
A	3.5±0.3	3.5±0.3	4.5±0.3	4.5±0.3	5.8±0.3	5.8±0.3	5.8±0.3	7.8±0.3	7.8±0.3	10.0±0.3	10.0±0.3
B	3.0±0.3	3.0±0.3	4.0±0.3	4.0±0.3	5.2±0.3	5.2±0.3	5.2±0.3	7.0±0.3	7.0±0.3	9.0±0.3	9.0±0.3
C	1.6±0.3	2.1±0.3	2.15±0.3	3.2±0.3	2.1±0.35	3.0±0.3	4.5±0.3	3.5±0.4	5.0±0.4	4.0±0.4	5.4±0.3
D	1.0±0.1	1.0±0.1	1.5±0.1	1.5±0.1	1.5±0.1	1.7±0.1	1.7±0.1	2.2±0.1	2.2±0.1	2.8±0.1	2.8±0.1
E	1.3±0.3	1.3±0.3	2.1±0.3	2.1±0.3	2.5±0.3	2.5±0.3	2.5±0.3	3.3±0.3	3.3±0.3	4.4±0.3	4.4±0.3
F	0.9±0.1	0.9±0.1	1.0±0.1	1.0±0.1	1.0±0.1	1.2±0.1	1.2±0.1	1.4±0.2	1.4±0.2	1.8±0.2	1.8±0.2
G	3.0±0.3	3.0±0.3	4.0±0.3	4.0±0.3	3.0±0.3	5.8±0.3	5.8±0.3	8.0±0.3	8.0±0.3	10.0±0.3	10.0±0.3

**Electrical Characteristics 电气性能**

SCCD31 Series

Part Number	L (μ H)	Tolerance ($\pm\%$)	Test Freq. (KHz)	RDC Max. (Ω)	Isat(A)
SCCD31-2R2MT	2.2	20	100	0.085	1.30
SCCD31-3R3MT	3.3	20	100	0.115	1.20
SCCD31-4R7MT	4.7	20	100	0.170	1.00
SCCD31-100MT	10	20	100	0.350	0.78
SCCD31-150MT	15	20	100	0.550	0.60
SCCD31-220MT	22	20	100	0.890	0.46
SCCD31-270MT	27	20	100	1.050	0.43
SCCD31-330MT	33	20	100	1.250	0.40

SCCD32 Series

Part Number	L (μ H)	Tolerance ($\pm\%$)	Test Freq. (KHz)	RDC Max. (Ω)	Isat(A)
SCCD32-1R0MT	1.0	20	100	0.05	1.85
SCCD32-1R5MT	1.5	20	100	0.06	1.85
SCCD32-1R8MT	1.8	20	100	0.07	1.70
SCCD32-2R2MT	2.2	20	100	0.08	1.60
SCCD32-2R7MT	2.7	20	100	0.09	1.55
SCCD32-3R3MT	3.3	20	100	0.10	1.40
SCCD32-3R9MT	3.9	20	100	0.115	1.30
SCCD32-4R7MT	4.7	20	100	0.165	1.25
SCCD32-5R6MT	5.6	20	100	0.185	1.20
SCCD32-6R8MT	6.8	20	100	0.21	1.10
SCCD32-8R2MT	8.2	20	100	0.24	1.05
SCCD32-820MT	10	20	100	0.35	0.760
SCCD32-100MT	12	20	100	0.46	0.685
SCCD32-120MT	15	20	100	0.50	0.635
SCCD32-150MT	18	20	100	0.60	0.525
SCCD32-180MT	22	20	100	0.65	0.500
SCCD32-220MT	27	20	100	0.75	0.405
SCCD32-270MT	33	20	100	0.85	0.380
SCCD32-330MT	39	20	100	1.00	0.355
SCCD32-390MT	47	20	100	1.60	0.330
SCCD32-470MT	56	20	100	1.65	0.290
SCCD32-560MT	68	20	100	1.85	0.275
SCCD32-680MT	82	20	100	2.10	0.250
SCCD32-101KT	100	10	1	2.20	0.220

**Electrical Characteristics 电气性能**

SCCD42 Series

Part Number	L (μH)	Tolerance (±%)	Test Freq. (KHz)	RDC Max. (Ω)	Isat(A)
SCCD42-1R0MT	1.0	20	100	0.050	3.00
SCCD42-1R5MT	1.5	20	100	0.055	2.80
SCCD42-2R2MT	2.2	20	100	0.070	2.50
SCCD42-3R3MT	3.3	20	100	0.085	2.25
SCCD42-4R7MT	4.7	20	100	0.120	1.80
SCCD42-6R8MT	6.8	20	100	0.170	1.40
SCCD42-8R2MT	8.2	20	100	0.200	1.20
SCCD42-100MT	10	20	100	0.210	1.00
SCCD42-150MT	15	20	100	0.470	0.82
SCCD42-220MT	22	20	100	0.500	0.60

SCCD43 Series

Part Number	L (μH)	Tolerance (±%)	Test Freq. (KHz)	RDC Max. (Ω)	Isat(A)
SCCD43-1R0MT	1.0	20	100	0.045	3.50
SCCD43-2R2MT	2.2	20	100	0.070	2.40
SCCD43-3R3MT	3.3	20	100	0.085	2.25
SCCD43-3R9MT	3.9	20	100	0.090	1.70
SCCD43-4R7MT	4.7	20	100	0.105	1.65
SCCD43-5R6MT	5.6	20	100	0.120	1.60
SCCD43-6R8MT	6.8	20	100	0.130	1.40
SCCD43-8R2MT	8.2	20	100	0.145	1.30
SCCD43-100MT	10	20	100	0.180	1.10
SCCD43-120MT	12	20	100	0.210	1.00
SCCD43-150MT	15	20	100	0.235	0.85
SCCD43-180MT	18	20	100	0.330	0.80
SCCD43-220MT	22	20	100	0.360	0.70
SCCD43-270MT	27	20	100	0.520	0.65
SCCD43-330MT	33	20	100	0.540	0.60
SCCD43-390MT	39	20	100	0.580	0.55
SCCD43-470MT	47	20	100	0.840	0.48
SCCD43-560MT	56	20	100	0.930	0.46
SCCD43-680MT	68	20	100	1.110	0.44
SCCD43-820MT	82	20	100	1.250	0.42
SCCD43-101KT	100	10	1	1.400	0.40
SCCD43-151KT	150	10	1	2.000	0.35
SCCD43-221KT	220	10	1	2.460	0.27
SCCD43-331KT	330	10	1	4.500	0.20
SCCD43-471KT	470	10	1	5.500	0.16
SCCD43-561KT	560	10	1	6.000	0.14
SCCD43-681KT	680	10	1	6.800	0.13
SCCD43-821KT	820	10	1	8.000	0.12

**Electrical Characteristics 电气性能**

SCCD52 Series

Part Number	L (μ H)	Tolerance ($\pm\%$)	Test Freq. (KHz)	RDC Max. (Ω)	Isat(A)
SCCD52-1R1MT	1.1	20	100	0.030	2.50
SCCD52-1R5MT	1.5	20	100	0.040	2.10
SCCD52-2R2MT	2.2	20	100	0.070	2.00
SCCD52-3R3MT	3.3	20	100	0.080	1.60
SCCD52-4R7MT	4.7	20	100	0.093	1.30
SCCD52-5R6MT	5.6	20	100	0.115	1.10
SCCD52-100MT	10	20	100	0.170	0.90
SCCD52-150MT	15	20	100	0.330	0.72
SCCD52-220MT	22	20	100	0.400	0.60
SCCD52-330MT	33	20	100	0.540	0.50
SCCD52-470MT	47	20	100	0.690	0.40
SCCD52-680MT	68	20	100	1.180	0.37
SCCD52-101KT	100	10	1	1.800	0.27
SCCD52-151KT	150	10	1	2.750	0.23
SCCD52-221KT	220	10	1	3.200	0.20

SCCD53 Series

Part Number	L (μ H)	Tolerance ($\pm\%$)	Test Freq. (KHz)	RDC Max. (Ω)	Isat(A)
SCCD53-1R0MT	1.0	20	100	0.028	4.50
SCCD53-1R5MT	1.5	20	100	0.034	4.20
SCCD53-2R2MT	2.2	20	100	0.050	4.00
SCCD53-3R3MT	3.3	20	100	0.060	3.00
SCCD53-4R7MT	4.7	20	100	0.070	2.80
SCCD53-6R8MT	6.8	20	100	0.100	2.50
SCCD53-8R2MT	8.2	20	100	0.120	2.30
SCCD53-100MT	10	20	100	0.130	2.00
SCCD53-150MT	15	20	100	0.200	1.50
SCCD53-220MT	22	20	100	0.280	1.20
SCCD53-270MT	27	20	100	0.300	1.10
SCCD53-330MT	33	20	100	0.410	1.00
SCCD53-470MT	47	20	100	0.550	0.80
SCCD53-680MT	68	20	100	0.630	0.70
SCCD53-101KT	100	10	1	0.750	0.70
SCCD53-151KT	150	10	1	1.600	0.60
SCCD53-181KT	180	10	1	1.650	0.50
SCCD53-221KT	220	10	1	1.860	0.40
SCCD53-331KT	330	10	1	3.100	0.25

**Electrical Characteristics 电气性能**

SCCD54 Series

Part Number	L (μH)	Tolerance (±%)	Test Freq. (KHz)	RDC Max. (Ω)	Isat(A)
SCCD54-R47MT	0.47	20	100	0.012	4.80
SCCD54-1R0MT	1.0	20	100	0.025	3.50
SCCD54-2R2MT	2.2	20	100	0.028	3.20
SCCD54-3R3MT	3.3	20	100	0.035	2.50
SCCD54-4R7MT	4.7	20	100	0.038	2.50
SCCD54-6R8MT	6.8	20	100	0.070	2.00
SCCD54-8R2MT	8.2	20	100	0.090	1.70
SCCD54-100MT	10	20	100	0.10	1.65
SCCD54-120MT	12	20	100	0.12	1.55
SCCD54-150MT	15	20	100	0.14	1.40
SCCD54-180MT	18	20	100	0.15	1.25
SCCD54-220MT	22	20	100	0.18	1.10
SCCD54-270MT	27	20	100	0.20	0.95
SCCD54-330MT	33	20	100	0.22	0.90
SCCD54-390MT	39	20	100	0.30	0.80
SCCD54-470MT	47	20	100	0.35	0.75
SCCD54-560MT	56	20	100	0.40	0.70
SCCD54-680MT	68	20	100	0.45	0.65
SCCD54-820MT	82	20	100	0.60	0.60
SCCD54-101KT	100	10	1	0.70	0.55
SCCD54-121KT	120	10	1	0.85	0.45
SCCD54-151KT	150	10	1	1.10	0.43
SCCD54-181KT	180	10	1	1.35	0.40
SCCD54-221KT	220	10	1	1.55	0.35
SCCD54-331KT	330	10	1	1.98	0.30
SCCD54-471KT	470	10	1	2.50	0.25
SCCD54-561KT	560	10	1	2.87	0.20
SCCD54-681KT	680	10	1	3.50	0.18
SCCD54-821KT	820	10	1	5.20	0.17
SCCD54-102KT	1000	10	1	5.50	0.15

SCCD73 Series

Part Number	L (μH)	Tolerance (±%)	Test Freq. (KHz)	RDC Max. (Ω)	Isat(A)
SCCD73-1R0MT	1.0	20	100	0.012	6.00
SCCD73-2R2MT	2.2	20	100	0.022	3.20
SCCD73-2R5MT	2.5	20	100	0.025	2.80
SCCD73-3R3MT	3.3	20	100	0.035	3.60
SCCD73-4R7MT	4.7	20	100	0.048	4.00
SCCD73-6R8MT	6.8	20	100	0.050	2.20
SCCD73-100MT	10	20	100	0.080	2.10
SCCD73-120MT	12	20	100	0.090	1.80
SCCD73-150MT	15	20	100	0.095	1.70

**Electrical Characteristics 电气性能**

SCCD73 Series

Part Number	L (μ H)	Tolerance ($\pm\%$)	Test Freq. (KHz)	RDC Max. (Ω)	Isat(A)
SCCD73-180MT	18	20	100	0.110	1.40
SCCD73-220MT	22	20	100	0.156	1.35
SCCD73-270MT	27	20	100	0.145	1.25
SCCD73-330MT	33	20	100	0.170	1.05
SCCD73-390MT	39	20	100	0.215	0.95
SCCD73-470MT	47	20	100	0.305	0.90
SCCD73-560MT	56	20	100	0.280	0.80
SCCD73-680MT	68	20	100	0.330	0.75
SCCD73-820MT	82	20	100	0.405	0.70
SCCD73-101KT	100	10	1	0.480	0.65
SCCD73-121KT	120	10	1	0.535	0.60
SCCD73-151KT	150	10	1	0.750	0.55
SCCD73-181KT	180	10	1	1.020	0.50
SCCD73-221KT	220	10	1	1.200	0.45
SCCD73-271KT	270	10	1	1.300	0.37
SCCD73-331KT	330	10	1	1.490	0.35
SCCD73-471KT	470	10	1	2.200	0.30
SCCD73-561KT	560	10	1	2.400	0.25

SCCD75 Series

Part Number	L (μ H)	Tolerance ($\pm\%$)	Test Freq. (KHz)	RDC Max. (Ω)	Isat(A)
SCCD75-1R0MT	1.0	20	100	0.015	5.80
SCCD75-2R2MT	2.2	20	100	0.023	5.20
SCCD75-3R3MT	3.3	20	100	0.025	4.80
SCCD75-4R7MT	4.7	20	100	0.040	4.00
SCCD75-6R8MT	6.8	20	100	0.041	3.00
SCCD75-8R2MT	8.2	20	100	0.042	2.70
SCCD75-100MT	10	20	100	0.07	2.55
SCCD75-120MT	12	20	100	0.08	2.40
SCCD75-150MT	15	20	100	0.09	2.00
SCCD75-180MT	18	20	100	0.10	1.95
SCCD75-220MT	22	20	100	0.11	1.70
SCCD75-270MT	27	20	100	0.12	1.55
SCCD75-330MT	33	20	100	0.13	1.40
SCCD75-390MT	39	20	100	0.15	1.35
SCCD75-470MT	47	20	100	0.19	1.25
SCCD75-560MT	56	20	100	0.23	1.10
SCCD75-680MT	68	20	100	0.25	1.00
SCCD75-820MT	82	20	100	0.35	0.95
SCCD75-101KT	100	10	1	0.40	0.78

**Electrical Characteristics 电气性能**

SCCD75 Series

Part Number	L (μH)	Tolerance (±%)	Test Freq. (KHz)	RDC Max. (Ω)	Isat(A)
SCCD75-121KT	120	10	1	0.45	0.73
SCCD75-151KT	150	10	1	0.60	0.70
SCCD75-181KT	180	10	1	0.70	0.60
SCCD75-221KT	220	10	1	0.95	0.55
SCCD75-271KT	270	10	1	1.10	0.50
SCCD75-331KT	330	10	1	1.25	0.45
SCCD75-391KT	390	10	1	1.75	0.40
SCCD75-471KT	470	10	1	1.95	0.35
SCCD75-681KT	680	10	1	2.18	0.27
SCCD75-102KT	1000	10	1	3.85	0.20

SCCD104 Series

Part Number	L (μH)	Tolerance (±%)	Test Freq. (KHz)	RDC Max. (Ω)	Isat(A)
SCCD104-100MT	10	20	100	0.05	2.90
SCCD104-120MT	12	20	100	0.06	2.80
SCCD104-150MT	15	20	100	0.07	2.30
SCCD104-180MT	18	20	100	0.08	2.15
SCCD104-220MT	22	20	100	0.09	2.10
SCCD104-270MT	27	20	100	0.10	1.90
SCCD104-330MT	33	20	100	0.12	1.85
SCCD104-390MT	39	20	100	0.15	1.45
SCCD104-470MT	47	20	100	0.17	1.35
SCCD104-560MT	56	20	100	0.20	1.30
SCCD104-680MT	68	20	100	0.25	1.20
SCCD104-820MT	82	20	100	0.27	1.00
SCCD104-101KT	100	10	1	0.30	0.95
SCCD104-121KT	120	10	1	0.40	0.90
SCCD104-151KT	150	10	1	0.50	0.80
SCCD104-181KT	180	10	1	0.62	0.70
SCCD104-221KT	220	10	1	0.72	0.65
SCCD104-271KT	270	10	1	0.95	0.57
SCCD104-331KT	330	10	1	1.10	0.55
SCCD104-391KT	390	10	1	1.20	0.50
SCCD104-471KT	470	10	1	1.52	0.45
SCCD104-561KT	560	10	1	1.90	0.40

**Electrical Characteristics 电气性能**

SCCD105 Series

Part Number	L (μH)	Tolerance (±%)	Test Freq. (KHz)	RDC Max. (Ω)	Isat(A)
SCCD105-100MT	10	20	100	0.06	3.80
SCCD105-120MT	12	20	100	0.07	3.40
SCCD105-150MT	15	20	100	0.08	2.90
SCCD105-180MT	18	20	100	0.09	2.65
SCCD105-220MT	22	20	100	0.10	2.50
SCCD105-270MT	27	20	100	0.11	2.25
SCCD105-330MT	33	20	100	0.12	2.00
SCCD105-390MT	39	20	100	0.13	1.90
SCCD105-470MT	47	20	100	0.15	1.70
SCCD105-560MT	56	20	100	0.19	1.60
SCCD105-680MT	68	20	100	0.22	1.45
SCCD105-820MT	82	20	100	0.25	1.30
SCCD105-101KT	100	10	1	0.33	1.15
SCCD105-121KT	120	10	1	0.40	1.00
SCCD105-151KT	150	10	1	0.45	0.95
SCCD105-181KT	180	10	1	0.60	0.85
SCCD105-221KT	220	10	1	0.70	0.75
SCCD105-271KT	270	10	1	0.95	0.70
SCCD105-331KT	330	10	1	1.10	0.60
SCCD105-391KT	390	10	1	1.20	0.55
SCCD105-471KT	470	10	1	1.45	0.50
SCCD105-561KT	560	10	1	1.90	0.48
SCCD105-681KT	680	10	1	2.25	0.45
SCCD105-821KT	820	10	1	2.50	0.40

1. Isat: Saturation Current, the current when the inductance becomes 10% lower than its initial value.

X-ON Electronics

Largest Supplier of Electrical and Electronic Components

Click to view similar products for [Fixed Inductors](#) category:

Click to view products by [Yanchuang](#) manufacturer:

Other Similar products are found below :

[MLZ1608M6R8WTD25](#) [MLZ1608N6R8LT000](#) [MLZ1608N3R3LTD25](#) [MLZ1608N3R3LT000](#) [MLZ1608N150LT000](#)
[MLZ1608M150WTD25](#) [MLZ1608M3R3WTD25](#) [MLZ1608M3R3WT000](#) [MLZ1608M150WT000](#) [MLZ1608A1R5WT000](#)
[MLZ1608N1R5LT000](#) [B82432C1333K000](#) [PCMB053T-1R0MS](#) [PCMB053T-1R5MS](#) [PCMB104T-1R5MS](#) [CR32NP-100KC](#) [CR32NP-151KC](#) [CR32NP-180KC](#) [CR32NP-181KC](#) [CR32NP-1R5MC](#) [CR32NP-390KC](#) [CR32NP-3R9MC](#) [CR32NP-680KC](#) [CR32NP-820KC](#)
[CR32NP-8R2MC](#) [CR43NP-390KC](#) [CR43NP-560KC](#) [CR43NP-680KC](#) [CR54NP-181KC](#) [CR54NP-470LC](#) [CR54NP-820KC](#) [CR54NP-8R5MC](#)
[MGDQ4-00004-P](#) [MGDU1-00016-P](#) [MHL1ECTTP18NJ](#) [MHL1JCTTD12NJ](#) [PE-51506NL](#) [PE-53601NL](#) [PE-53630NL](#) [PE-53824SNLT](#) [PE-62892NL](#) [PE-92100NL](#) [PG0434.801NLT](#) [PG0936.113NLT](#) [PM06-2N7](#) [PM06-39NJ](#) [HC2LP-R47-R](#) [HC2-R47-R](#) [HC3-2R2-R](#) [HC8-1R2-R](#)