

Schottky Barrier Diode

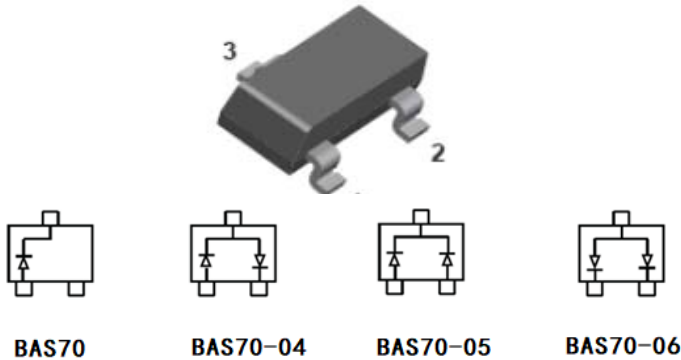

Features

- Meets MSL level 1
- Molding compound meets UL 94 V-0 flammability rating, RoHS-compliant, halogen-free
- Component in accordance to RoHS 2002/95/EC and WEEE 2002/96/EC

Mechanical Data

- **Package:** SOT-23
Molding compound meets UL 94 V-0 flammability rating, RoHS-compliant, halogen-free
- **Terminals:** Tin plated leads, solderable per J-STD-002 and JESD22-B102

Marking:

| | |
|----------|----|
| BAS70 | 73 |
| BAS70-04 | 74 |
| BAS70-05 | 75 |
| BAS70-06 | 76 |

■ Maximum Rating, (Ta=25°C Unless otherwise specified)

| Item | Symbol | Unit | Value |
|---|------------|------|-------------|
| Continuous Reverse Voltage | V_R | V | 70 |
| Forward Continuous Current | I_F | mA | 70 |
| Non-Repetitive Peak Forward Surge Current @ t = 8.3ms | I_{FSM} | A | 0.1 |
| Total Power Dissipation @ T _A =25°C | P_D | mW | 200 |
| Thermal Resistance, Junction to Ambient | R_{thJA} | °C/W | 500 |
| Operation Junction Temperature | T_J | °C | -55 to +125 |
| Storage Temperature | T_{STG} | °C | -55 to +125 |

■ Ordering Information (Example)

| PREFERRED P/N | PACKING CODE | UNIT WEIGHT(g) | MINIMUM PACKAGE(pcs) | INNER BOX QUANTITY(pcs) | OUTER CARTON QUANTITY(pcs) | DELIVERY MODE |
|---------------|--------------|-------------------|----------------------|-------------------------|----------------------------|---------------|
| BAS70 | F2 | Approximate 0.008 | 3000 | 30000 | 120000 | 7" reel |
| BAS70-04 | F2 | Approximate 0.008 | 3000 | 30000 | 120000 | 7" reel |
| BAS70-05 | F2 | Approximate 0.008 | 3000 | 30000 | 120000 | 7" reel |
| BAS70-06 | F2 | Approximate 0.008 | 3000 | 30000 | 120000 | 7" reel |



BAS70 THRU BAS70-06

■ Electrical Characteristics (Ta=25°C Unless otherwise specified)

| Item | Symbol | Unit | Conditions | Value |
|---------------------------------------|-----------------|------|---|-------|
| Maximum Instantaneous Forward Voltage | V _F | V | I _{FM} =1mA | 0.41 |
| | | | I _{FM} =15mA | 1 |
| Continuous Reverse Voltage | V _R | V | I _R =10uA | 70 |
| Maximum DC Reverse Current | I _R | uA | V _R =50V | 0.2 |
| Maximum Junction Capacitance | C _J | pF | f=1.0MHz, V _R =1.0V | 2 |
| Maximum Reverse Recovery Time | T _{rr} | ns | I _F =I _R =10mA, I _(REC) =1mA | 5 |

■ Typical Characteristics

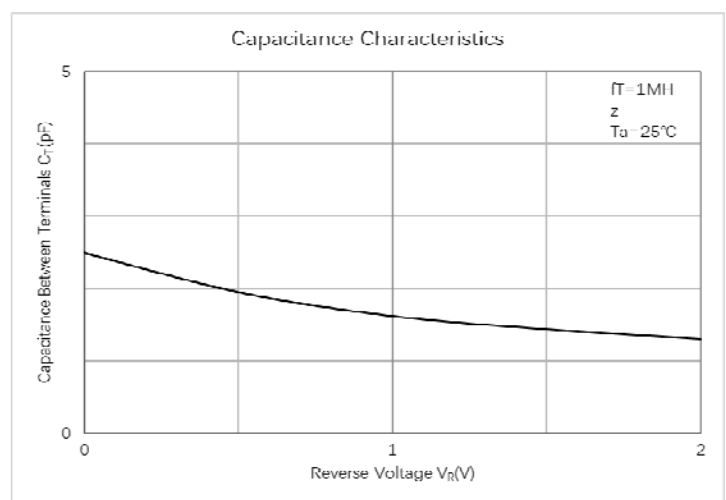
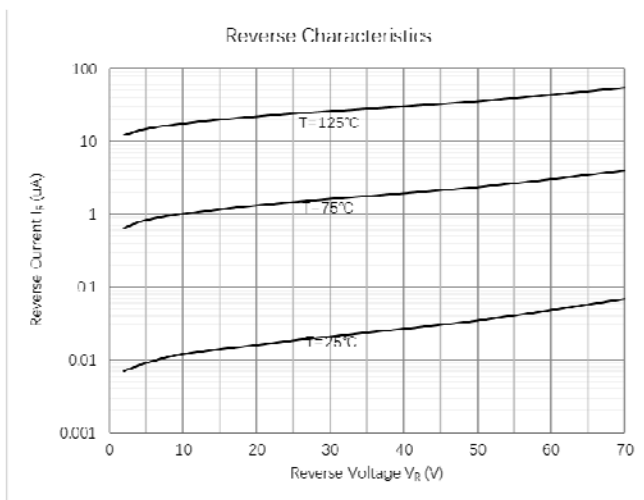
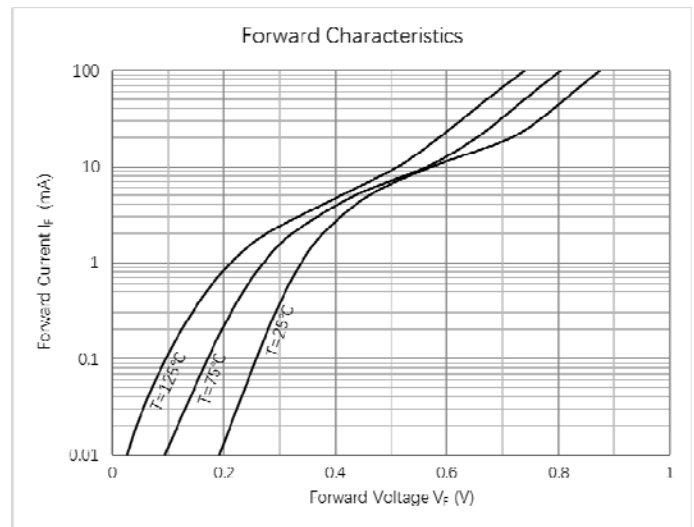
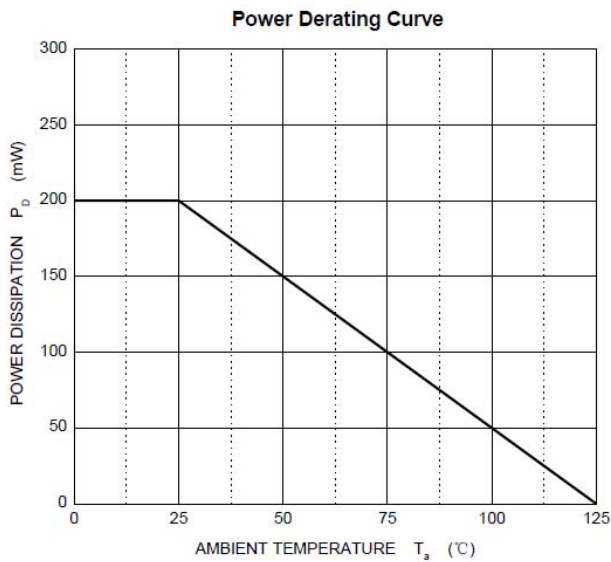



BAS70 THRU BAS70-06

■SOT-23 Package Outline Dimensions

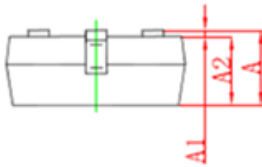
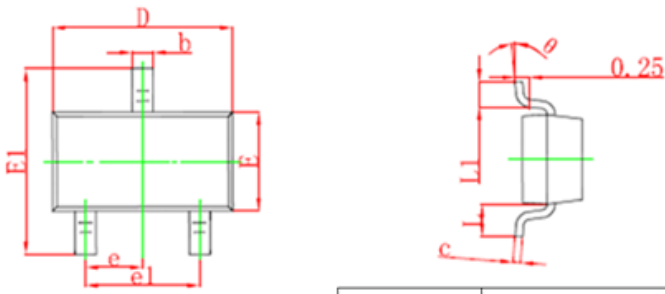

| Symbol | Dimensions In Millimeters | | Dimensions In Inches | |
|--------|---------------------------|-------|----------------------|-------|
| | Min | Max | Min | Max |
| A | 0.900 | 1.150 | 0.035 | 0.045 |
| A1 | 0.000 | 0.100 | 0.000 | 0.004 |
| A2 | 0.900 | 1.050 | 0.035 | 0.041 |
| b | 0.300 | 0.500 | 0.012 | 0.020 |
| c | 0.100 | 0.200 | 0.004 | 0.008 |
| D | 2.800 | 3.000 | 0.110 | 0.118 |
| E | 1.200 | 1.400 | 0.047 | 0.055 |
| E1 | 2.250 | 2.550 | 0.089 | 0.100 |
| e | 0.950TYP | | 0.037TYP | |
| e1 | 1.800 | 2.000 | 0.071 | 0.079 |
| L | 0.550REF | | 0.022REF | |
| L1 | 0.300 | 0.500 | 0.012 | 0.020 |
| θ | 0° | 8° | 0° | 8° |

■SOT-23Suggested Pad Layout

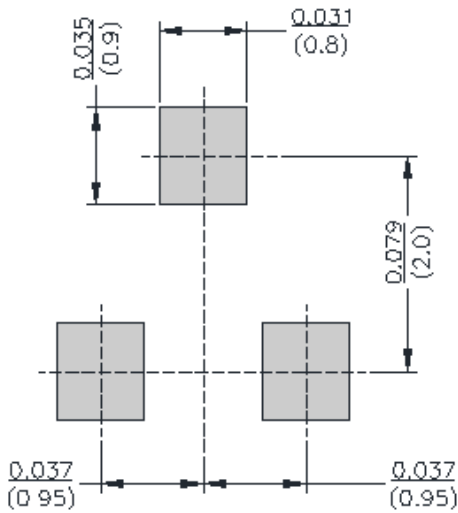



BAS70 THRU BAS70-06

Disclaimer

The information presented in this document is for reference only. Yangzhou Yangjie Electronic Technology Co., Ltd. reserves the right to make changes without notice for the specification of the products displayed herein to improve reliability, function or design or otherwise.

The product listed herein is designed to be used with ordinary electronic equipment or devices, and not designed to be used with equipment or devices which require high level of reliability and the malfunction of which would directly endanger human life (such as medical instruments, transportation equipment, aerospace machinery, nuclear-reactor controllers, fuel controllers and other safety devices), Yangjie or anyone on its behalf, assumes no responsibility or liability for any damages resulting from such improper use of sale.

This publication supersedes & replaces all information previously supplied. For additional information, please visit our website [http:// www.21yangjie.com](http://www.21yangjie.com) , or consult your nearest Yangjie's sales office for further assistance.

X-ON Electronics

Largest Supplier of Electrical and Electronic Components

Click to view similar products for [Schottky Diodes & Rectifiers](#) category:

Click to view products by [Yangjie](#) manufacturer:

Other Similar products are found below :

[MA4E2039](#) [MA4E2508M-1112](#) [MBR0530L-TP](#) [MBR10100CT-BP](#) [MBR1545CT](#) [MMBD301M3T5G](#) [RB160M-50TR](#)
[BAS16E6433HTMA1](#) [BAS 3010S-02LRH E6327](#) [BAT 54-02LRH E6327](#) [IDL02G65C5XUMA1](#) [NSR05F40QNXT5G](#) [NSVR05F40NXT5G](#)
[NTE555](#) [JANS1N6640](#) [SB07-03C-TB-H](#) [SK310-T](#) [SK33A-TP](#) [SK34B-TP](#) [SS3003CH-TL-E](#) [PDS3100Q-7](#) [GA01SHT18](#)
[CRS10I30A\(TE85L,QM](#) [MA4E2501L-1290](#) [MBRB30H30CT-1G](#) [JANTX1N5712-1](#) [SB007-03C-TB-E](#) [SK33B-TP](#) [SK35A-TP](#) [SK38B-LTP](#)
[NTE505](#) [NTSB30U100CT-1G](#) [VS-6CWQ10FNHM3](#) [CRG04\(T5L,TEMQ\)](#) [ACDBA1100LR-HF](#) [ACDBA1200-HF](#) [ACDBA240-HF](#)
[ACDBA3100-HF](#) [CDBQC0530L-HF](#) [ACDBA260LR-HF](#) [ACDBA1100-HF](#) [MA4E2502L-1246](#) [10BQ015-M3/5BT](#) [10BQ060-M3/5BT](#)
[NRVB130LSFT1G](#) [CRS08TE85LQM](#) [PMAD1108-LF](#) [B120Q-13-F](#) [1N5819T-G](#) [B0530WSQ-7-F](#)