

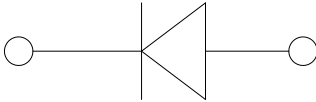

## High Efficient Rectifier

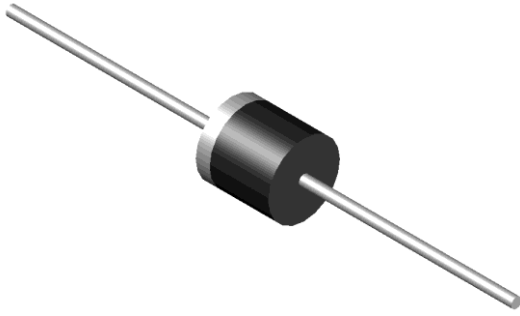

## Features

- High efficiency
- High current capability
- High Reliability
- High surge current capability
- Glass passivated chip junction
- Solder dip 275 °C max. 7 s, per JESD 22-B106

## Mechanical Data

- **Package:** R-6  
Molding compound meets UL 94 V-0 flammability rating, RoHS-compliant
- **Terminals:** Tin plated leads, solderable per J-STD-002 and JESD22-B102
- **Polarity:** Color band denotes cathode end

## ■ Maximum Ratings (Ta=25°C Unless otherwise specified)

PARAMETER	SYMBOL	UNIT	HER601G	HER602G	HER603G	HER604G	HER605G	HER606G	HER607G	HER608G
Device marking code			HER601G	HER602G	HER603G	HER604G	HER605G	HER606G	HER607G	HER608G
Repetitive Peak Reverse Voltage	$V_{RRM}$	V	50	100	200	300	400	600	800	1000
Average Forward Current @60Hz sine wave, Resistance load, Ta=65°C	$I_{F(AV)}$	A	6.0							
Forward Surge Current (Non-repetitive) @60Hz Half-sine wave, 1 cycle, Ta=25°C	$I_{FSM}$	A	200							
Storage Temperature	$T_{stg}$	°C	-55 ~+150							
Junction Temperature	$T_j$	°C	-55~+150							

## ■ Electrical Characteristics (Ta=25°C Unless otherwise specified)

PARAMETER	SYMBOL	UNIT	TEST CONDITIONS	HER601G	HER602G	HER603G	HER604G	HER605G	HER606G	HER607G	HER608G
Maximum instantaneous forward voltage drop per diode	$V_{FM}$	V	$I_{FM}=6.0A$	1.0			1.3		1.7		
Maximum DC reverse current at rated DC blocking voltage per diode	$I_{RRM1}$	μA	Ta=25°C	25							
	$I_{RRM2}$		Ta=100°C	150							
Reverse Recovery time	$t_r$	ns	$I_F=0.5A$ $I_R=1A$ $I_{RR}=0.25A$	50				75			
Typical junction capacitance	$C_j$	pF	Measured at 1MHZ and Applied Reverse Voltage of 4.0 V.D.C.	100				65			

## ■ Thermal Characteristics (Ta=25°C Unless otherwise specified)

PARAMETER	SYMBOL	UNIT	HER601G	HER602G	HER603G	HER604G	HER605G	HER606G	HER607G	HER608G
Thermal Resistance(Typical)	$R_{\theta J-A}$	°C/W	15							



# HER601G THRU HER608G

## ■ Ordering Information (Example)

PREFERRED P/N	PACKAGE CODE	UNIT WEIGHT(g)	MINIMUM PACKAGE(pcs)	INNER BOX QUANTITY(pcs)	OUTER CARTON QUANTITY(pcs)	DELIVERY MODE
HER601G~HER608G	D1	Approximate 1.95	500	500	5000	Tape
HER601G~HER608G	C1	Approximate 1.95	100	100	5000	Bulk

## ■ Characteristics (Typical)

FIG.1: Io-Ta Curve

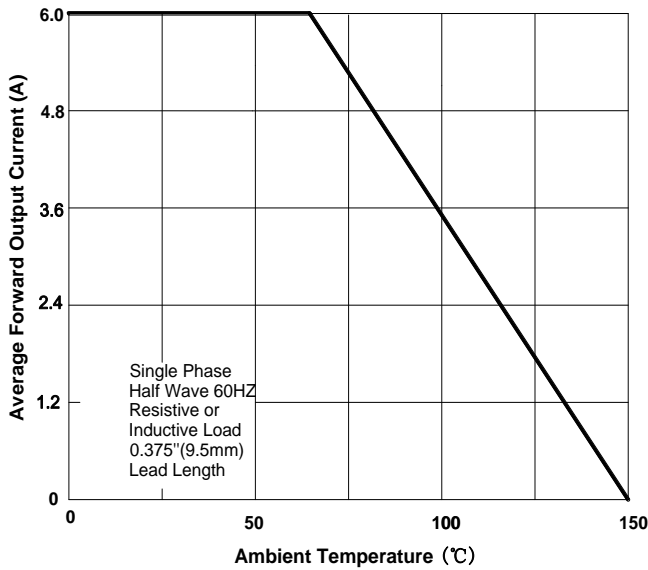

FIG.2: Forward Surge Current Capability

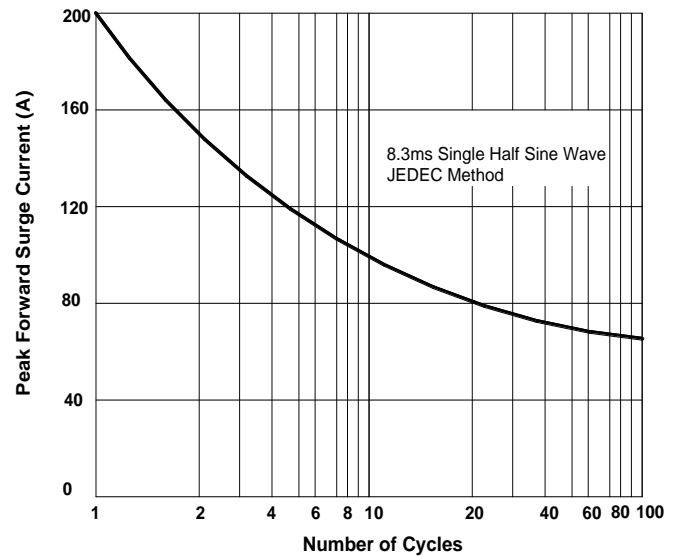

FIG.3: Forward Voltage

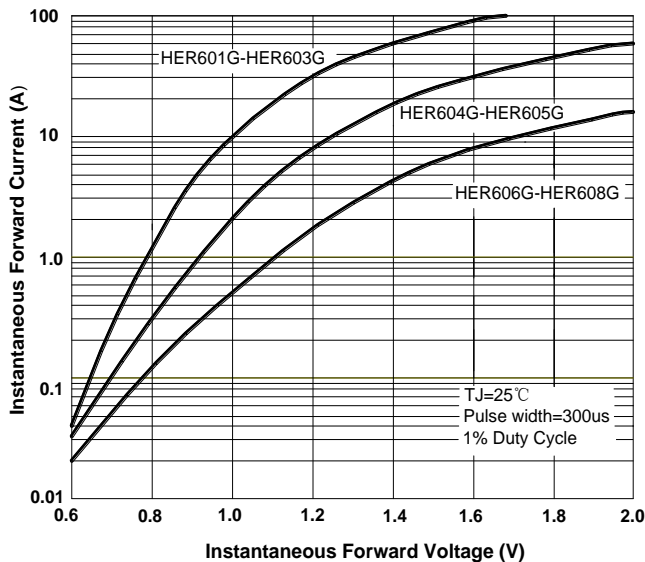
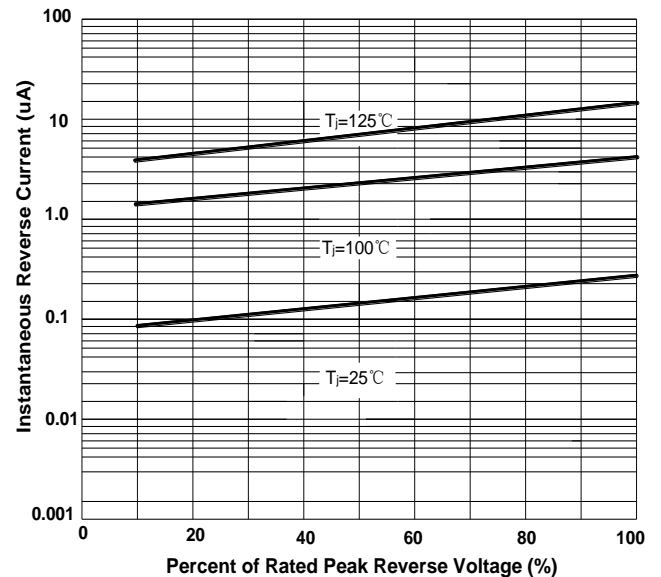

FIG.4: Typical Reverse Characteristics





# HER601G THRU HER608G

FIG.5: Diagram of circuit and Testing wave form of reverse recovery time

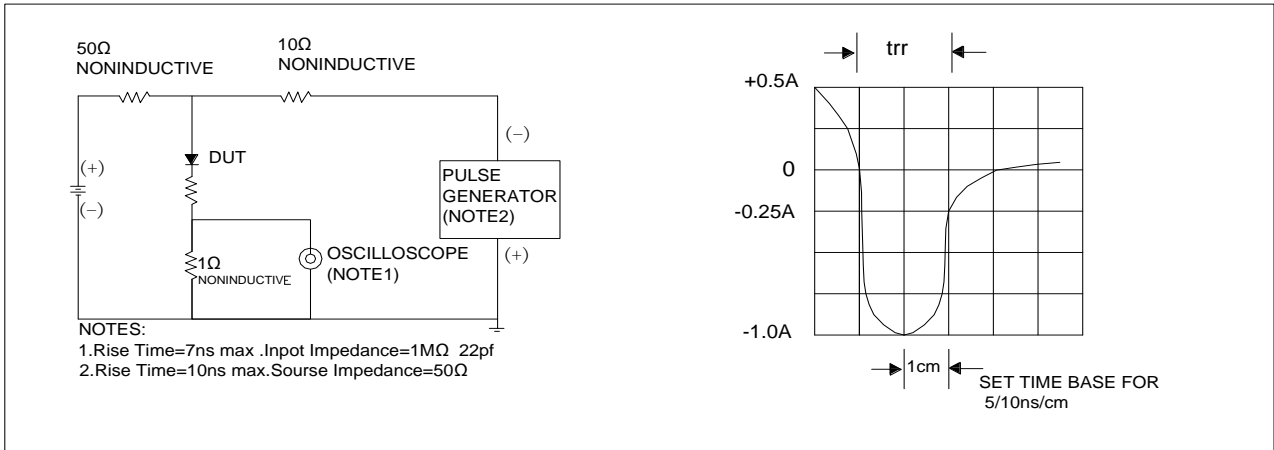

## ■ Outline Dimensions

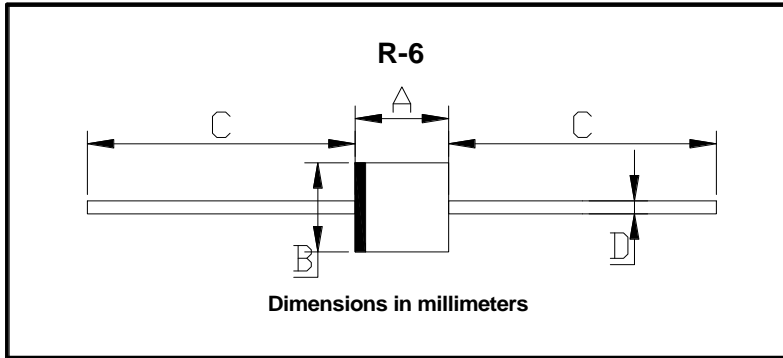

R-6		
Dim	Min	Max
A	8.60	9.10
B	8.60	9.10
C	25.4	/
D	1.20	1.32



## HER601G THRU HER608G

---

### Disclaimer

The information presented in this document is for reference only. Yangzhou Yangjie Electronic Technology Co., Ltd. reserves the right to make changes without notice for the specification of the products displayed herein to improve reliability, function or design or otherwise.

The product listed herein is designed to be used with ordinary electronic equipment or devices, and not designed to be used with equipment or devices which require high level of reliability and the malfunction of which would directly endanger human life (such as medical instruments, transportation equipment, aerospace machinery, nuclear-reactor controllers, fuel controllers and other safety devices), Yangjie or anyone on its behalf, assumes no responsibility or liability for any damages resulting from such improper use of sale.

This publication supersedes & replaces all information previously supplied. For additional information, please visit our website [http:// www.21yangjie.com](http://www.21yangjie.com) , or consult your nearest Yangjie's sales office for further assistance.

## X-ON Electronics

Largest Supplier of Electrical and Electronic Components

*Click to view similar products for [Rectifiers](#) category:*

*Click to view products by [Yangjie](#) manufacturer:*

Other Similar products are found below :

[70HFR40](#) [FR105 R0](#) [RL252-TP](#) [1N5397](#) [1N4005-TR](#) [1N4007-BP](#) [UFS120Je3/TR13](#) [20ETS12S](#) [RRE02VS6SGTR](#) [MS306](#) [A1N5404G-G](#)  
[CRF02\(T5L,TEMQ\)](#) [ACGRB207-HF](#) [CLH07\(TE16L,Q\)](#) [CLH03\(TE16L,Q\)](#) [1N5395-TP](#) [UES1302](#) [ACGRC307-HF](#) [ACEFC304-HF](#) [DZ-](#)  
[1380](#) [85HFR60](#) [40HFR60](#) [70HF120](#) [85HFR80](#) [SCF7500](#) [SM100](#) [ACGRA4001-HF](#) [SKN70/08](#) [NTE5819](#) [NTE5827](#) [NTE5828](#) [NTE5911](#)  
[NTE5915](#) [NTE6104](#) [NTE6163](#) [NTE6164](#) [NTE6165](#) [NTE6364](#) [TSD3G](#) [SET130312](#) [NRVUS110VT3G](#) [UES1106](#) [UES1306](#)  
[NRVUS240VT3G](#) [D5FE60-5063](#) [R4000GPS-TP](#) [D4015L56TP](#) [UES1306HR2](#) [FX20K120](#) [D20XB60-7101](#)