

## PNP General Purpose Amplifier

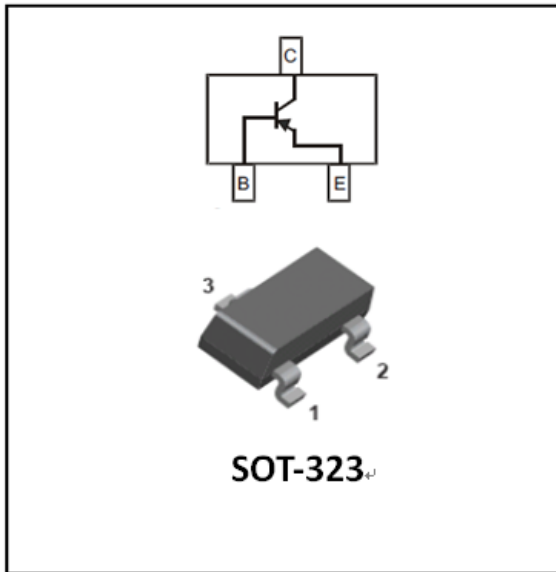

### Features

- Epoxy meets UL-94 V-0 flammability rating
- Moisture Sensitivity Level 1
- Marking: K3T

### ■ Maximum Ratings (Ta=25°C unless otherwise noted)

Item	Symbol	Unit	Conditions	Value
Collector-Base Voltage	$V_{CB0}$	V		-40
Collector-Emitter Voltage	$V_{CEO}$	V		-40
Emitter-Base Voltage	$V_{EBO}$	V		-5
Collector Current	$I_C$	A		-0.6
Collector Power Dissipation	$P_C$	W		0.2
Operation Junction Temperature	$T_j$	°C		150
Storage Temperature	$T_{stg}$	°C		-55 to +150

### ■ Electrical Characteristics (Ta=25°C unless otherwise noted)

Item	Symbol	Unit	Conditions	Min	Max
Collector-base breakdown voltage	$V_{CB0}$	V	$I_C = -100\mu A, I_E = 0$	-40	
Collector-emitter breakdown voltage	$V_{CEO}$	V	$I_C = -1mA, I_B = 0$	-40	
Emitter-base breakdown voltage	$V_{EBO}$	V	$I_E = -100\mu A, I_C = 0$	-5	
Collector-Base cut-off current	$I_{CB0}$	$\mu A$	$V_{CB} = -35V, I_E = 0$		-0.1
Collector-emitter cut-off current	$I_{CEO}$	$\mu A$	$V_{CE} = -35V, I_B = 0$		-0.1
Emitter-base cut-off current	$I_{EBO}$	$\mu A$	$V_{EB} = -4V, I_C = 0V$		-0.1
DC current gain	$h_{FE}$	V	$V_{CE} = -2V, I_C = -150mA$	100	300
Collector-emitter saturation voltage	$V_{CE(sat)}$	V	$I_C = -150mA, I_B = -15mA$		-0.4
Base-emitter saturation voltage	$V_{BE(sat)*}$	V	$I_C = -150mA, I_B = -15mA$		-0.95



## ■ Electrical Characteristics (Ta=25°C unless otherwise noted)

Item	Symbol	Unit	Conditions	Min	Max
Transition frequency	Ft	MHz	VCE=-10V, IC=-20mA, f=100MHz	200	
Delay time	td	ns	VCC=-30V, IC=-150uA VBE (off) =-2V, IB1=-15mA		15
Rise time	tr	ns			20
Storage time	ts	ns	VCC=-30V, IC=-150mA, IB1= IB2=-15mA		225
Fall time	tf	ns			30

## ■ Ordering Information (Example)

PREFERRED P/N	PACKING CODE	UNIT WEIGHT(g)	MINIMUM PACKAGE(pcs)	INNER BOX QUANTITY(pcs)	OUTER CARTON QUANTITY(pcs)	DELIVERY MODE
MMST4403	F2	Approximate 0.005	3000	30000	120000	7" reel

## ■ Characteristics (Typical)

Static Characteristic

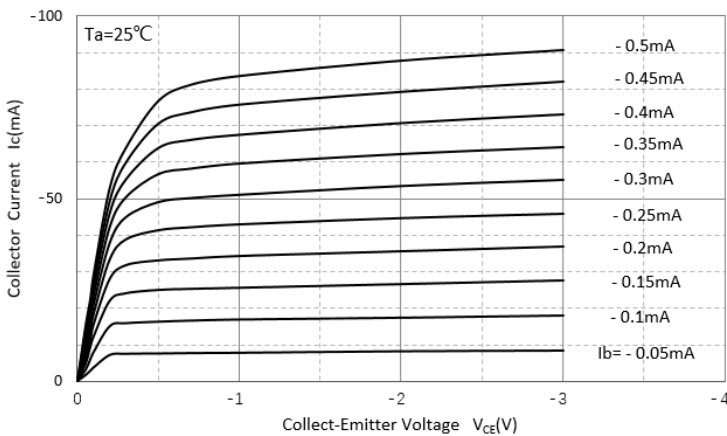

DC Current Gain

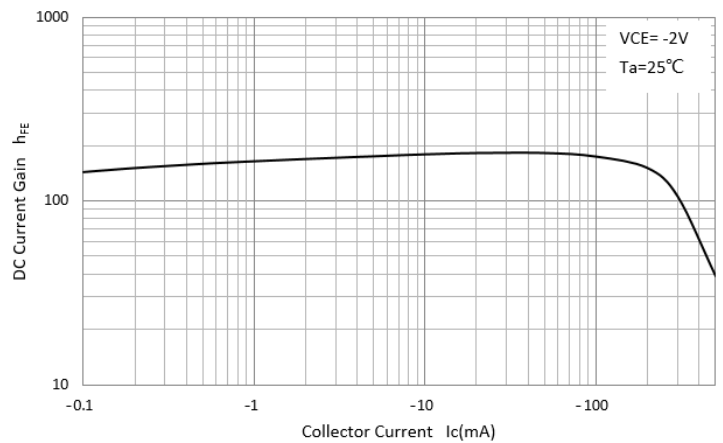

Collector-Emitter Saturation Voltage

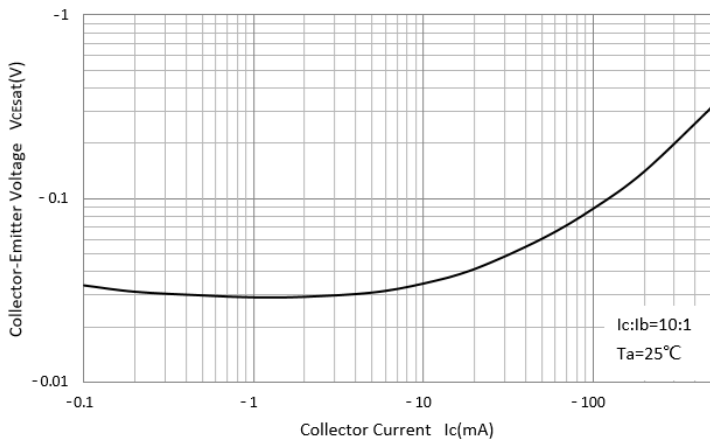

Base-Emitter Saturation Voltage

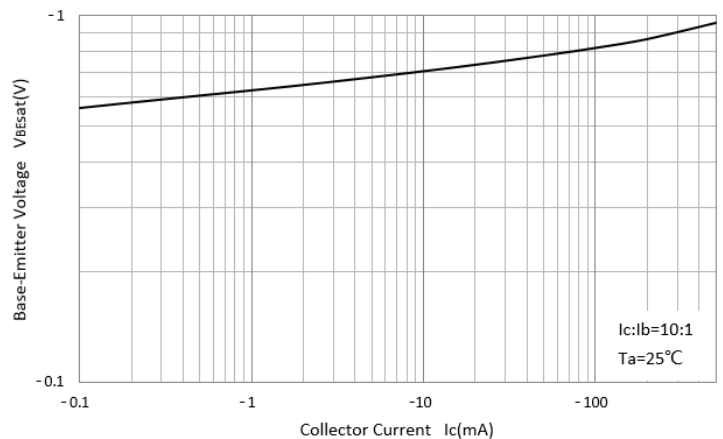

Base-Emitter On Voltage

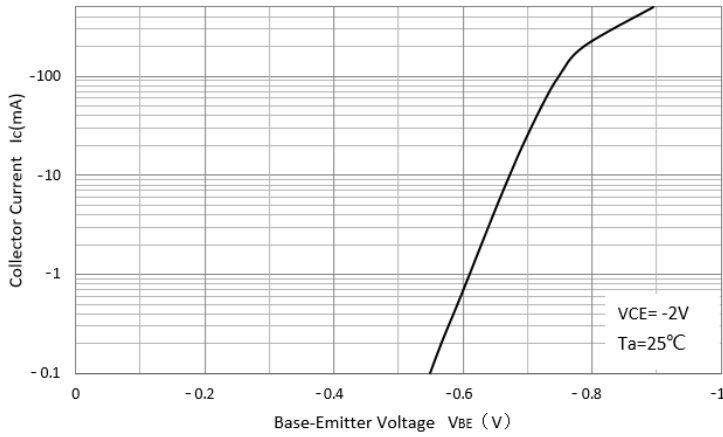

$C_{ob}/C_{ib}-V_{CB}/V_{EB}$

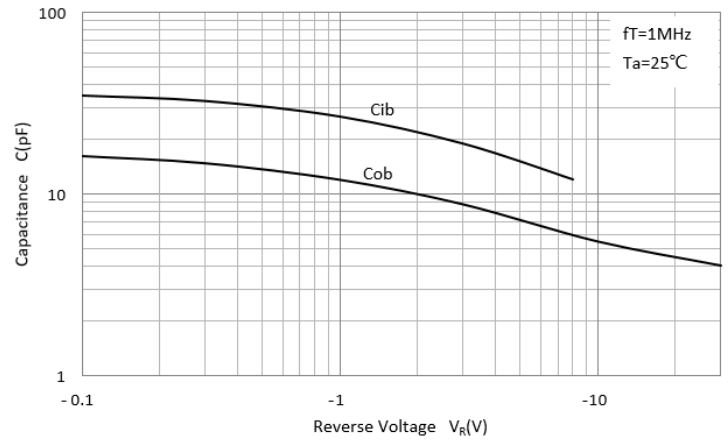

## ■SOT-323 Package Outline Dimensions

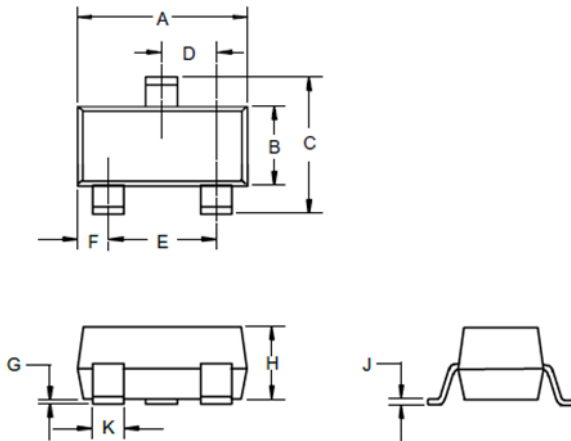

DIMENSIONS					
DIM	INCHES		MM		NOTE
	MIN	MAX	MIN	MAX	
A	.071	.087	1.80	2.20	
B	.045	.053	1.15	1.35	
C	.083	.096	2.10	2.45	
D	.026 Nominal		0.65Nominal		
E	.047	.055	1.20	1.40	
F	.012	.016	.30	.40	
G	.000	.004	.000	.100	
H	.035	.039	.90	1.00	
J	.004	.010	.100	.250	
K	.006	.016	.15	.40	

## ■SOT-323 Soldering Footprint

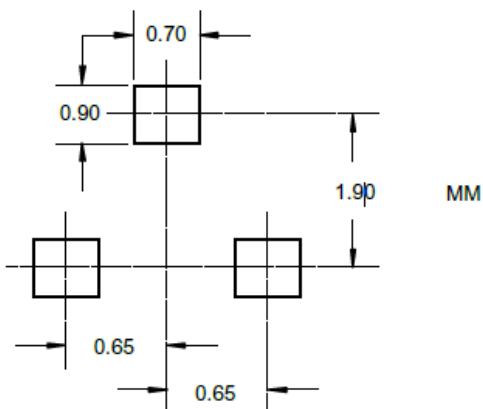



---

**Disclaimer**

The information presented in this document is for reference only. Yangzhou Yangjie Electronic Technology Co., Ltd. reserves the right to make changes without notice for the specification of the products displayed herein to improve reliability, function or design or otherwise.

The product listed herein is designed to be used with ordinary electronic equipment or devices, and not designed to be used with equipment or devices which require high level of reliability and the malfunction of which would directly endanger human life (such as medical instruments, transportation equipment, aerospace machinery, nuclear-reactor controllers, fuel controllers and other safety devices), Yangjie or anyone on its behalf, assumes no responsibility or liability for any damages resulting from such improper use of sale.

This publication supersedes & replaces all information previously supplied. For additional information, please visit our website [http:// www.21yangjie.com](http://www.21yangjie.com) , or consult your nearest Yangjie's sales office for further assistance.

## X-ON Electronics

Largest Supplier of Electrical and Electronic Components

*Click to view similar products for [Bipolar Transistors - BJT category](#):*

*Click to view products by [Yangjie manufacturer](#):*

Other Similar products are found below :

[BC559C](#) [MCH4017-TL-H](#) [MMBT-2369-TR](#) [BC546/116](#) [NJVMJD148T4G](#) [NTE16](#) [NTE195A](#) [IMX9T110](#) [2N4401-A](#) [2N4403](#) [2N6728](#)  
[2SA1419T-TD-H](#) [2SA2126-E](#) [2SB1204S-TL-E](#) [FMC5AT148](#) [2N2369ADCSM](#) [2N2907A](#) [2N3904-NS](#) [2N5769](#) [2SC4618TLN](#) [CPH6501-](#)  
[TL-E](#) [MCH4021-TL-E](#) [Jantx2N5416](#) [US6T6TR](#) [BAX18/A52R](#) [BC556/112](#) [IMZ2AT108](#) [MMST8098T146](#) [UMX21NTR](#) [MCH6102-TL-E](#)  
[TTA1452B,S4X\(S](#) [2N3879](#) [NTE13](#) [NTE282](#) [NTE323](#) [NTE350](#) [NTE81](#) [JANTX2N2920L](#) [JANTX2N3735](#) [JANSR2N2222AUB](#)  
[CMLT3946EG TR](#) [SNSS40600CF8T1G](#) [CMLT3906EG TR](#) [GRP-DATA-JANS2N2907AUB](#) [GRP-DATA-JANS2N2222AUA](#)  
[MMDT3946FL3-7](#) [2N4240](#) [MSB30KH-13](#) [2N2221AUB](#) [2SD1815T-TL-E](#)