

## N-Channel Enhancement Mode Field Effect Transistor

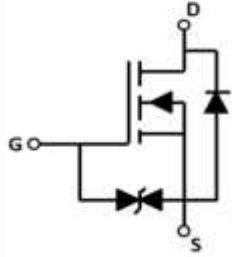

Top View

**SOT-23**

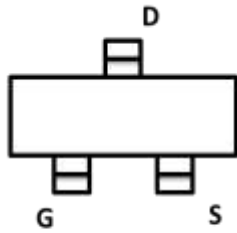

### Product Summary

- $V_{DS}$  20V
- $I_D$  0.9A
- $R_{DS(ON)}$  ( at  $V_{GS}=4.5V$  ) <250 mohm
- $R_{DS(ON)}$  ( at  $V_{GS}=2.5V$  ) <350 mohm
- ESD Protected Up to 4.0KV (HBM)

### General Description

- Trench Power LV MOSFET technology
- High Power and current handling capability

### Applications

- Interfacing switching
- Load/Power switching
- Logic Level shift

### ■ Absolute Maximum Ratings ( $T_A=25^\circ C$ unless otherwise noted)

Parameter	Symbol	Limit	Unit
Drain-source Voltage	$V_{DS}$	20	V
Gate-source Voltage	$V_{GS}$	$\pm 12$	V
Drain Current	$I_D$	$T_A=25^\circ C$ @ Steady State	0.9
		$T_A=70^\circ C$ @ Steady State	0.7
Pulsed Drain Current <sup>A</sup>	$I_{DM}$	3.5	A
Total Power Dissipation @ $T_A=25^\circ C$	$P_D$	0.35	W
Thermal Resistance Junction-to-Ambient @ Steady State	$R_{\theta JA}$	357	$^\circ C/W$
Junction and Storage Temperature Range	$T_J, T_{STG}$	-55~+150	$^\circ C$

### ■ Ordering Information (Example)

PREFERRED P/N	PACKING CODE	Marking	MINIMUM PACKAGE(pcs)	INNER BOX QUANTITY(pcs)	OUTER CARTON QUANTITY(pcs)	DELIVERY MODE
YJL3134K	F2	34K.	3000	30000	120000	7" reel



# YJL3134K

## ■ Electrical Characteristics (T<sub>J</sub>=25°C unless otherwise noted)

Parameter	Symbol	Conditions	Min	Typ	Max	Units
<b>Static Parameter</b>						
Drain-Source Breakdown Voltage	BV <sub>DSS</sub>	V <sub>GS</sub> =0V, I <sub>D</sub> =250μA	20			V
Zero Gate Voltage Drain Current	I <sub>DSS</sub>	V <sub>DS</sub> =20V, V <sub>GS</sub> =0V			1	μA
Gate-Body Leakage Current	I <sub>GSS</sub>	V <sub>GS</sub> = ±10V, V <sub>DS</sub> =0V		2.5	±10	μA
		V <sub>GS</sub> = ±8V, V <sub>DS</sub> =0V		500	±2000	nA
Gate Threshold Voltage	V <sub>GS(th)</sub>	V <sub>DS</sub> =V <sub>GS</sub> , I <sub>D</sub> =250μA	0.35	0.75	1.1	V
Static Drain-Source On-Resistance	R <sub>D(S)(ON)</sub>	V <sub>GS</sub> =4.5V, I <sub>D</sub> =0.5A		120	250	mΩ
		V <sub>GS</sub> =2.5V, I <sub>D</sub> =0.3A		160	350	
Diode Forward Voltage <sup>C</sup>	V <sub>SD</sub>	I <sub>S</sub> =0.9A, V <sub>GS</sub> =0V			1.2	V
Maximum Body-Diode Continuous Current	I <sub>S</sub>				0.9	A
<b>Dynamic Parameters<sup>B</sup></b>						
Input Capacitance	C <sub>iss</sub>	V <sub>DS</sub> =10V, V <sub>GS</sub> =0V, f=1MHZ		56		pF
Output Capacitance	C <sub>oss</sub>			20		
Reverse Transfer Capacitance	C <sub>rss</sub>			2.5		
<b>Switching Parameters<sup>B</sup></b>						
Total Gate Charge	Q <sub>g</sub>	V <sub>GS</sub> =4.5V, V <sub>DS</sub> =10V, I <sub>D</sub> =0.9A		1		nC
Gate Source Charge	Q <sub>gs</sub>			0.28		
Gate Drain Charge	Q <sub>gd</sub>			0.22		
Reverse Recovery Charge	Q <sub>rr</sub>	I <sub>F</sub> =0.5A, di/dt=20A/us		0.4		ns
Reverse Recovery Time	t <sub>rr</sub>			14.4		
Turn-on Delay Time	t <sub>D(on)</sub>	V <sub>GS</sub> =4.5V, V <sub>DD</sub> =10V, R <sub>G</sub> =10Ω, I <sub>D</sub> =500mA		2		ns
Turn-on Rise Time	t <sub>r</sub>			18.8		
Turn-off Delay Time	t <sub>D(off)</sub>			10		
Turn-off Fall Time	t <sub>f</sub>			23		

A. Repetitive Rating: Pulse width limited by maximum junction temperature.

B. These parameters have no way to verify.

C. Pulse Test: Pulse Width ≤ 300us, Duty Cycle ≤ 0.5%.



■ Typical Performance Characteristics

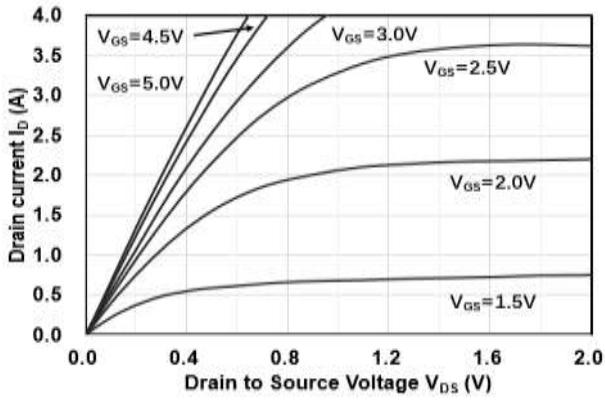

Figure1. Output Characteristics

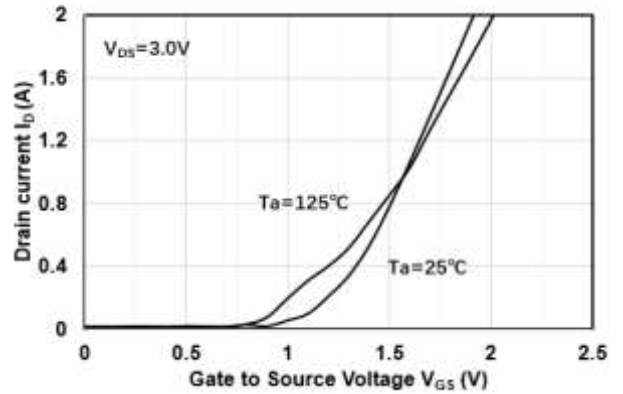

Figure2. Transfer Characteristics

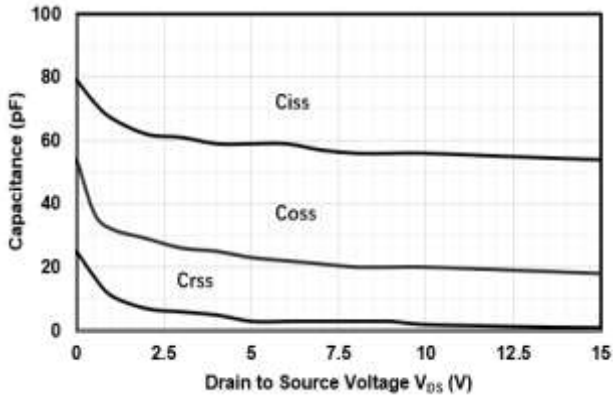

Figure3. Capacitance Characteristics

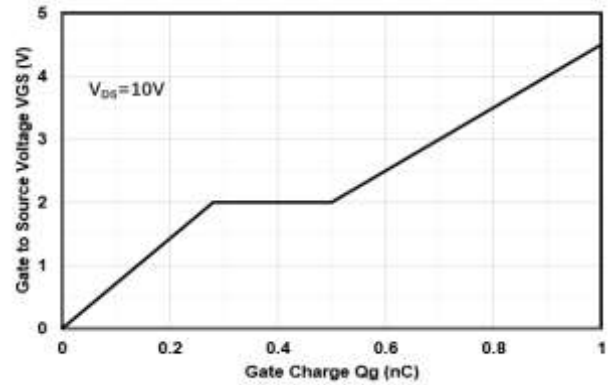

Figure4. Gate Charge

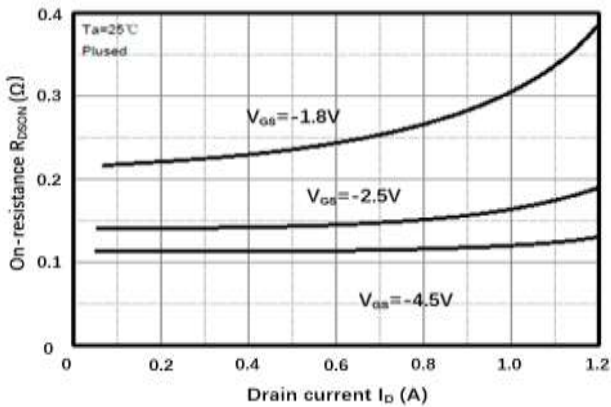

Figure5. Drain-Source on Resistance

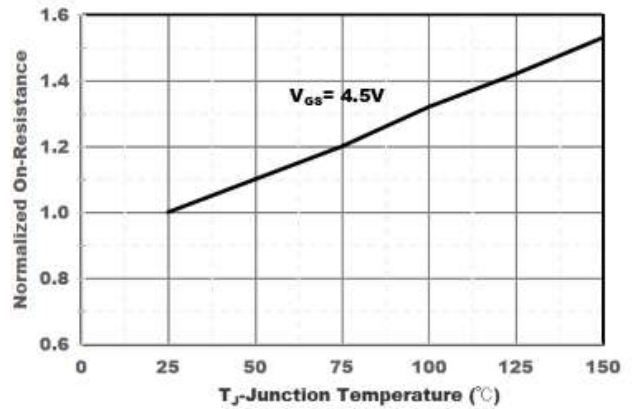

Figure6. Drain-Source on Resistance



# YJL3134K

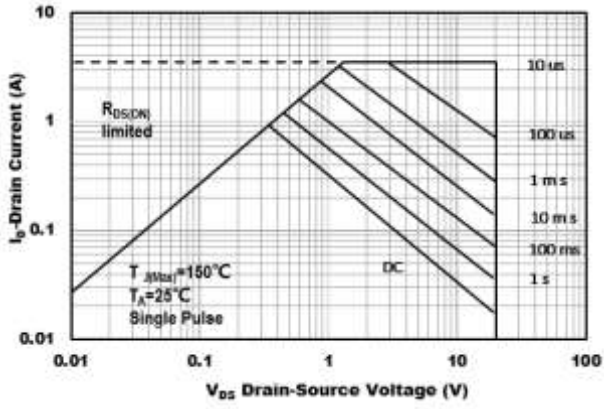

Figure7. Safe Operation Area

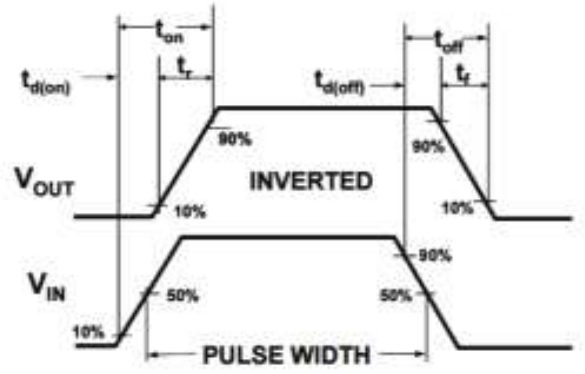
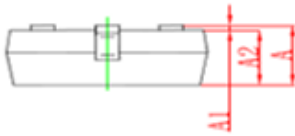
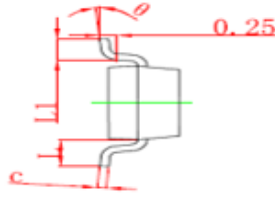
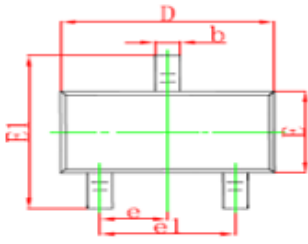

Figure8. Switching wave



# YJL3134K

## ■SOT-23 Package information



Symbol	Dimensions in Millimeter		Dimensions in Inches	
	Min	Max	Min	Max
A	0.900	1.150	0.035	0.045
A1	0.000	0.100	0.000	0.004
A2	0.900	1.050	0.035	0.041
b	0.300	0.500	0.012	0.020
c	0.100	0.200	0.004	0.008
D	2.800	3.000	0.110	0.118
E	1.200	1.400	0.047	0.055
E1	2.250	2.550	0.089	0.100
e	0.950Type		0.037Type	
e1	1.800	2.000	0.071	0.079
L	0.550REF		0.220REF	
L1	0.300	0.500	0.012	0.020
$\theta$	0°	8°	0°	8°

## ■SOT-23 Suggested Pad Layout

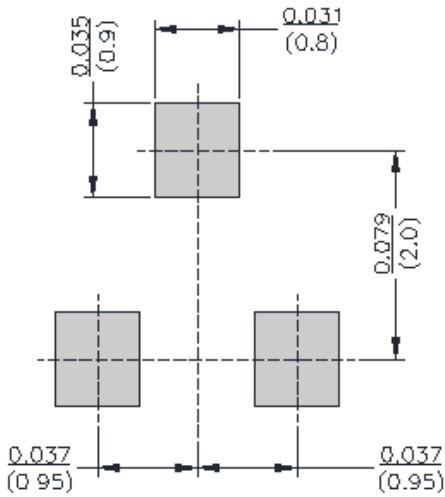



## YJL3134K

---

### Disclaimer

The information presented in this document is for reference only. Yangzhou Yangjie Electronic Technology Co., Ltd. reserves the right to make changes without notice for the specification of the products displayed herein to improve reliability, function or design or otherwise.

The product listed herein is designed to be used with ordinary electronic equipment or devices, and not designed to be used with equipment or devices which require high level of reliability and the malfunction of which would directly endanger human life (such as medical instruments, transportation equipment, aerospace machinery, nuclear-reactor controllers, fuel controllers and other safety devices), Yangjie or anyone on its behalf, assumes no responsibility or liability for any damages resulting from such improper use of sale.

This publication supersedes & replaces all information previously supplied. For additional information, please visit our website [http:// www.21yangjie.com](http://www.21yangjie.com) , or consult your nearest Yangjie's sales office for further assistance.

## X-ON Electronics

Largest Supplier of Electrical and Electronic Components

*Click to view similar products for [MOSFET](#) category:*

*Click to view products by [Yangjie](#) manufacturer:*

Other Similar products are found below :

[614233C](#) [648584F](#) [MCH3443-TL-E](#) [MCH6422-TL-E](#) [FDPF9N50NZ](#) [FW216A-TL-2W](#) [FW231A-TL-E](#) [APT5010JVR](#) [NTNS3A92PZT5G](#)  
[IRF100S201](#) [JANTX2N5237](#) [2SK2464-TL-E](#) [2SK3818-DL-E](#) [FCA20N60\\_F109](#) [FDZ595PZ](#) [STD6600NT4G](#) [FSS804-TL-E](#) [2SJ277-DL-E](#)  
[2SK1691-DL-E](#) [2SK2545\(Q,T\)](#) [D2294UK](#) [405094E](#) [423220D](#) [MCH6646-TL-E](#) [TPCC8103,L1Q\(CM](#) [367-8430-0972-503](#) [VN1206L](#)  
[424134F](#) [026935X](#) [051075F](#) [SBVS138LT1G](#) [614234A](#) [715780A](#) [NTNS3166NZT5G](#) [751625C](#) [873612G](#) [IRF7380TRHR](#)  
[IPS70R2K0CEAKMA1](#) [RJK60S3DPP-E0#T2](#) [RJK60S5DPK-M0#T0](#) [APT5010JVFR](#) [APT12031JFLL](#) [APT12040JVR](#) [DMN3404LQ-7](#)  
[NTE6400](#) [JANTX2N6796U](#) [JANTX2N6784U](#) [JANTXV2N5416U4](#) [SQM110N05-06L-GE3](#) [SIHF35N60E-GE3](#)