

■ NPN Transistors

■ Features

- Power switching applications

■ Marking

Marking	8D
---------	----

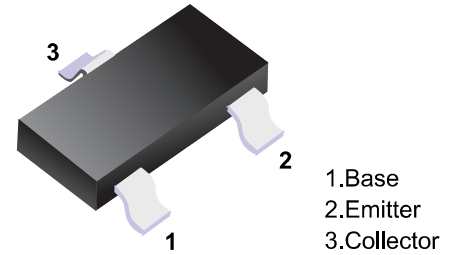

■ Simplified outline(SOT-23)

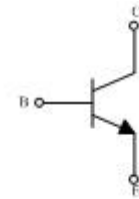

■ Absolute Maximum Ratings Ta = 25°C

Symbol	Parameter	Value	Units
VCBO	Collector-Base Voltage	800	V
VCEO	Collector-Emitter Voltage	500	V
VEBO	Emitter-Base Voltage	9	V
IC	Collector Current -Continuous	0.2	A
PC	Collector Power Dissipation	0.5	W
Tj	Junction Temperature	150	°C
Tstg	Storage Temperature	-55-150	°C

■ Electrical Characteristics Ta = 25°C

Parameter	Symbol	Test conditions	MIN	TYP	MAX	UNIT
Collector-base breakdown voltage	V(BR)CBO	IC= 100μA, IE=0	800			V
Collector-emitter breakdown voltage	V(BR)CEO	IC= 1mA, IB=0	500			V
Emitter-base breakdown voltage	V(BR)EBO	IE=100μA, IC=0	9			V
Collector cut-off current	ICBO	VCB=600V, IE=0			1	μA
Collector cut-off current	ICEO	VCE=400V, IB=0			10	μA
Emitter cut-off current	IEBO	VEB=9V, IC=0			1	μA
DC current gain	hFE	VCE=20V, IC= 20mA	8			
DC current gain	hFE	VCE=5V, IC= 1mA	8		30	
Collector-emitter saturation voltage	VCE(sat)	IC=100mA, IB= 20mA			0.5	V
Base-emitter saturation voltage	VBE(sat)	IC=100mA, IB= 20mA			1.2	V

■ Classification of hfe(1)

Range	8-15	15-20	20-25	25-30
-------	------	-------	-------	-------

■ Typical Characteristics

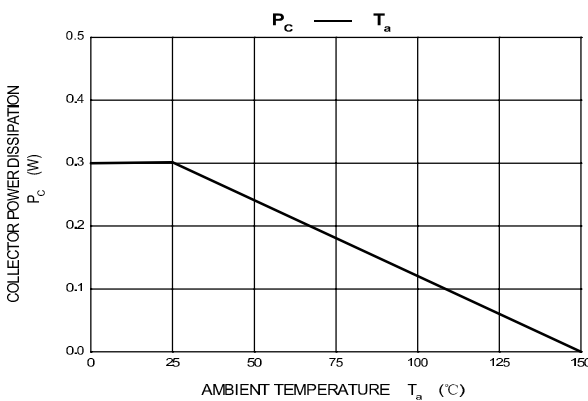
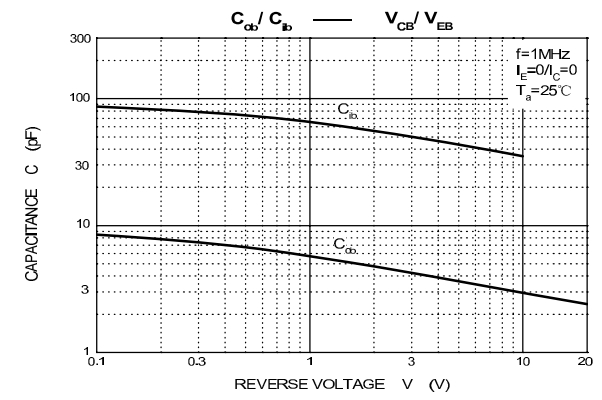
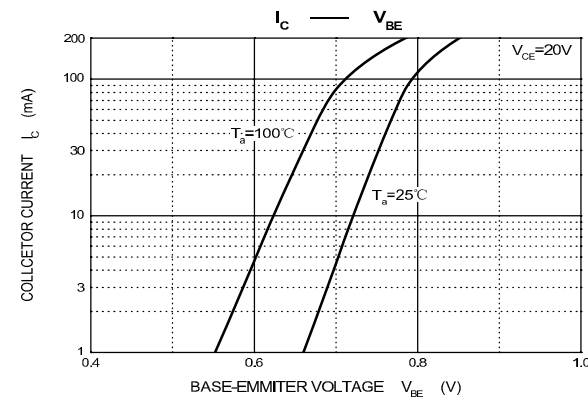
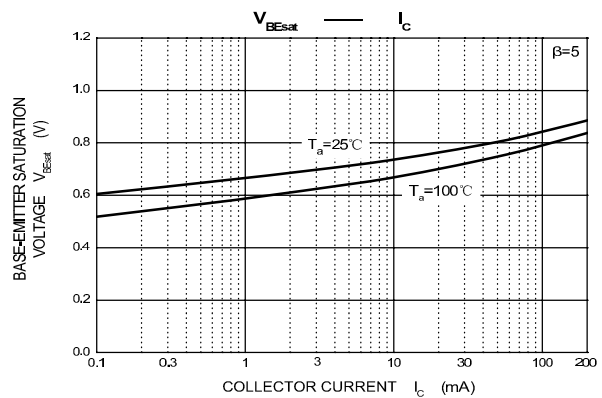
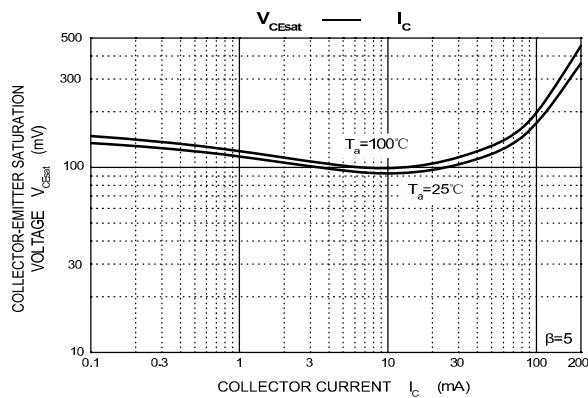
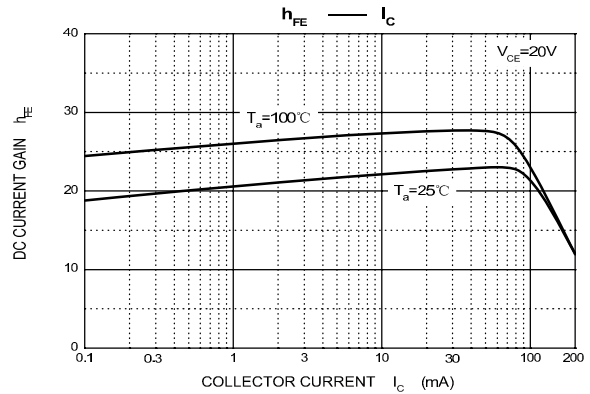
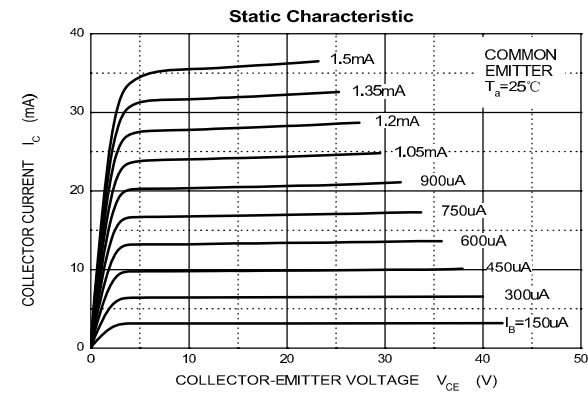

Package Outline

SOT-23

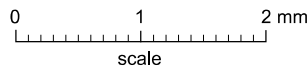
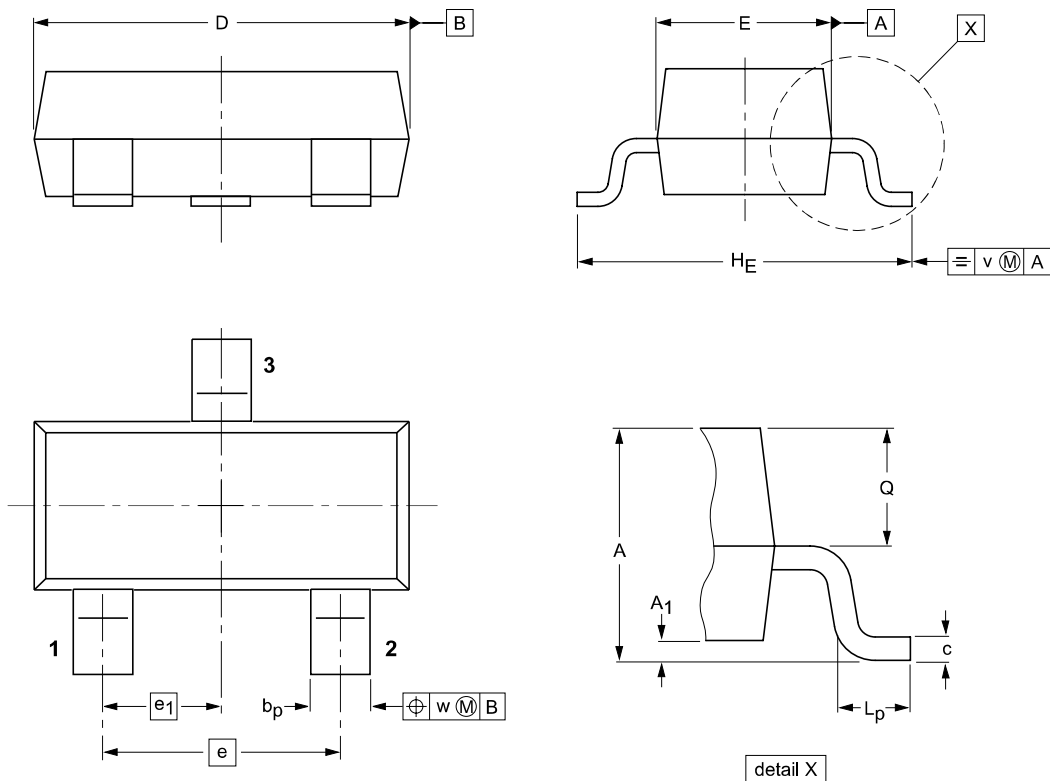

DIMENSIONS (mm are the original dimensions)

UNIT	A	A ₁ max.	b _p	c	D	E	e	e ₁	H _E	L _p	Q	v	w
mm	1.1 0.9	0.1	0.48 0.38	0.15 0.09	3.0 2.8	1.4 1.2	1.9	0.95	2.5 2.1	0.45 0.15	0.55 0.45	0.2	0.1

Summary of Packing Options

Package	Packing Description	Packing Quantity	Industry Standard
SOT-23	Tape/Reel, 7" reel	3000	EIA-481-1

X-ON Electronics

Largest Supplier of Electrical and Electronic Components

Click to view similar products for [Bipolar Transistors - BJT category](#):

Click to view products by [YFW Electronics manufacturer](#):

Other Similar products are found below :

[BC559C](#) [MCH4017-TL-H](#) [MMBT-2369-TR](#) [BC546/116](#) [NJVMJD148T4G](#) [NTE16](#) [NTE195A](#) [IMX9T110](#) [2N4401-A](#) [2N4403](#) [2N6728](#)
[2SA1419T-TD-H](#) [2SA2126-E](#) [2SB1204S-TL-E](#) [FMC5AT148](#) [2N2369ADCSM](#) [2N2907A](#) [2N3904-NS](#) [2N5769](#) [2SC4618TLN](#) [CPH6501-](#)
[TL-E](#) [MCH4021-TL-E](#) [Jantx2N5416](#) [US6T6TR](#) [BAX18/A52R](#) [BC556/112](#) [IMZ2AT108](#) [MMST8098T146](#) [UMX21NTR](#) [MCH6102-TL-E](#)
[TTA1452B,S4X\(S](#) [2N3879](#) [NTE13](#) [NTE282](#) [NTE323](#) [NTE350](#) [NTE81](#) [JANTX2N2920L](#) [JANTX2N3735](#) [JANSR2N2222AUB](#)
[CMLT3946EG TR](#) [SNSS40600CF8T1G](#) [CMLT3906EG TR](#) [GRP-DATA-JANS2N2907AUB](#) [GRP-DATA-JANS2N2222AUA](#)
[MMDT3946FL3-7](#) [2N4240](#) [MSB30KH-13](#) [2N2221AUB](#) [2SD1815T-TL-E](#)