

■ Switching Diodes

■ Features

- Small plastic SMD package.
- High switching speed: max.4 ns.
- Repetitive peak forward current: max.450 mA.

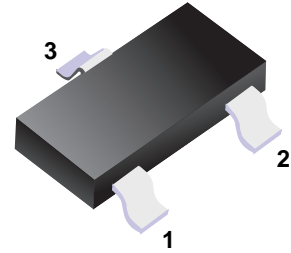

■ Simplified outline(SOT-23)

■ Marking

Marking	A4
---------	----

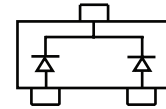

■ Absolute Maximum Ratings Ta = 25°C

Parameter	Symbol	Rating	Unit
Repetitive peak reverse voltage	VRRM	85	V
Continuous reverse voltage	VR	75	V
Continuous forward current(single diode loaded *) (double diode loaded *)	IF	215 125	mA
Repetitive peak forward current	IFRM	450	mA
Non-repetitive peak forward current Tj=25 °C t=1 μs t=1ms t=1s	IFSM	4	A
		1	
		0.5	
power dissipation *	PD	250	mW
Thermal resistance from junction to tie-point	Rth j-tp	360	K/W
Thermal resistance from junction to ambient *	Rth j-a	500	K/W
Junction Temperature	Tj	150	°C
Storage Temperature Range	Tstg	-65 to +150	°C

\* Device mounted on an FR4 printed-circuit board.

■ Electrical Characteristics Ta = 25°C

Parameter	Symbol	Test conditions	Max	Unit
Forward voltage	VF	IF = 1 mA	715	mV
		IF = 10 mA	855	mV
		IF = 50 mA	1	V
		IF = 150 mA	1.25	V
Reverse current	IR	VR = 75 V	1	μA
		VR = 25 V; Tj = 150 °C	30	
		VR = 75 V; Tj = 150 °C	50	
Diode capacitance	Cd	VR = 0 V, f = 1 MHz	1.5	pF
Reverse recovery time	trr	when switched from IF = 10 mA to IR = 10 mA; RL = 100 Ω; measured at IR = 1 mA	4	nS
Forward recovery voltage	Vfr	IF = 10 mA, tr = 20 ns	1.75	V

■ Typical Characteristics

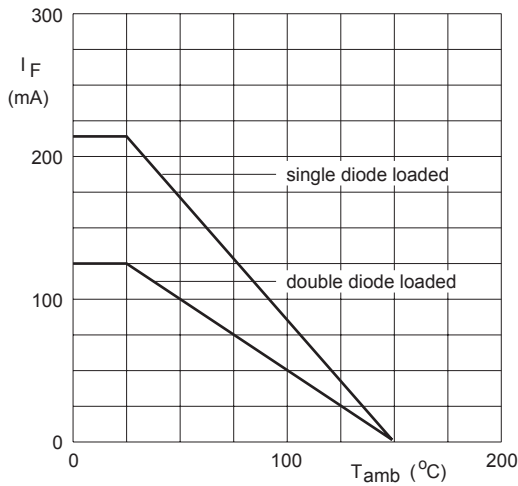

Device mounted on an FR4 printed-circuit board.

Fig.2 Maximum permissible continuous forward current as a function of ambient temperature.

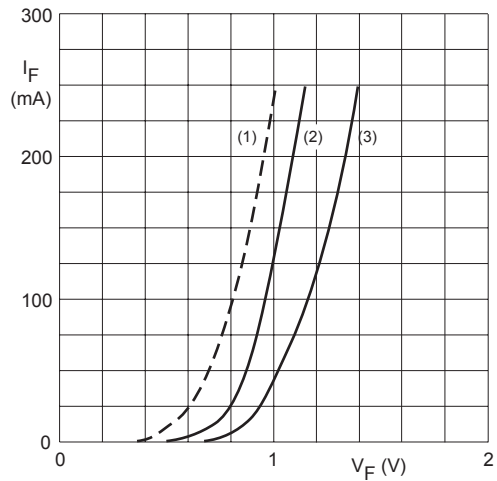

- (1)  $T_j = 150$  °C; typical values.
- (2)  $T_j = 25$  °C; typical values.
- (3)  $T_j = 25$  °C; maximum values.

Fig.3 Forward current as a function of forward voltage.

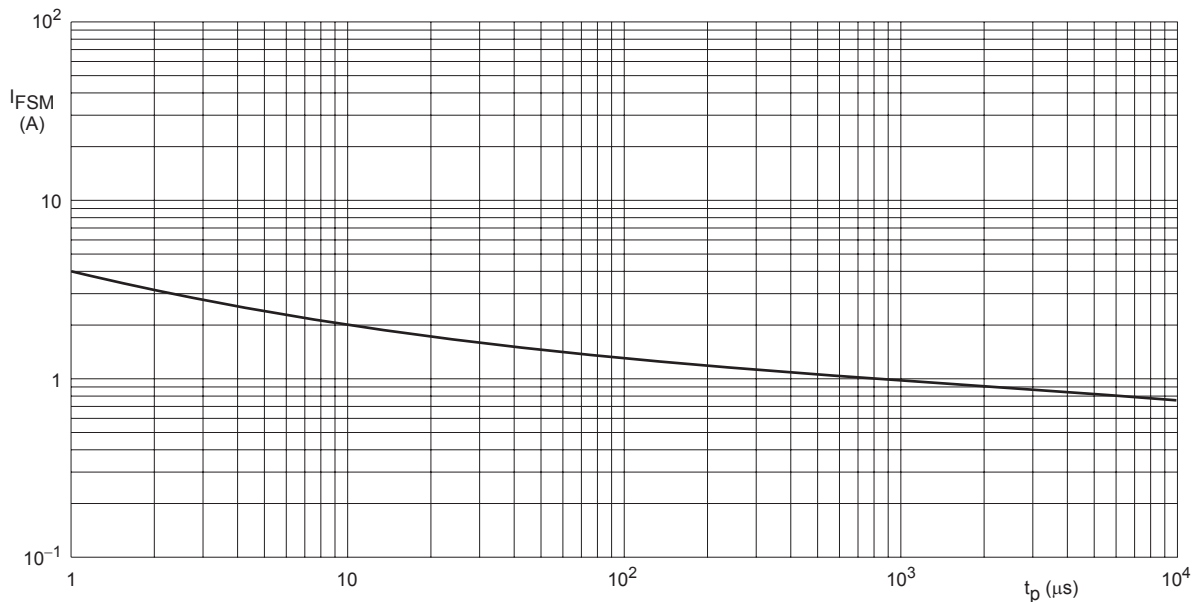

Based on square wave currents.  
 $T_j = 25$  °C prior to surge.

Fig.4 Maximum permissible non-repetitive peak forward current as a function of pulse duration.

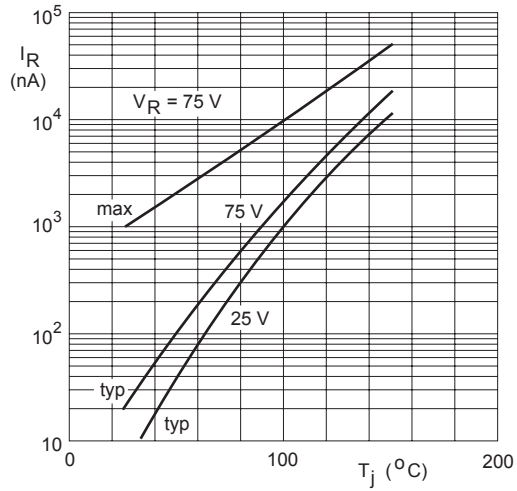
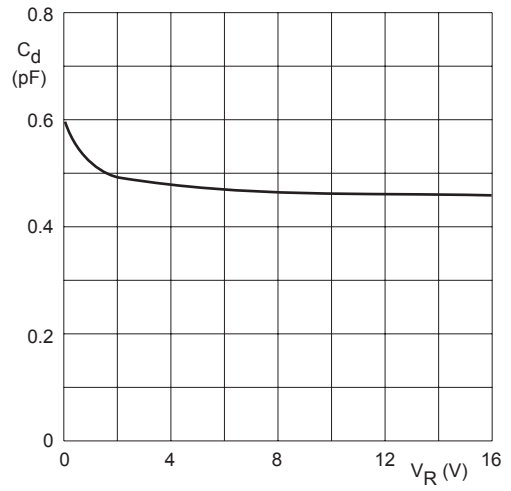

Fig.5 Reverse current as a function of junction temperature.



$f = 1\text{ MHz}$ ;  $T_j = 25\text{ }^{\circ}\text{C}$ .

Fig.6 Diode capacitance as a function of reverse voltage; typical values.

**Package Outline**

**SOT-23**

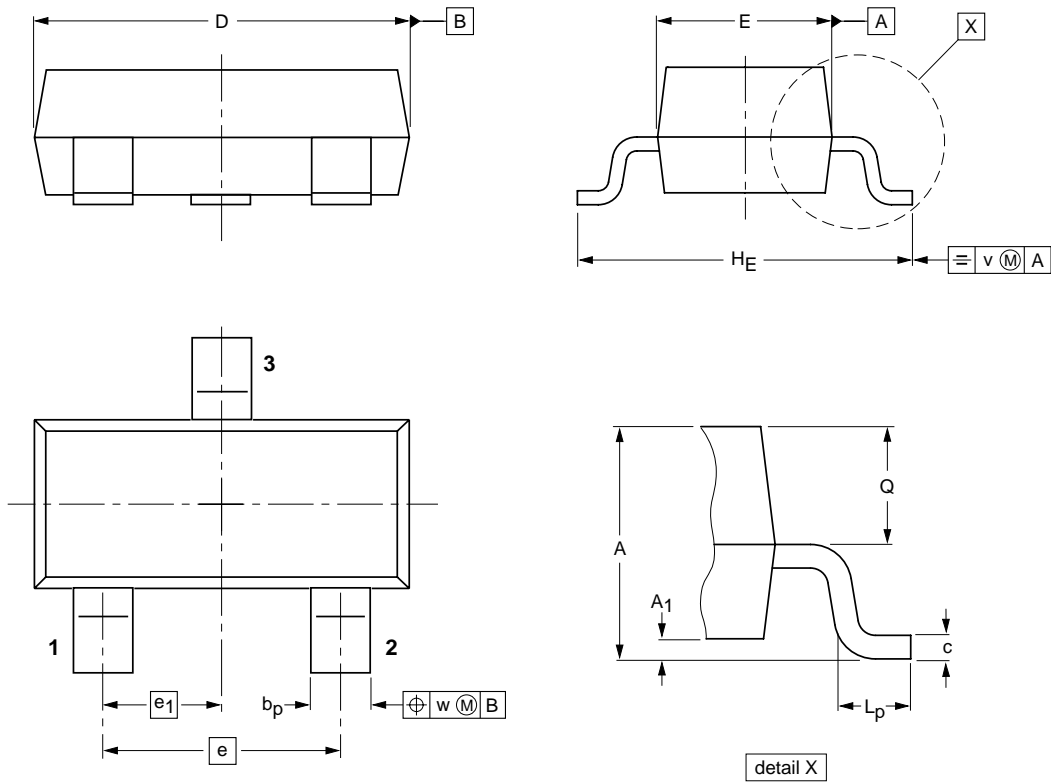

**DIMENSIONS (mm are the original dimensions)**

UNIT	A	A <sub>1</sub> max.	b <sub>p</sub>	c	D	E	e	e <sub>1</sub>	H <sub>E</sub>	L <sub>p</sub>	Q	v	w
mm	1.1 0.9	0.1	0.48 0.38	0.15 0.09	3.0 2.8	1.4 1.2	1.9	0.95	2.5 2.1	0.45 0.15	0.55 0.45	0.2	0.1

**Summary of Packing Options**

Package	Packing Description	Packing Quantity	Industry Standard
SOT-23	Tape/Reel, 7" reel	3000	EIA-481-1

## X-ON Electronics

Largest Supplier of Electrical and Electronic Components

*Click to view similar products for* [Diodes - General Purpose, Power, Switching category:](#)

*Click to view products by* [YFW Electronics manufacturer:](#)

Other Similar products are found below :

[MCL4151-TR3](#) [MMBD3004S-13-F](#) [RD0306T-H](#) [BAV17-TR](#) [BAV19-TR](#) [1N3611](#) [NTE156A](#) [NTE574](#) [NTE6244](#) [1SS181-TP](#)  
[1SS400CST2RA](#) [SDAA13](#) [SHN2D02FUTW1T1G](#) [LS4151GS08](#) [1N4449](#) [1N456A](#) [1N4934-E3/73](#) [1N914B](#) [1N914BTR](#) [1SS226-TP](#)  
[RFUH20TB3S](#) [D291S45T](#) [BAV300-TR](#) [BAW56DWQ-7-F](#) [BAW75-TAP](#) [MM230L-CAA](#) [IDW40E65D1](#) [JAN1N3600](#) [JAN1N4153-1](#)  
[JAN1N4454-1](#) [JAN1N4454UR-1](#) [LL4151-GS18](#) [053684A](#) [SMMSD4148T3G](#) [707803H](#) [NSVDAN222T1G](#) [CDSZC01100-HF](#) [LL4150-M-08](#)  
[1N4454-TR](#) [BAV199E6433HTMA1](#) [BAV70HDW-7](#) [BAS28-7](#) [JANTX1N6640](#) [BAW56HDW-13](#) [BAS28 TR](#) [VS-HFA04SD60STR-M3](#)  
[NSVM1MA152WKT1G](#) [1SS388-TP](#) [RGP30D-E3/73](#) [VS-8EWF02S-M3](#)