

■ Switching Diodes

■ Features

- Fast Switching Speed
- For General Purpose Switching Applications.
- High Conductance

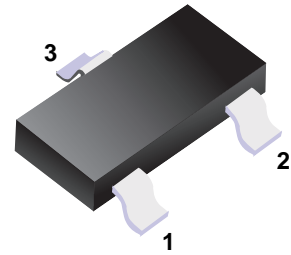

■ Simplified outline(SOT-23)

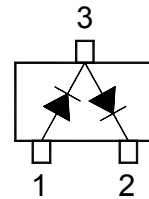

■ Marking

Marking	A7
---------	----

■ Absolute Maximum Ratings Ta = 25°C

Parameter	Symbol	Rating	Unit
Repetitive Peak Reverse Voltage	V <sub>RRM</sub>	100	V
Continuous Reverse Voltage	V <sub>R</sub>	75	
Forward Current (Double Diode Loaded)	I <sub>F</sub>	125	mA
Forward Current (Single Diode Loaded)		215	
Repetitive Peak Forward Current	I <sub>FRM</sub>	450	
Non-repetitive Peak Forward Surge Current	I <sub>FSM</sub>	t=1s 0.5	A
		t=1ms 1	
		t=1us 1.5	
Power Dissipation	P <sub>d</sub>	350	mW
Junction Temperature	T <sub>J</sub>	150	°C
Storage Temperature range	T <sub>stg</sub>	-65 to 150	

■ Electrical Characteristics Ta = 25°C

Parameter	Symbol	Test Conditions	Min	Typ	Max	Unit
Reverse breakdown voltage	V <sub>R</sub>	I <sub>R</sub> = 100 uA	100			V
Forward voltage	V <sub>F</sub>	I <sub>F</sub> = 1 mA			0.715	
		I <sub>F</sub> = 10 mA			0.855	
		I <sub>F</sub> = 50 mA			1	
		I <sub>F</sub> = 150 mA			1.25	
Reverse voltage leakage current	I <sub>R</sub>	V <sub>R</sub> = 25 V			30	nA
		V <sub>R</sub> = 75 V			1	uA
		V <sub>R</sub> = 25 V , T <sub>J</sub> =150°C			30	
		V <sub>R</sub> = 75 V , T <sub>J</sub> =150°C			50	
Junction capacitance	C <sub>j</sub>	V <sub>R</sub> = 0 V, f= 1 MHz			1.5	pF
Reverse recovery time	t <sub>rr</sub>	I <sub>F</sub> =I <sub>R</sub> =10mA, I <sub>R</sub> =1mA, R <sub>L</sub> =100Ω			4	ns

■ Typical Characteristics

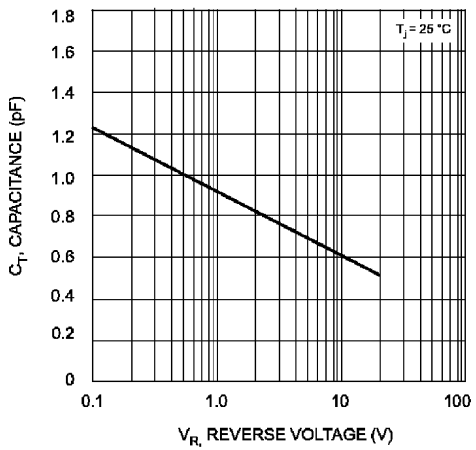
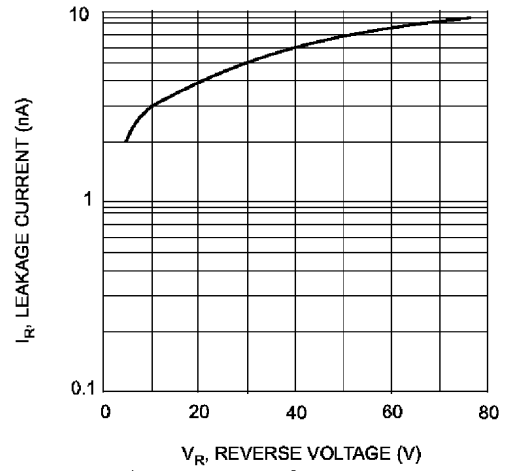
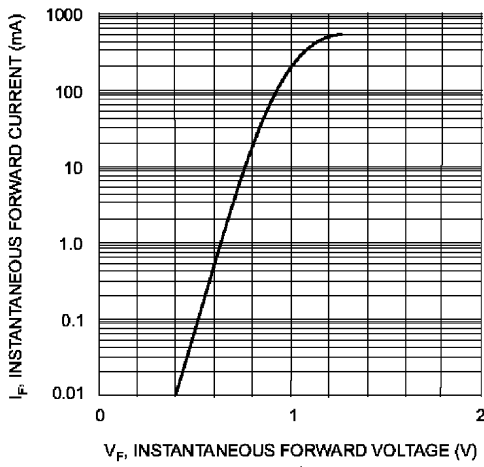

**Package Outline**

**SOT-23**

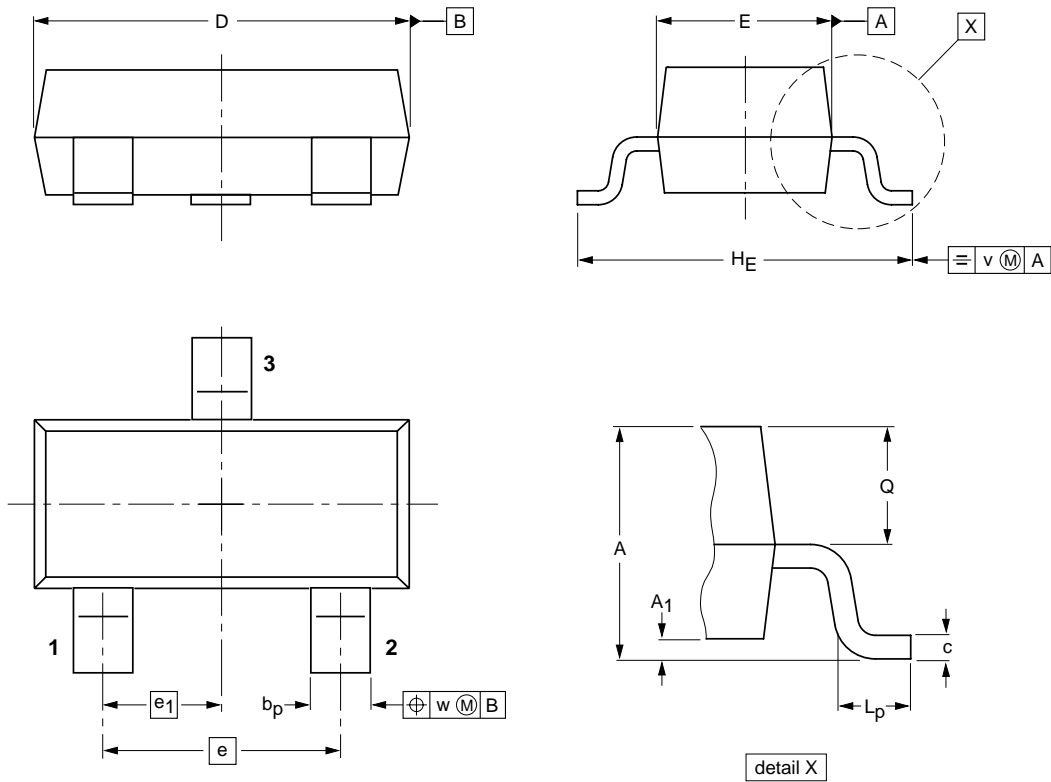

**DIMENSIONS (mm are the original dimensions)**

UNIT	A	A <sub>1</sub> max.	b <sub>p</sub>	c	D	E	e	e <sub>1</sub>	H <sub>E</sub>	L <sub>p</sub>	Q	v	w
mm	1.1 0.9	0.1	0.48 0.38	0.15 0.09	3.0 2.8	1.4 1.2	1.9	0.95	2.5 2.1	0.45 0.15	0.55 0.45	0.2	0.1

**Summary of Packing Options**

Package	Packing Description	Packing Quantity	Industry Standard
SOT-23	Tape/Reel, 7" reel	3000	EIA-481-1

## X-ON Electronics

Largest Supplier of Electrical and Electronic Components

*Click to view similar products for* [Diodes - General Purpose, Power, Switching category:](#)

*Click to view products by* [YFW Electronics manufacturer:](#)

Other Similar products are found below :

[MCL4151-TR3](#) [MMBD3004S-13-F](#) [RD0306T-H](#) [BAV17-TR](#) [BAV19-TR](#) [1N3611](#) [NTE156A](#) [NTE574](#) [NTE6244](#) [1SS181-TP](#)  
[1SS400CST2RA](#) [SDAA13](#) [SHN2D02FUTW1T1G](#) [LS4151GS08](#) [1N4449](#) [1N456A](#) [1N4934-E3/73](#) [1N914B](#) [1N914BTR](#) [1SS226-TP](#)  
[RFUH20TB3S](#) [D291S45T](#) [BAV300-TR](#) [BAW56DWQ-7-F](#) [BAW75-TAP](#) [MM230L-CAA](#) [IDW40E65D1](#) [JAN1N3600](#) [JAN1N4153-1](#)  
[JAN1N4454-1](#) [JAN1N4454UR-1](#) [LL4151-GS18](#) [053684A](#) [SMMSD4148T3G](#) [707803H](#) [NSVDAN222T1G](#) [CDSZC01100-HF](#) [LL4150-M-08](#)  
[1N4454-TR](#) [BAV199E6433HTMA1](#) [BAV70HDW-7](#) [BAS28-7](#) [JANTX1N6640](#) [BAW56HDW-13](#) [BAS28 TR](#) [VS-HFA04SD60STR-M3](#)  
[NSVM1MA152WKT1G](#) [1SS388-TP](#) [RGP30D-E3/73](#) [VS-8EWF02S-M3](#)