

■ P-Channel MOSFET

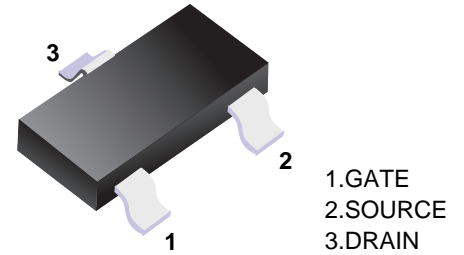

■ Simplified outline(SOT-23)

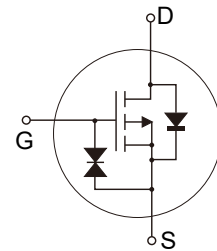

■ Features

- Energy efficient
- Low threshold voltage
- High-speed switching
- Miniature surface mount package saves board space
- ESD protected(HBM) up to 2KV

■ MARKING

Marking	PD
---------	----

■ Absolute Maximum Ratings Ta = 25°C

Parameter	Symbol	Maximum	Units
Drain-Source Voltage	$-V_{DS}$	50	V
Gate-Source Voltage	$V_{GS}$	$\pm 20$	V
Continuous Drain Current	$-I_D$	0.13	A
Pulsed Drain Current <sup>Note1</sup> @tp < 10μs	$-I_{DM}$	0.52	
Power Dissipation	$P_D$	225	mW
Junction and Storage Temperature Range	$T_J, T_{STG}$	150, -55 to 150	°C
<b>Thermal Characteristics</b>			
Parameter	Symbol	Typ.	Units
Maximum Junction-to-Ambient <sup>Note2</sup>	$R_{\theta JA}$	556	°C/W

**■ Electrical Characteristics Ta = 25°C**

Parameter	Symbol	Conditions	Min.	Typ.	Max.	Units
<b>Static Parameters</b>						
Drain-Source Breakdown Voltage	-BV <sub>DSS</sub>	-I <sub>D</sub> =250μA, V <sub>GS</sub> =0V	50	--	--	V
Zero Gate Voltage Drain Current	-I <sub>DSS</sub>	-V <sub>DS</sub> =50V, V <sub>GS</sub> =0V	--	--	1	μA
		-V <sub>DS</sub> =25V, V <sub>GS</sub> =0V	--	--	0.1	μA
Gate-Body Leakage Current	I <sub>GSS</sub>	V <sub>DS</sub> =0V, V <sub>GS</sub> =±20V	--	1	5	μA
Gate Threshold Voltage <sup>Note3</sup>	-V <sub>GS(th)</sub>	V <sub>DS</sub> =V <sub>GS</sub> , -I <sub>D</sub> =250μA	0.9	1.3	2	V
Static Drain-Source On-Resistance <sup>Note3</sup>	R <sub>DS(on)</sub>	-V <sub>GS</sub> =10V, -I <sub>D</sub> =0.1A	--	1.7	8	Ω
		-V <sub>GS</sub> =5V, -I <sub>D</sub> =0.1A	--	1.9	10	Ω
Body Diode Forward Voltage	-V <sub>SD</sub>	-I <sub>S</sub> =0.13A, V <sub>GS</sub> =0V	--	--	1.2	V
<b>Dynamic Parameters</b>						
Forward Transconductance <sup>Note3</sup>	g <sub>FS</sub>	-V <sub>DS</sub> =25V, -I <sub>D</sub> =0.1A	50	--	--	mS
Input Capacitance	C <sub>iss</sub>	V <sub>GS</sub> =0V, -V <sub>DS</sub> =5V, f=1MHz	--	30	--	pF
Output Capacitance	C <sub>oss</sub>		--	10	--	pF
Reverse Transfer Capacitance	C <sub>rss</sub>		--	5	--	pF
<b>Switching Parameters</b>						
Turn-On DelayTime	t <sub>D(on)</sub>	-V <sub>DD</sub> =15V, R <sub>L</sub> =50Ω, -I <sub>D</sub> =2.5A	--	2.5	--	ns
Turn-On Rise Time	t <sub>r</sub>		--	1	--	ns
Turn-Off DelayTime	t <sub>D(off)</sub>		--	16	--	ns
Turn-Off Fall Time	t <sub>f</sub>		--	8	--	ns
<b>Source-Drain Diode characteristics</b>						
Diode forward current	-I <sub>S</sub>		--	--	0.13	A
Diode pulsed forward current	-I <sub>SM</sub>		--	--	0.52	A

Notes: 1. Repetitive rating : Pulse width limited by junction temperature.

2. Surface mounted on FR4 board , t≤10s.

3. Pulse Test : Pulse Width≤300μs, Duty Cycle≤2%.

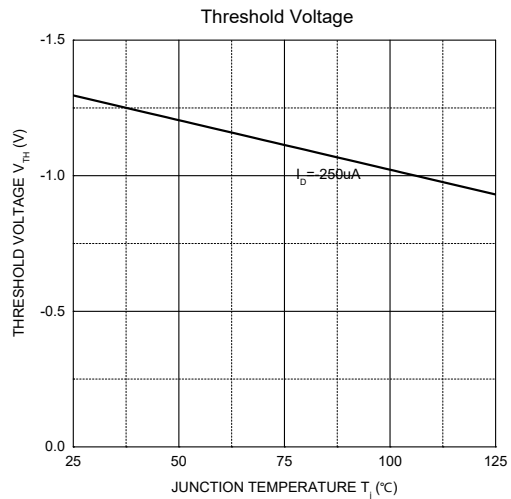
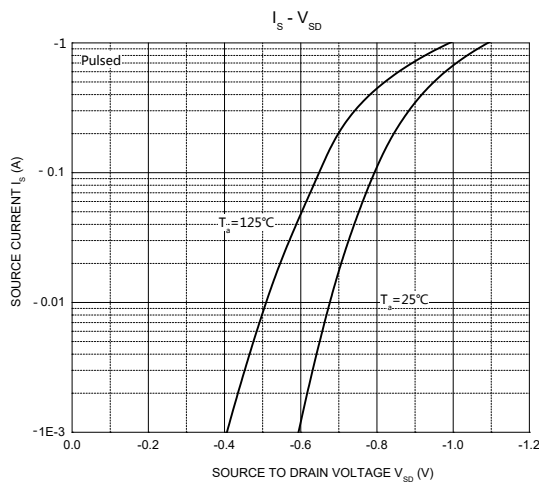
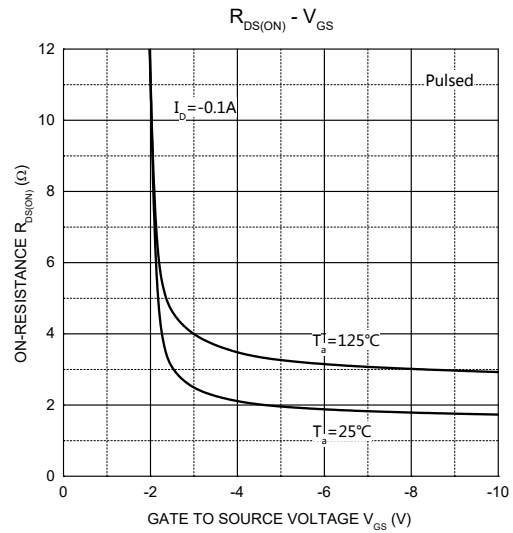
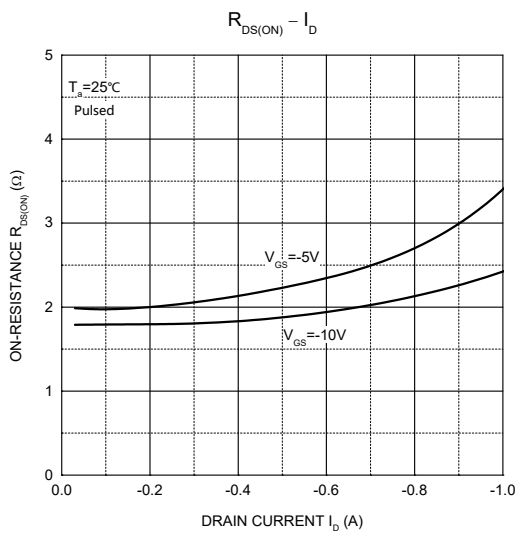
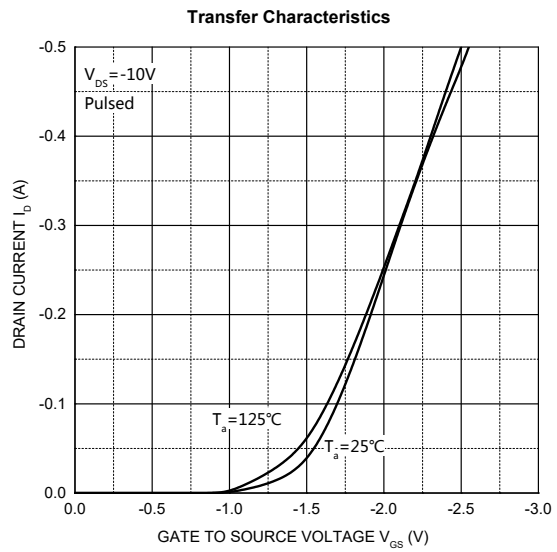
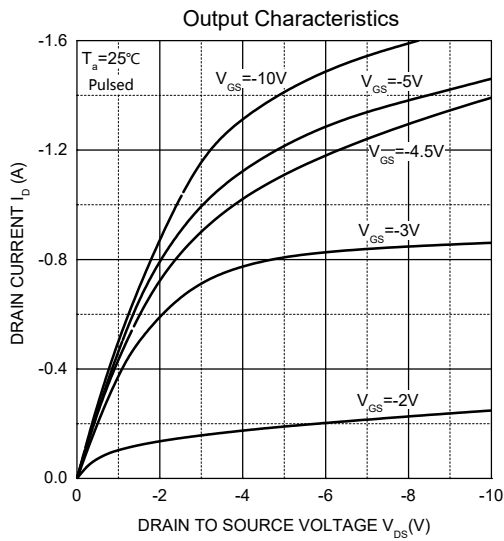

**Package Outline**

**SOT-23**

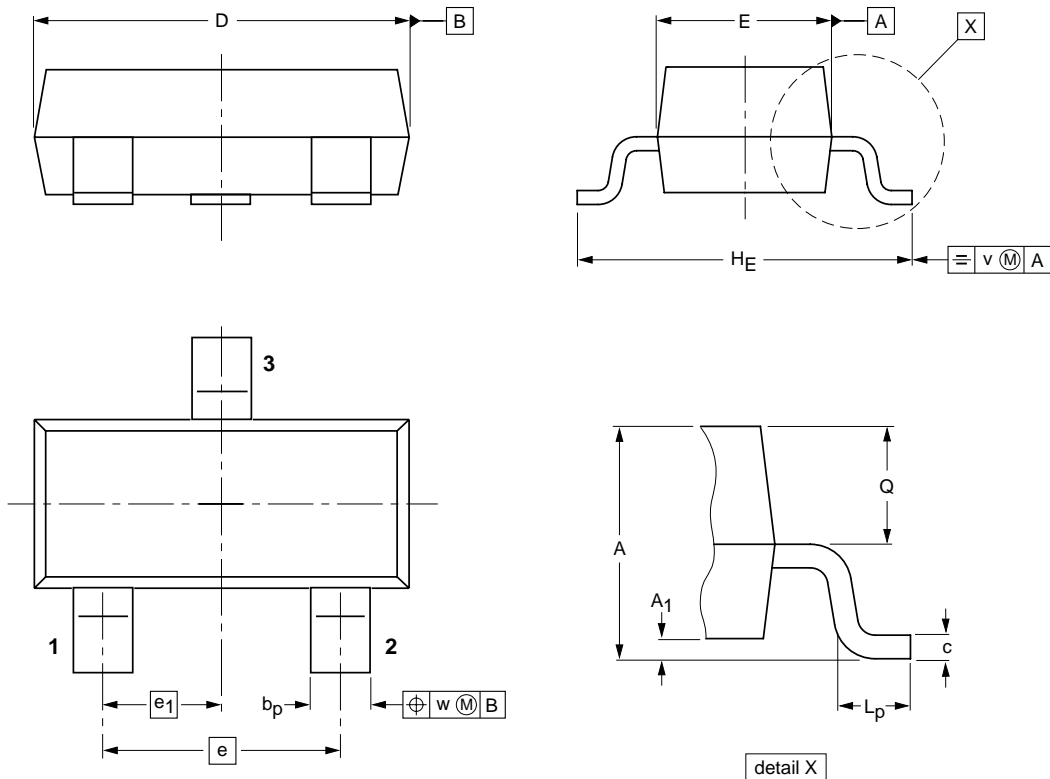

**DIMENSIONS (mm are the original dimensions)**

UNIT	A	A <sub>1</sub> max.	b <sub>p</sub>	c	D	E	e	e <sub>1</sub>	H <sub>E</sub>	L <sub>p</sub>	Q	v	w
mm	1.1 0.9	0.1	0.48 0.38	0.15 0.09	3.0 2.8	1.4 1.2	1.9	0.95	2.5 2.1	0.45 0.15	0.55 0.45	0.2	0.1

**Summary of Packing Options**

Package	Packing Description	Packing Quantity	Industry Standard
SOT-23	Tape/Reel, 7" reel	3000	EIA-481-1

## X-ON Electronics

Largest Supplier of Electrical and Electronic Components

*Click to view similar products for [MOSFET](#) category:*

*Click to view products by [YFW Electronics](#) manufacturer:*

Other Similar products are found below :

[IRFD120](#) [JANTX2N5237](#) [2SK2267\(Q\)](#) [BUK455-60A/B](#) [TK100A10N1,S4X\(S](#) [MIC4420CM-TR](#) [VN1206L](#) [NDP4060](#) [SI4482DY](#)  
[IRS2092STRPBF-EL](#) [IPS70R2K0CEAKMA1](#) [TK31J60W5,S1VQ\(O](#) [TK31J60W,S1VQ\(O](#) [TK16J60W,S1VQ\(O](#) [2SK2614\(TE16L1,Q\)](#)  
[DMN1017UCP3-7](#) [EFC2J004NUZTDG](#) [P85W28HP2F-7071](#) [DMN1053UCP4-7](#) [NTE2384](#) [DMC2700UDMQ-7](#) [DMN2080UCB4-7](#)  
[DMN61D9UWQ-13](#) [US6M2GTR](#) [DMN31D5UDJ-7](#) [DMP22D4UFO-7B](#) [IPS60R3K4CEAKMA1](#) [DMN1006UCA6-7](#) [DMN16M9UCA6-7](#)  
[STF5N65M6](#) [IRF40H233XTMA1](#) [STU5N65M6](#) [DMN6022SSD-13](#) [DMN13M9UCA6-7](#) [DMTH10H4M6SPS-13](#) [IPS60R360PFD7SAKMA1](#)  
[DMN2990UFB-7B](#) [SSM3K35CT,L3F](#) [IPLK60R1K0PFD7ATMA1](#) [2N7002W-G](#) [MCAC30N06Y-TP](#) [IPWS65R035CFD7AXKSA1](#)  
[MCQ7328-TP](#) [SSM3J143TU,LXHF](#) [DMN12M3UCA6-7](#) [PJMF280N65E1\\_T0\\_00201](#) [PJMF380N65E1\\_T0\\_00201](#)  
[PJMF280N60E1\\_T0\\_00201](#) [PJMF600N65E1\\_T0\\_00201](#) [PJMF900N65E1\\_T0\\_00201](#)