

ESD3V3D9B

Description

ESD3V3D9B is designed to protect voltage sensitive components from ESD and transient voltage events. Excellent clamping capability, low leakage, and fast response time, make these parts ideal for ESD protection on designs where board space is at a premium.

Features

- 150 Watts Peak Pulse Power per Line ($t_p=8/20\mu s$)
- Operating voltage: 3.3V
- Low leakage current
- Package: SOD-923
- Low clamping voltage
- Complies with following standards:
 - IEC 61000-4-2 (ESD) immunity test
 - Air discharge: $\pm 30kV$
 - Contact discharge: $\pm 30kV$



Functional Diagram

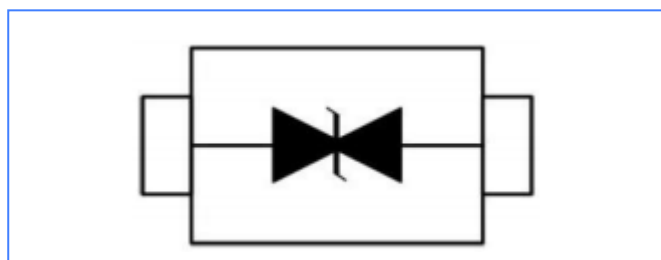

Applications

- Cellular Phones
- Portable Devices
- Digital Cameras
- Power Supplies

Absolute Maximum Ratings($T_{amb}=25^{\circ}C$ unless otherwise specified)

| Parameter | Symbol | Value | Unit |
|----------------------------------|------------------|--------------|-------------|
| Peak Pulse Power (8/20 μs) | P _{PP} | 150 | Watts |
| ESD per IEC 61000-4-2 (Air) | V _{ESD} | ± 30 | KV |
| ESD per IEC 61000-4-2 (Contact) | | ± 30 | KV |
| Lead Soldering Temperature | TL | 260 (10 sec) | $^{\circ}C$ |
| Operating Temperature Range | T _J | -55 to +125 | $^{\circ}C$ |
| Storage Temperature Range | T _{STJ} | -55 to +150 | $^{\circ}C$ |

Electrical Characteristics (TA = 25 °C unless otherwise noted)

| Parameter | Symbol | Conditions | Min. | Typ. | Max. | Units |
|---------------------------|--------|-----------------|------|------|------|-------|
| Reverse Stand-off Voltage | VRWM | | | | 3.3 | V |
| Reverse Breakdown Voltage | VBR | It = 1mA | 5.1 | | | V |
| Reverse Leakage Current | IR | VR =VRWM | | | 1 | μA |
| Clamping Voltage | VC | @IPP | | | 14.1 | V |
| Junction Capacitance | CJ | VR=0V, f = 1MHz | | | 25 | pF |

Characteristics Curves

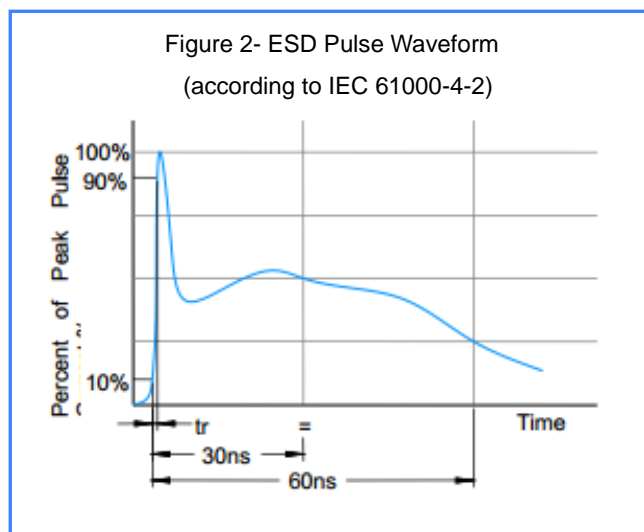
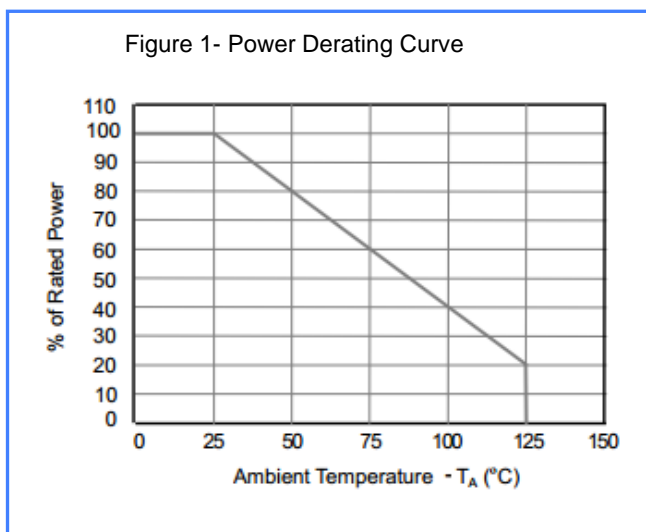

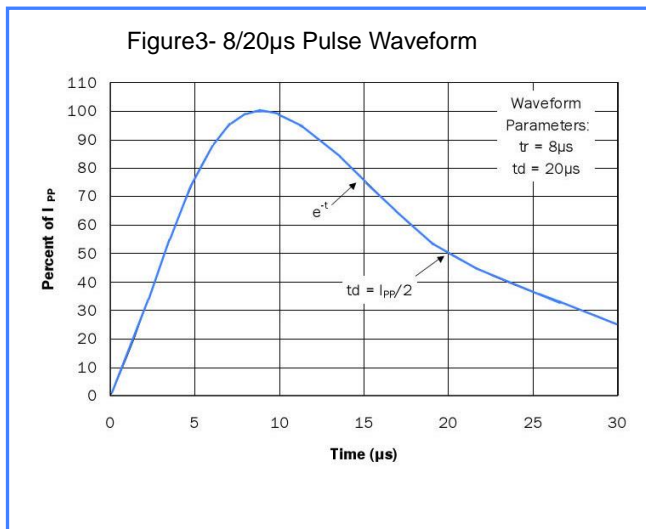

PACKAGE OUTLINE DIMENSIONS in millimeters (inches) :

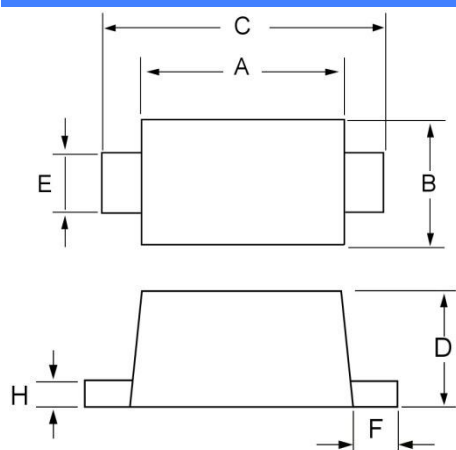

| Dim | Inches | | Millimeters | |
|-----|--------|-------|-------------|------|
| | MIN | MAX | MIN | MAX |
| A | 0.030 | 0.033 | 0.75 | 0.85 |
| B | 0.022 | 0.026 | 0.55 | 0.65 |
| C | 0.037 | 0.041 | 0.95 | 1.05 |
| D | 0.014 | 0.017 | 0.36 | 0.43 |
| E | 0.006 | 0.010 | 0.15 | 0.25 |
| F | 0.002 | 0.006 | 0.05 | 0.15 |
| H | 0.003 | 0.007 | 0.07 | 0.17 |

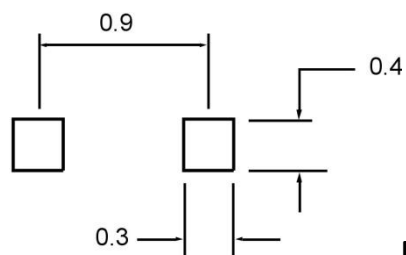

Mounting Pad Layout(mm)

Disclaimer

Specifications are subject to change without notice.

The device characteristics and parameters in this data sheet can and do vary in different applications and actual device performance may vary over time.

Users should verify actual device performance in their specific applications.

X-ON Electronics

Largest Supplier of Electrical and Electronic Components

Click to view similar products for [ESD Suppressors / TVS Diodes](#) category:

Click to view products by [Yint](#) manufacturer:

Other Similar products are found below :

[60KS200C](#) [D18V0L1B2LP-7B](#) [D5V0F4U5P5-7](#) [NTE4902](#) [P4KE27CA](#) [P6KE11CA](#) [P6KE39CA-TP](#) [P6KE8.2A](#) [JANTX1N6053A](#)
[SA110CA](#) [SA60CA](#) [SA64CA](#) [SMBJ12CATR](#) [SMBJ33CATR](#) [SMBJ8.0A](#) [ESD105-B1-02EL E6327](#) [ESD112-B1-02EL E6327](#)
[ESD5V0L1B02VH6327XTSA1](#) [ESD7451N2T5G](#) [19180-510](#) [CPDT-5V0USP-HF](#) [3.0SMCJ33CA-F](#) [3.0SMCJ36A-F](#) [HSPC16701B02TP](#)
[JANTX1N6126A](#) [JANTX1N6465](#) [USB50805e3/TR7](#) [D3V3Q1B2DLP3-7](#) [D55V0M1B2WS-7](#) [DRTR5V0U4SL-7](#) [SCM1293A-04SO](#)
[ESD200-B1-CSP0201 E6327](#) [SM12-7](#) [SM1605E3/TR13](#) [SMLJ45CA-TP](#) [CEN955 W/DATA](#) [82350120560](#) [VESD12A1A-HD1-GS08](#)
[CPDUR5V0R-HF](#) [CPDQC5V0U-HF](#) [CPDQC5V0USP-HF](#) [CPDQC5V0-HF](#) [D1213A-01LP4-7B](#) [ESD101-B1-02EL E6327](#) [824500181](#)
[MMAD1108/TR13](#) [5KP100A](#) [5KP15A](#) [5KP18A](#) [5KP48A](#)