

■ Features

- High current type.
- Ferrite bobbin core and compact size.
- Low core loss for high frequency power application.
- Large terminal surface for good PCB bonding.
- Operating temperature: -40°C ~ +125°C.

■ Applications

- Portable communication equipment.
- Notebook PC, digital camera, LCD television set.
- Power supply for VTR, OA equipment.
- DC/DC converters.

■ Product Identification

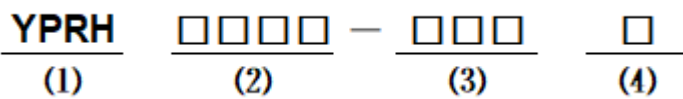

(1) : Type

(2) : Dimensions

(3) : Inductance value

(4) : Inductance Tolerance; N=±30%, M=±20%, K=±10%

■ Shapes and Dimensions (Unit: mm)

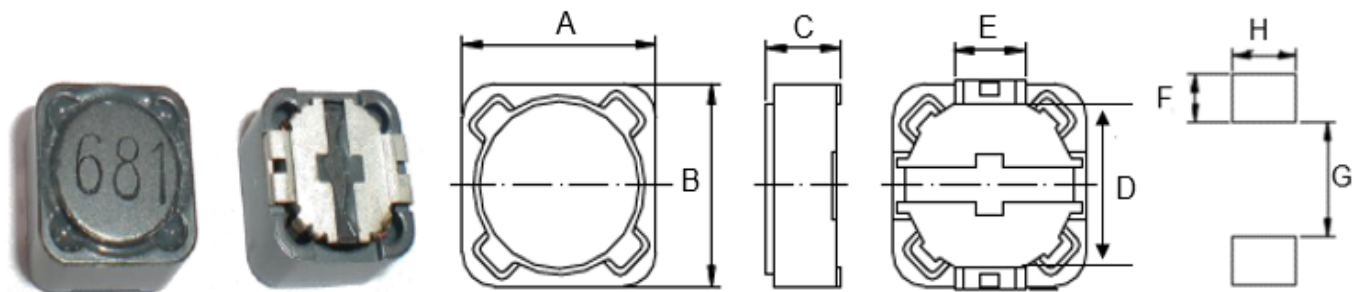

| TYPE | A | B | C max | D | E | F Ref. | G Ref. | H Ref. |
|----------|----------|----------|-------|----------|-----|--------|--------|--------|
| YPRH1508 | 15.0±0.5 | 15.0±0.5 | 8.0 | 10.0±0.1 | 5.0 | 3.5 | 8.5 | 6.0 |

■ YPRH1508 Series

| Part Number | Inductance (uH) | L Test Frequency (KHz) | Max.DC Resistance (Ω) | MAX.Rated Current (A) |
|---------------|--------------------|---------------------------|--------------------------|--------------------------|
| YPRH1508-1R0□ | 1.0 | 100 | 0.008 | 26 |
| YPRH1508-2R2□ | 2.2 | 100 | 0.011 | 20 |
| YPRH1508-3R3□ | 3.3 | 100 | 0.013 | 17 |
| YPRH1508-4R7□ | 4.7 | 100 | 0.015 | 15 |
| YPRH1508-6R8□ | 6.8 | 100 | 0.019 | 13 |
| YPRH1508-100□ | 10 | 100 | 0.023 | 10 |
| YPRH1508-150□ | 15 | 100 | 0.028 | 8.50 |
| YPRH1508-220□ | 22 | 100 | 0.035 | 7.40 |
| YPRH1508-330□ | 33 | 100 | 0.065 | 6.00 |
| YPRH1508-470□ | 47 | 100 | 0.104 | 4.80 |
| YPRH1508-680□ | 68 | 100 | 0.127 | 4.00 |
| YPRH1508-100□ | 100 | 100 | 0.162 | 3.30 |
| YPRH1508-151□ | 150 | 100 | 0.240 | 2.70 |
| YPRH1508-221□ | 220 | 100 | 0.355 | 2.10 |
| YPRH1508-331□ | 330 | 100 | 0.550 | 1.80 |
| YPRH1508-471□ | 470 | 100 | 0.755 | 1.50 |
| YPRH1508-681□ | 680 | 100 | 1.150 | 1.30 |
| YPRH1508-102□ | 1000 | 100 | 1.900 | 1.10 |
| YPRH1508-122□ | 1200 | 100 | 2.400 | 0.94 |
| YPRH1508-152□ | 1500 | 100 | 2.500 | 0.85 |
| YPRH1508-222□ | 2200 | 100 | 3.300 | 0.69 |
| YPRH1508-332□ | 3300 | 100 | 5.300 | 0.57 |
| YPRH1508-472□ | 4700 | 100 | 7.200 | 0.52 |

- ※ The saturation current value is the DC current value having inductance decrease down to 30%. (at 20°C)
- ※ The temperature rise current value is the DC current value having temperature increase up to 40°C. (at 20°C)
- ※ The rated current is the DC current value that satisfies both of current value saturation current value and temperature rise current value.

■ Taping Dimensions(Unit:mm)

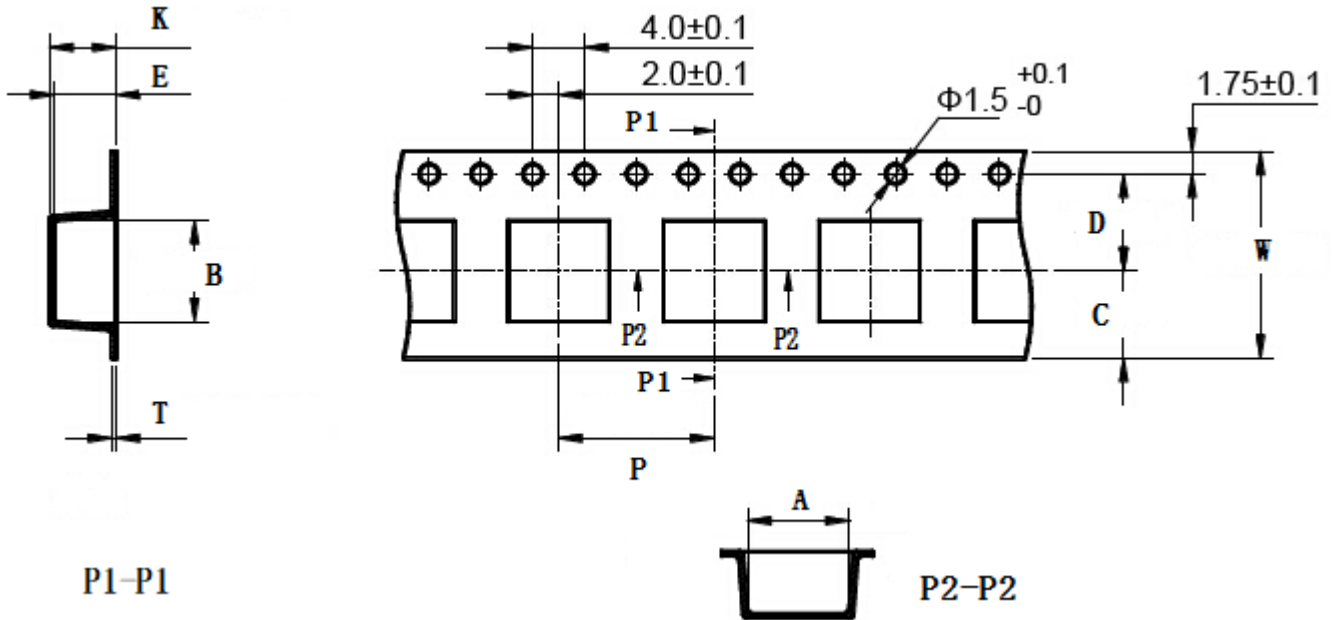

| TYPE | MPQ | W | A | B | C | D | E | P | K | T |
|----------|-----|--------|----------|----------|-------|----------|---------|--------|--------|----------|
| YPRH1508 | 350 | 24±0.3 | 12.6±0.1 | 12.6±0.1 | 10.75 | 11.5±0.1 | 8.2±0.1 | 20±0.1 | 10 Ref | 0.4±0.05 |

■ Reel Dimensions(Unit:mm)

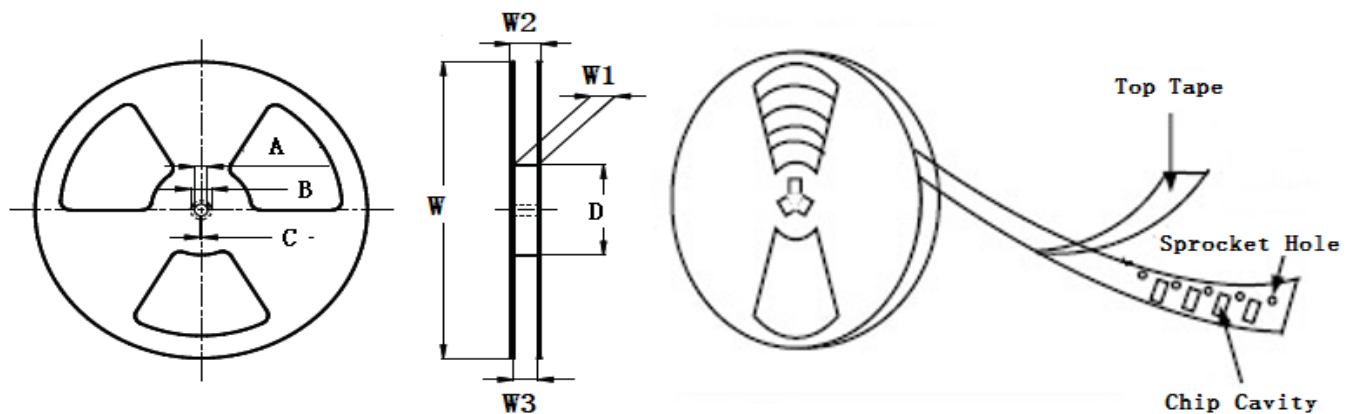

| TYPE | W | W1 | W2 | W3 | A | B | C | D |
|----------|----------|-----------|-----------|-----------|-----------|-----------|----------|---------|
| YPRH1508 | 330±2.00 | 24.4±1.50 | 30.40 Max | 23.90 Min | 13.0±0.50 | 21.0±0.80 | 2.0±0.50 | 100 Min |

Direction of rolling

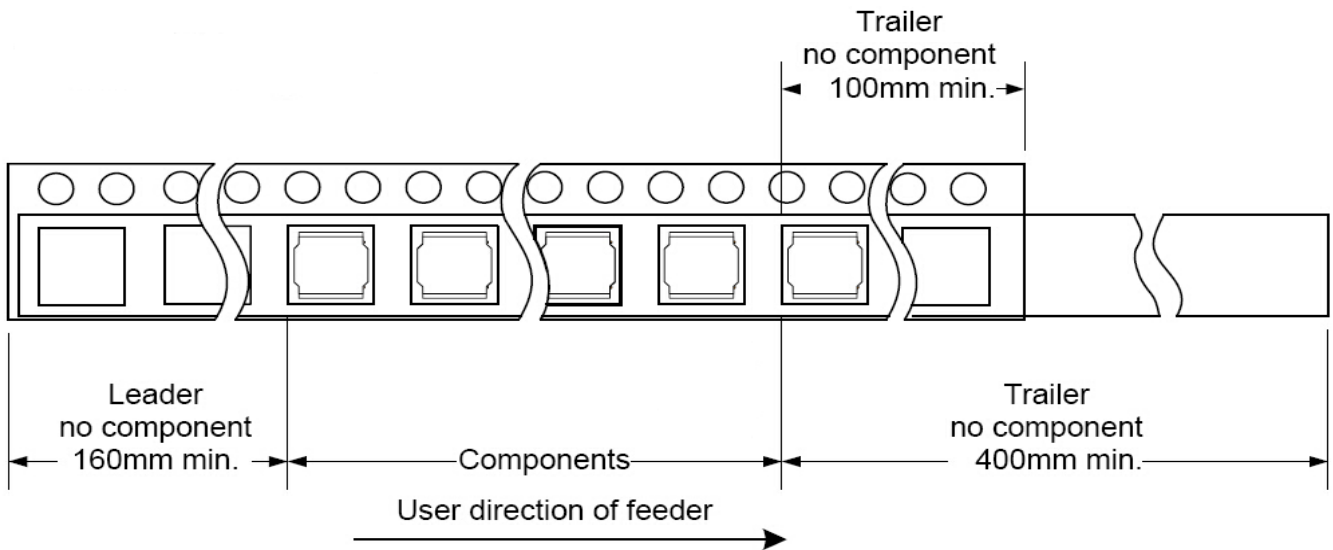

Cover tape peel off condition



Cover tape peel force shall be 0.1N to 1.3N.

Reference peel speed 300±10mm/min.

X-ON Electronics

Largest Supplier of Electrical and Electronic Components

Click to view similar products for [Fixed Inductors](#) category:

Click to view products by [YJYCOIN](#) manufacturer:

Other Similar products are found below :

[CR32NP-151KC](#) [CR32NP-180KC](#) [CR32NP-181KC](#) [CR32NP-1R5MC](#) [CR32NP-390KC](#) [CR32NP-3R9MC](#) [CR32NP-680KC](#) [CR32NP-820KC](#) [CR32NP-8R2MC](#) [CR43NP-390KC](#) [CR43NP-560KC](#) [CR43NP-680KC](#) [CR54NP-181KC](#) [CR54NP-470LC](#) [CR54NP-820KC](#) [CR54NP-8R5MC](#) [70F224AI](#) [MGDQ4-00004-P](#) [MHL1ECTTP18NJ](#) [MHQ1005P10NJ](#) [MHQ1005P1N0S](#) [MHQ1005P2N4S](#) [MHQ1005P3N6S](#) [MHQ1005P5N1S](#) [MHQ1005P8N2J](#) [PE-51506NL](#) [PE-53601NL](#) [PE-53602NL](#) [PE-53630NL](#) [PE-53824SNLT](#) [PE-92100NL](#) [PG0434.801NLT](#) [PG0936.113NLT](#) [9220-20](#) [9310-16](#) [PM06-2N7](#) [PM06-39NJ](#) [A01TK](#) [1206CS-471XJ](#) [HC2LP-R47-R](#) [HC2-R47-R](#) [HC3-2R2-R](#) [HCF1305-3R3-R](#) [1206CS-151XG](#) [RCH664NP-140L](#) [RCH664NP-4R7M](#) [RCH8011NP-221L](#) [RCP1317NP-332L](#) [RCP1317NP-391L](#) [RCR1010NP-470M](#)