

RoHS

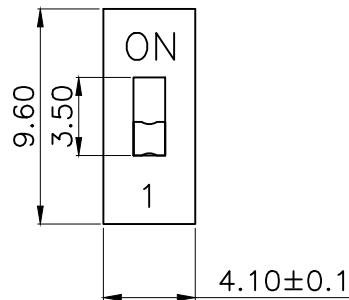

Circuit Diagram

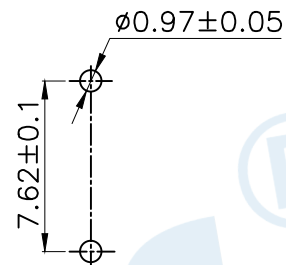

PCB Layout(Pattern Side)

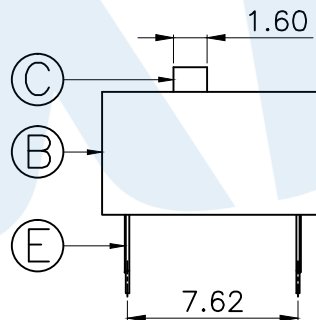
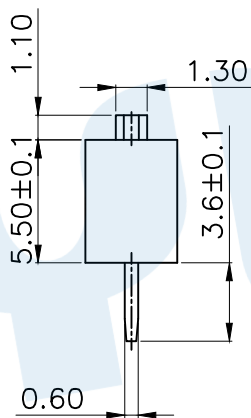

凸柄 Convex handle

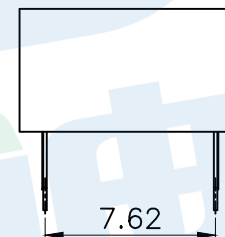

短柄 Short handle

NOTE:

- 1.Rating: 24V 25mA DC
- 2.Insulation Resistance: $\geq 100 \text{ M}\Omega$
- 3.Withstand voltage:AC 500V 1Minute
- 4.Operating Force Range: 400gf Max
- 5.Mechanical Life:3,000 Cycles

| Number of digits(位数) | | 1P | 2P | 3P | 4P | 5P | 6P | 7P | 8P | 9P | 10P | 12P |
|----------------------|---------------------|--------|--------|--------|--------|--------|--------|--------|--------|--------|--------|--------|
| Cover/red 盖子/红色 | 凸柄 Convex handle | TA-01 | TA-02 | TA-03 | TA-04 | TA-05 | TA-06 | TA-07 | TA-08 | TA-09 | TA-10 | TA-12 |
| | 短柄 Short handle | TA-01D | TA-02D | TA-03D | TA-04D | TA-05D | TA-06D | TA-07D | TA-08D | TA-09D | TA-10D | TA-12D |
| Cover/blue 盖子/蓝色 | 凸柄 Convex handle | TA-01R | TA-02R | TA-03R | TA-04R | TA-05R | TA-06R | TA-07R | TA-08R | TA-09R | TA-10R | TA-12R |
| | 短柄 Short handle | TA-01L | TA-02L | TA-03L | TA-04L | TA-05L | TA-06L | TA-07L | TA-08L | TA-09L | TA-10L | TA-12L |

| | | | | | |
|-----|--------------|--------|-----|-------------------|--------------|
| Ⓔ | Terminal | | 2 | Phosphorus bronze | Gold plating |
| Ⓗ | Potting glue | | | Epoxy resin | Black |
| Ⓒ | Handle | | 1 | PBT | White |
| Ⓑ | Cover | | 1 | PBT | Red/Blue |
| Ⓐ | Base | | 1 | PBT | Black |
| NO. | Name | Number | Qty | Materil | Remarks |

YUANDI® Yuandi Electronics Co, Ltd

| | | | |
|----------|------|-------|------------|
| design | date | name | DIP SWITCH |
| Review | date | model | TA-01 |
| Approved | date | | |

Drawing number: Proportion 1:1 unit mm gage number A4

modify Review Approved Tolerance not specified

X-ON Electronics

Largest Supplier of Electrical and Electronic Components

Click to view similar products for [DIP Switches/SIP Switches](#) category:

Click to view products by [Yuandi](#) manufacturer:

Other Similar products are found below :

[78M03S](#) [79B10T](#) [8136-475G4T](#) [G7G-1A2-CB-DC12](#) [A7SS-M](#) [DBP 2110](#) [DBP 2112](#) [DBS1008](#) [DHN02FTVTR](#) [DHN10T](#) [DHS108](#)
[DPL08TN](#) [DRD16CSE04](#) [DRR4010](#) [DRR60016](#) [DRS4016](#) [BD06E](#) [1825008-1](#) [1825444-1](#) [25.350.0653.0](#) [LA2-DC12](#) [SBS 5004 TG](#)
[SDA10H1BDA](#) [97R06ST](#) [A2C-2A5](#) [1825444-7](#) [ADE08SA04](#) [ADE12S04](#) [2161391-1](#) [2-1825058-8](#) [CCVA 2.5/ 4-G-5.08](#) [P26THRR32](#)
[25.330.0653.1](#) [25.352.0353.0](#) [MDG305ST](#) [IKN0600000](#) [IKN0800000](#) [LA2-002-DC24](#) [DBP2008](#) [DBS1003](#) [DBS2008](#) [438872000](#)
[DRD10CRAE04](#) [DRS1604](#) [DSR02T](#) [DSS 208 N](#) [5-1825033-1](#) [106-SDN06-EV](#) [1-1437507-6](#) [E2FMX2D1M1TGJ03M](#)
[E3ZMCT81M1TJ03M](#)