

短柄 Short handle

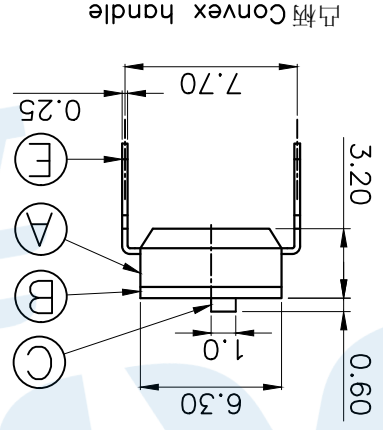

凸柄 Convex handle

Number of digits (位数)	凸柄 Convex handle	短柄 Short handle
1P	TL-01	TL-01D
2P	TL-02	TL-02D
3P	TL-03	TL-03D
4P	TL-04	TL-04D
5P	TL-05	TL-05D
6P	TL-06	TL-06D
7P	TL-07	TL-07D
8P	TL-08	TL-08D
9P	TL-09	TL-09D
10P	TL-10	TL-10D
12P	TL-12	TL-12D

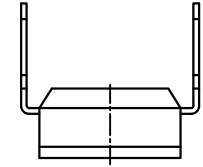
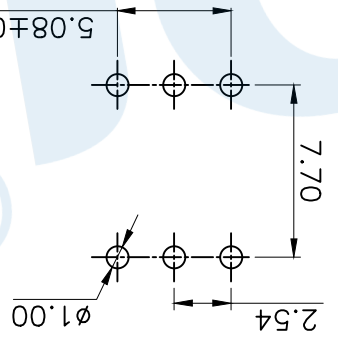

PCB Layout (Pattern Side)

Circuit Diagram

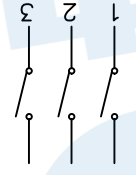

NOTE:
 1. Rating: 24V 25mA DC
 2. Insulation Resistance: ≥ 100 M Ω
 3. Withstand voltage: AC 500V 1Minute
 4. Operating Force Range: 500gf Max
 5. Mechanical Life: 3,000 Cycles

NO.	Name	Number	Qty	Material	Remarks
Ⓐ	Base		1	PPS	Black
Ⓑ	Cover		1	PPS	Black
Ⓒ	Handle		3	PA46	White
Ⓓ	Shrapnel		3	Beryllium copper	Gold plating
Ⓔ	Terminal		6	Brass	Gold plating

design	date	name	model	Yuandi Electronics Co, Ltd	
Review	date			DIP SWITCH	
Approved	date			TL-03	

modify	Review	Approved	tolerance not specified	proportion 1:1	unit	mm	gape number	model	TL-03	
			angle	±0.2						
			10~30	±0.30						
			5~10	±0.20						
			~5	±0.10						

X-ON Electronics

Largest Supplier of Electrical and Electronic Components

Click to view similar products for [DIP Switches/SIP Switches](#) category:

Click to view products by [Yuandi](#) manufacturer:

Other Similar products are found below :

[78M03S](#) [79B10T](#) [8136-475G4T](#) [G7G-1A2-CB-DC12](#) [A7SS-M](#) [DBP 2110](#) [DBP 2112](#) [DBS1008](#) [DHN02FTVTR](#) [DHN10T](#) [DHS108](#) [DM-08](#)
[DP-10-H](#) [DPL08TN](#) [DRD16CSE04](#) [DRR4010](#) [DRR60016](#) [DRS4016](#) [BD06E](#) [1825008-1](#) [1825444-1](#) [218-8LPSTF](#) [219-6LPSTRF](#)
[25.350.0653.0](#) [LA2-DC12](#) [SBS 5004 TG](#) [SDA10H1BDA](#) [97R06ST](#) [A2C-2A5](#) [1825444-7](#) [ADE08SA04](#) [ADE12S04](#) [2-1825058-8](#) [CCVA](#)
[2.5/ 4-G-5.08 P26THRR32](#) [25.330.0653.1](#) [25.352.0353.0](#) [MDG305ST](#) [IKN0600000](#) [IKN0800000](#) [LA2-002-DC24](#) [DBP2008](#) [DBS1003](#)
[DBS2008](#) [438872000](#) [WT11-D1-06](#) [DM-02](#) [DRD10CRAE04](#) [DRS1604](#) [DSR02T](#) [DSS 208 N](#)