

RoHS

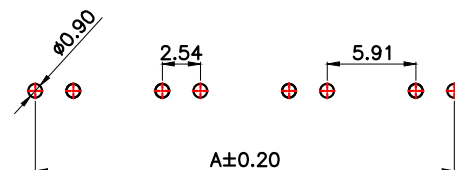

适用线路板 (PCB LAYOUT)

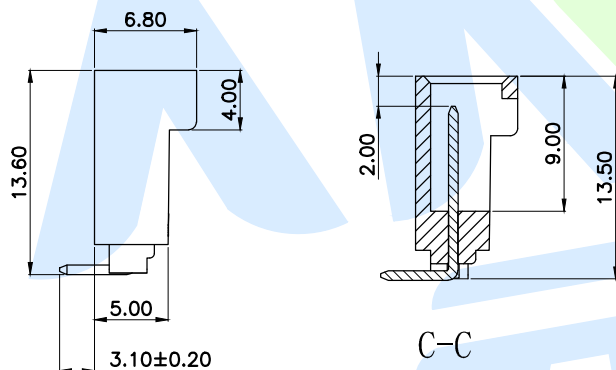
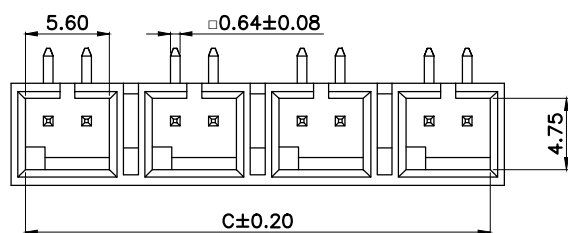
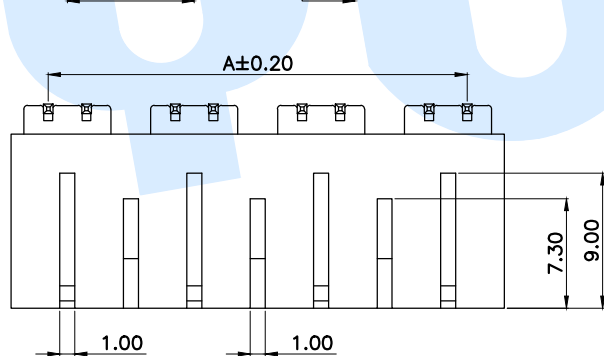
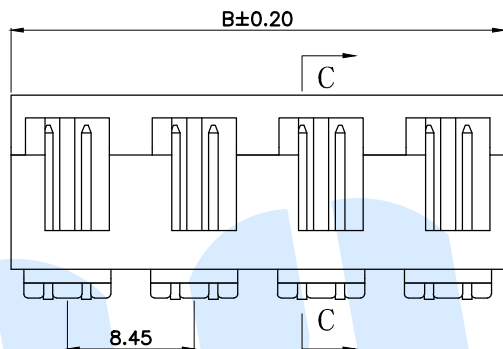
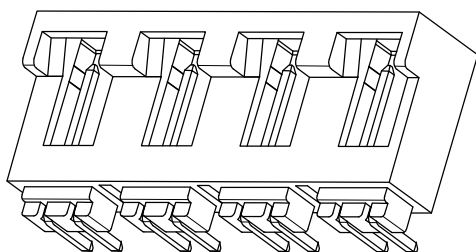
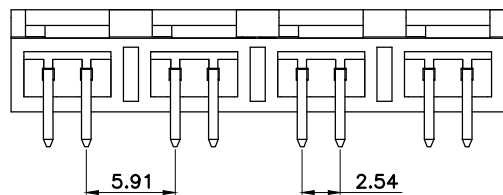

Model No.	Pin	A	B	C
WAFER-TJC8-2.54-2PWZ	2	2.54	7.50	5.60
WAFER-TJC8-2.54-4PWZ	4	10.99	15.95	14.05
WAFER-TJC8-2.54-6PWZ	6	19.44	24.40	22.50
WAFER-TJC8-2.54-8PWZ	8	27.89	32.85	30.95
WAFER-TJC8-2.54-10PWZ	10	36.34	41.30	39.40
WAFER-TJC8-2.54-12PWZ	12	44.79	49.75	47.85

Specifications/技术规格:

- 1.Poles/线数: 2P、4P、6P、8P、10P、12P
- 2.Wire range/适用线规: AGW 26#~22#
- 3.Applicable PC board thickness/适用PC板厚度: 1.6mm
- 4.Current rating/额定电流: 3.0A
- 5.Voltage rating/额定电压: 250V DC/AC
- 6.Insulation Resistance/绝缘电阻: 1000MΩ Min
- 7.Dielectric Withstanding/耐电压: 1500V AC/minute
- 8.Contact Resistance/接触电阻: 20mΩ Max
- 9.Operating Temperature/工作温度: -25℃ to +85℃

NO.	Name	Number	Qty	Materil	Remarks
(B)	Terminal			Brass	Plating Sn
(A)	Housing		1	PA66	Black

**YUANDI®** Yuandi Electronics Co.,Ltd

design	date	name	model
Review	date	WAFER CONNECTOR	WAFER-TJC8-2.54-□□PWZ
Approved	date		

## X-ON Electronics

Largest Supplier of Electrical and Electronic Components

*Click to view similar products for [Headers & Wire Housings](#) category:*

*Click to view products by [Yuandi](#) manufacturer:*

Other Similar products are found below :

[0015917161](#) [0022155065](#) [57102-F02-18ULF](#) [58102-G61-06LF](#) [582553-1](#) [01.001.5753.1](#) [0050291907](#) [02.125.8002.8](#) [609-3404](#) [61062-3](#)  
[CSU011177004](#) [622-0430](#) [622-3653LF](#) [63453-116](#) [636-1030](#) [636-1427](#) [636-3427](#) [636-4007](#) [641938-9](#) [65495-038](#) [65692-001LF](#) [65781-018](#)  
[65781-047](#) [65817-010LF](#) [65817-015LF](#) [67095-007LF](#) [67601157](#) [68631-112](#) [699319-000](#) [70.362.1628.0](#) [70-4210](#) [70-4226B](#) [70-4853B](#) [707-](#)  
[5028](#) [71.350.2428.0](#) [733-134](#) [733-162](#) [760-3052](#) [MHR-64-VUAL](#) [80.063.4001.1](#) [800-90-001-10-001000](#) [801-43-002-10-013000](#)  
[801-43-006-10-002000](#) [803-43-024-10-001000](#) [803-93-012-10-001000](#) [8-1437020-4](#) [819-22-004-30-001101](#) [820-22-006-30-001101](#)  
[820-22-008-30-001101](#) [821-22-002-10-001101](#)