

DC subminiature switch





Features

- Sealed switch IP6K7 protection
- Silicon-free variants available
- Models available for 120 °C operating temperature
- Nominal currents from 10 A at 250 VAC
- Various auxiliary actuators available (can also be retrofitted)
- Various application-specific contact materials
- Mechanical operating life min. 1,000,000 actuations
- Wide variety of terminal types

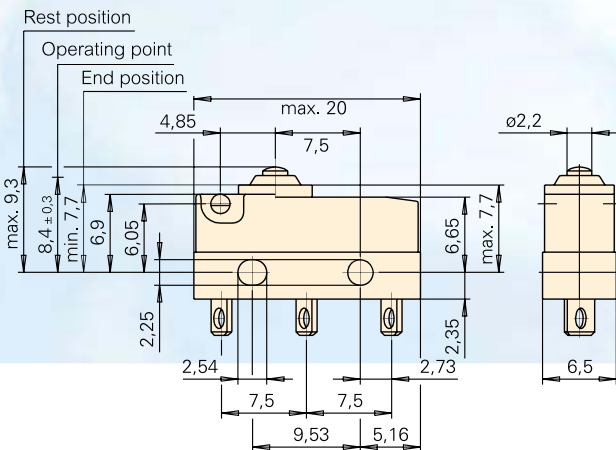
Dimensions in mm



Technical specifications

Contact configuration	S.P.D.T., S.P.S.T. - N.O., S.P.S.T. - N.C.
Contact gap	< 3 mm (μ)
Switching voltage max.	250 V AC
Switched current	0,1 to 10 A AC (see table) depending on model
Operating force	200 to 340 cN without auxiliary actuator depending on model
Total travel	ca. 1,6 mm
Mechanical life	min. 1 x 10 ⁶ operations (see table)
Electrical life (max. load)	min 10.000 operations (see table)
Ambient temperature	-40 to +85 °C / 120 °C
Model with leads	-40 to +105 °C
Proof tracking index	PTI175, PTI250 on request
Materials	
Housing	PET/PBT (UL 94V-0)
Actuator	POM (T85), PBT (T120)
Contacts DC1, DC2, DC4	AuNi
DC3	AuAgPt (Crosspoint)
Terminals	CuZn (silver-plated)
Auxiliary actuator	Stainless steel or plastic
Sealing gasket	SI, silicon-free alternative available
Leads	Cu, PVC-sheated
Approvals	   depending on model
Degree of protection (switch interior)	IP6K7

For detailed information and the layout of the details described above, please do not hesitate to ask for our technical specifications and drawing.

Terminals

Solder terminal short
max. 30° twisted

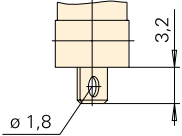

Q.C. terminal 2,8 x 0,5
max. 30° twisted

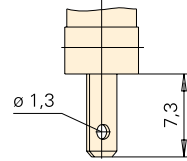

PCB terminal 1,3 x 0,5 mm
max. 30° twisted

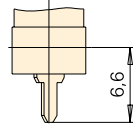

PCB terminal 0,6 x 0,5 mm
max. 30° twisted

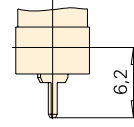

PCB terminal 0,6 x 0,5 mm
RH-side w/o location pins

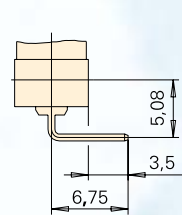

PCB terminal 0,6 x 0,5 mm
RH-side with location pins

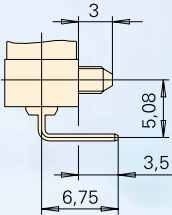

PCB terminal 0,6 x 0,5 mm
LH-side w/o location pins

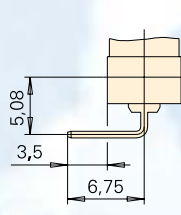

PCB terminal 0,6 x 0,5 mm
LH-side with location pins

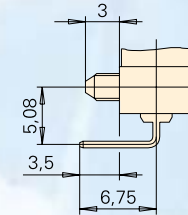

Side definition with terminals and
location pins

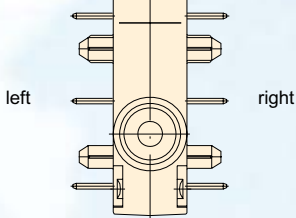

Drilling pattern for
PCB terminals 1.3 x 0.5 mm

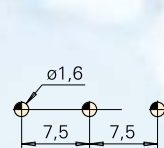

Drilling pattern for lateral PCB
terminals 0.6 x 0.5 mm
straight/lateral

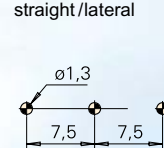

Drilling pattern for lateral PCB
terminals 0.6 x 0.5, with location pins

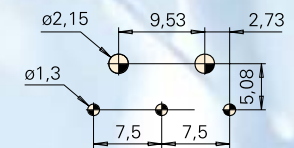

Auxiliary actuator options

Steel auxiliary actuator

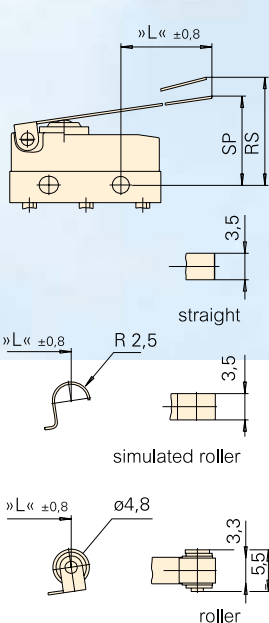

Plastic auxiliary actuator with/
without adjusting screw

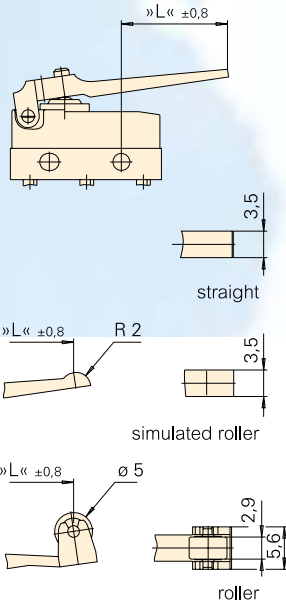

Model with connecting leads (IP6K7)

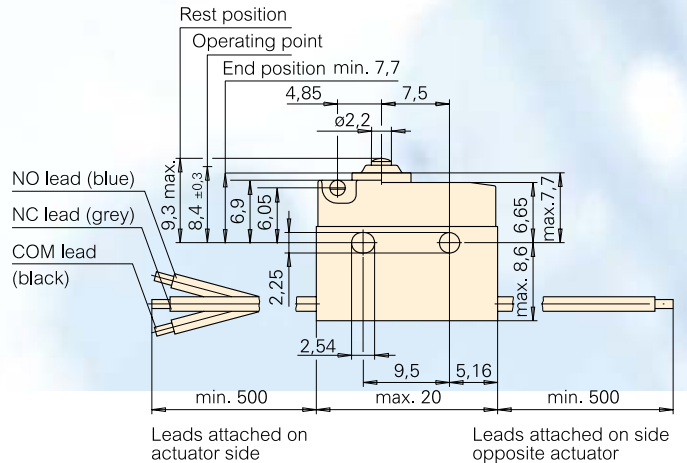

Special model with tall pedestral available on request

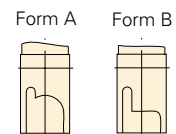

Electrical rating and operating life (2)

Electrical rating according to EN 61058		UL 1054	Electrical life at rated load		Mechanical life	Max. operating force (cN)	Code
			acc. to EN (operations)	acc. to UL			
6 A 250 V AC	5 A 125–250 V AC		10.000	6.000	2 x 10 ⁶	200	1
10 (1,5) A, 250 V AC	10,1 A, 125–250 V AC 1/4 HP, 125 V AC		10.000	6.000	1 x 10 ⁶	340	2
0,1 A, 250 V AC	0,1 A 125–250 V AC		50.000	100.000	2 x 10 ⁶	200	3
3 A, 250 V AC	3 A, 125–250 V AC		50.000	6.000	2 x 10 ⁶	200	4*

* DC4 only possible as line version with line diameter 0.5 mm²

Switching parameters

Option	Type	Max. operating force (cN)	Max. pretravel (mm)	Min. overtravel (mm)	Max. movement differential (mm)	Max. rest position (mm)	Operating point (mm)	Length of aux. actuator	Code
Without auxiliary actuator	DC1, 3, 4	200	1,0	0,6	0,1	9,3	8,4 ± 0,3	–	AA
	DC2	340	1,0	0,6	0,1	9,3	8,4 ± 0,3		

Contact configuration (3)

Contact configuration	Code
Ambient temperature 40T85	
S.P.S.T.-N.O.	E
S.P.S.T.-N.C.	F
S.P.D.T.	G
Ambient temperature 40T120 (with leads 40T105)	
S.P.S.T.-N.O.	A
S.P.S.T.-N.C.	B
S.P.D.T.	C



Contact rating at direct voltage

Switching voltage	Switched current resistive load		Induktive load (L/R = 3 ms)	
	DC1	DC2	DC1	DC2
12 V	6 A	10 A	6 A	10 A
24 V	3 A	5 A	2 A	4 A
60 V	1 A	1 A	0,5 A	0,5 A
110 V	0,5 A	0,5 A	0,2 A	0,2 A
220 V	0,25 A	0,25 A	0,1 A	0,1 A

Terminals (4)

Type of terminal with standard pedestral	Code
Solder terminal, short*	A1
PCB terminal 1,3 x 0,5 straight*	H1
PCB terminal 0,6 x 0,5 straight*	K1
PCB terminal 0,6 x 0,5 right-hand side**	K8
PCB terminal 0,6 x 0,5 left-hand side**	K9
PCB terminal 0,6 x 0,5 right-hand side***	K6
PCB terminal 0,6 x 0,5 left-hand side***	K7
Q.C. terminal 2,8 x 0,5 mm straight*	L1
Leads 0,5 mm ² attached to underside	B5
Leads 0,5 mm ² on actuator side	B3
Leads 0,5 mm ² on opposite side from actuator	B4
Leads 0,75 mm ² attached to underside	C5
Leads 0,75 mm ² on actuator side	C3
Leads 0,75 mm ² on opposite side from actuator	C4
Without Leads (Form B) on actuator side/ opposite*	N3/N4
Without Leads (Form A) on actuator side/ opposite*	P3/P4
Without Leads (no cut-out) with solder terminal*	Q1

* max. 30° twisted **with location pins ***w/o location pins

Auxiliary actuator options (5)

Model	Length	Code
Without auxiliary actuator	–	AA
Straight	4,8	LB
	8	LC
	42	LD
Roller	2,5	RB
	4,7	RC
	39,7	RD
Simulated roller	2,5	SB
	4,7	SC
	39,7	SD
Plastic straight	7	WB
	14	WC
Plastic roller	5,2	ZB
Plastic simulated roller	5,6	VB

X-ON Electronics

Largest Supplier of Electrical and Electronic Components

Click to view similar products for [Basic / Snap Action Switches](#) category:

Click to view products by [ZF Cherry](#) manufacturer:

Other Similar products are found below :

[83228001](#) [01.098.1358.1](#) [602EN1-6B](#) [602EN532](#) [602EN535-RB](#) [602HE5-RB1](#) [604HE162](#) [604HE223-6B](#) [624HE17-RB](#) [6HM89](#) [6PA78-JM](#)
[6SE1](#) [6SX1-H58](#) [70500840](#) [MBD5B1](#) [MBH2731](#) [73-316-0012](#) [79211759](#) [79211923](#) [79218589](#) [7AS12](#) [ML-1155](#) [ML-1376](#) [831010C3.0](#)
[831060C3.TL](#) [831090C2.EL](#) [83131904](#) [84212012](#) [8AS239](#) [8HM73-3](#) [903VB1-PG](#) [914CE1-6G](#) [PL-100](#) [11SM1077-H4](#) [11SM1077-H58](#)
[11SM1-TN107](#) [11SM405](#) [11SM703-T](#) [11SM8423-H2](#) [11SX37-T](#) [11SX48-H58](#) [11SX55-H58](#) [11SM2442-T](#) [11SM76-T](#) [11SM77-H58](#)
[11SM77-T](#) [11SM863-T](#) [11SM866](#) [11SX47-H58](#) [A7CN-1M-1-LEFT](#)